

# CAPACITOR CATALOG 丰明电容 2015

为成功的企业配套 ◦ 为企业的成功配套  
To support a successful enterprise  
To support the success of an enterprise



**广东丰明电子科技有限公司**  
GUANGDONG FENGMING ELECTRONIC TECH. CO., LTD.

广东省佛山市顺德区北滘镇工业园环镇东路1号  
Beijiao Industrial Garden, ShunDe, FoShan, GuangDong, China

☎ 0757-26331633  
☎ 0757-26331688  
✉ Info@bm-cap.com  
🌐 <http://www.bm-cap.com>



扫一扫二维码，简便  
获取更多产品资讯。





## 公司简介(一) | INTRODUCTION I

广东丰明电子科技有限公司，始创于2000年，占地2.5万平方米，拥有3万平米高标准厂房，日产186万只金属化薄膜电容器。

丰明电子分设三大研究中心及九大产品事业部，从事多类薄膜电容器及金属化薄膜的应用研究、开发、设计、制造与销售。

As the leading MPP capacitor manufacturer in China, BM has been specialized in the development, manufacturing and sales of capacitor for decades.

BM capacitors are widely used in appliance, lighting, industrial equipment, solar, inverter, UPS etc. With stable quality and superior service, BM has been the long-term partner of world-wide customers.

BM has acquired certificates of ISO, CQC, VDE, UL, KC etc which could fulfill customers' versatile requirements.

For more info, please get on [www.bm-cap.com](http://www.bm-cap.com)

BM always assures you the best service.

更多产品资讯，敬请登陆：[www.bm-cap.com](http://www.bm-cap.com)

# 公司简介(二) | INTRODUCTION II

丰明电子以“为成功的企业配套，为企业的成功配套”为经营理念，以“专业化为主、多元化发展”的市场细分方针，陆续和格力、海尔、美的、格兰仕、九阳、苏泊尔、艾美特、开利、亨特、三星、LG等国内外知名品牌建立了良好而持久的合作关系。

“To support a successful enterprise, to support the success of an enterprise.” Fengming hold this operation principle, and stick on specialization and diversification, we established long and stable cooperation with many famous enterprise at home and abroad, such as Gree, Haier, Midea, Galanz, Joyoung, Supor, Airmate, Carrier, Hunter, Samsung, LG.



三大研究中心 Three Research Centers



九大产品事业部 Nine Departments



未来要成立 Future Development



# 公司简介(三) | INTRODUCTION III



广东省著名商标  
Famous mark in  
Guangdong Province



广东省名牌产品  
Famous-brand products  
in Guangdong Province



高新技术企业  
High-tech Enterprises



顺德区质量信用A级企业  
Quality Credit A Class Enterprises  
in Shunde Area



广东省著名商标  
Famous mark in Guangdong Province



广东省名牌产品  
Famous-brand products  
in Guangdong Province



广东省民营科技企业  
Private Science and Technology  
Enterprises in Guangdong Province

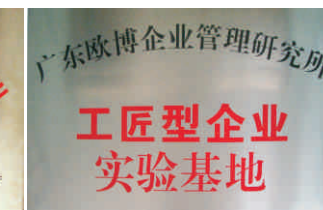

广东欧博企业管理研究所  
工匠型企业实验基地  
Craftsman Enterprises Laboratory  
Base for OuBo Enterprises  
management Research  
Institute in Guangdong Province



顺德区龙腾企业  
LQ Enterprises in Shunde Area

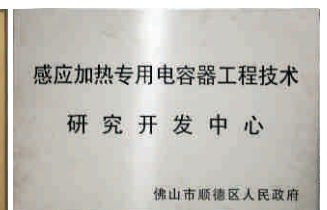

顺德区感应加热专用电容器  
工程技术研究开发中心  
Induction Heating Capacitor  
Engineering R&D Center  
in Shunde Area



产品开发中心 R&D Center



工艺研究中心 Technology Research Center



实验检测中心 Testing Center



真空镀膜

## 2007-2011年的专利清单 Patent List :

### 实用新型专利 Utility model patent

申请人	申请号	授权日期	名称
1. 广东丰明电子科技有限公司	200720050835.3	2008-03-12	一种新型电容器绝缘塑料外壳
2. 广东丰明电子科技有限公司	200920056248.4	2010-02-17	一种薄膜分切机的收卷轴
3. 广东丰明电子科技有限公司	200920056247.X	2010-02-17	一种电容器芯子包裹器
4. 广东丰明电子科技有限公司	200920056249.9	2010-02-17	一种电容器外壳
5. 广东丰明电子科技有限公司	200920058449.8	2010-05-26	一种电容器的自动包胶机
6. 广东丰明电子科技有限公司	200920058450.0	2010-05-05	一种安全型金属化薄膜电容器
7. 广东丰明电子科技有限公司	201020119520.1	2010-02-09	一种安规电容器的外壳
8. 广东丰明电子科技有限公司	201020505949.4	2011-04-27	一种新型电容器外壳
9. 广东丰明电子科技有限公司	201020538715.X	2011-03-16	一种用于直流滤波电容器的外壳
10. 广东丰明电子科技有限公司	201020572625.2	2011-04-27	一种用于外接引线的电容器
11. 广东丰明电子科技有限公司	201020613387.5	2011-06-15	一种用于感应加热的模块式电容器
12. 广东丰明电子科技有限公司	201020627485.4	2011-06-29	一种具有安全防爆的电容器
13. 广东丰明电子科技有限公司	201120109690.6	2011-10-05	一种新型微波炉用干式结构电容器
14. 广东丰明电子科技有限公司	201120136554.6	2011-12-14	一种用于直流滤波的中心散热式电容器
15. 广东丰明电子科技有限公司	201120562909.8	2012-08-15	用于感应加热的外置型电容器

### 外观专利 Appearance patent

申请人	申请号	授权日期	名称
1. 广东丰明电子科技有限公司	201030569113.6	2011-02-09	电容器 (CBB61)



高新技术企业  
High-tech Enterprises

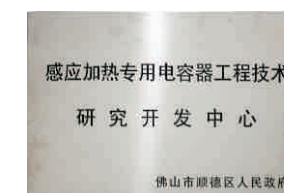

顺德区感应加热专用电容器  
工程技术研究开发中心  
Induction Heating Capacitor Engineering  
R&D Center in Shunde Area

# 质量保证 | Quality Assurance

丰明电子全面执行ISO9001及ISO14001国际质量与环境体系标准。

Complied with ISO9001 and ISO14001 International quality and environment standard.

ISO9001及ISO14001国际质量与环境体系标准



ROHS



已先后获得中国CQC, 美国cULus, 德国VDE、TUV, 欧洲ENEC以及CB认证。  
Has got CQC, cULus, VDE, TUV, ENEC, CB certificate.



顺德区质量信用A级企业  
Quality Credit A Class Enterprises  
in Shunde Area



广东省名牌产品  
Famous-brand products  
in Guangdong Province

X射线光谱仪  
X ray spectrometer



微电脑抗压强度试验机  
The compressive strength of the microcomputer tester



恒温胶带保持力试验机  
Tape to maintain constant temperature test equipment



电容器耐久性试验装置  
Capacitor endurance test device



漏电起痕试验仪  
Tracking test instrument



高低温交变试验箱  
Alternating high and low temperature test chamber



更多产品资讯, 敬请登陆: [www.bm-cap.com](http://www.bm-cap.com)

# 市场地位 Market Position



广东省著名商标



广东省名牌产品

三大主导产品市场份额  
Three Leading Products  
Market Share

40% 空调风机用电容器

70% 电磁炉专用电容器

35% 风扇用电容器

## 部分客户 PART OF THE CUSTOMER



# 产品目录 | Product catalog

	<b>交流电容器事业部</b> AC CAPACITOR DEPARTMENT	<b>13</b>
CBB61	双线系列 Two wires series	14
CBB61	焊片系列 Soldering lug series	15
CBB61	端子系列 Terminal series	16
CBB61	调速系列 Speed regulation series	17
	<b>空调电容器事业部</b> AIR CONDITIONER CAPACITOR DEPARTMENT	<b>19</b>
CBB61	插片系列 Insert series	20
CBB61	插针系列 Pin series	21
CBB61	静音系列 Noise-resistant series	22
CBB61-P2	安全防爆系列 Safety explosion protection series	23
	<b>60/65电容器事业部</b> 6065 CAPACITOR DEPARTMENT	<b>25</b>
CBB60 Series		26
CBB65 Series		27
	灯具电容器 Light capacitors series	28
	<b>针式电容器事业部</b> INDUCTION HEATING CAPACITOR DEPARTMENT	<b>29</b>
MKP	电磁炉电容器 跨线抗干扰系列 Induction cooker jumper wire interference series	30
MKP	电磁炉电容器 平滑滤波系列 Induction cooker smoothing filter series	31
MKPH	电磁炉电容器 高压谐振系列 Induction cooker high voltage resonance series	32
MKP/MKPH	电磁炉电容器 小型化系列 Small type induction cooker capacitor series	33
MKP	电磁炉电容器 安全型跨线系列 Jumper wire safety induction cooker series	34
	<b>安规电容器事业部</b> INTERFERENCE SUPPRESSION CAPACITOR DEPARTMENT	<b>35</b>
MKP-X2	抑制电源电磁干扰用安规电容器 Safety approvals capacitors for Interference suppression	36
MKP-X2	阻容降压专用交流安规电容器 Safety approvals capacitors for capacitive divider	37
CBB23	阻容降压用盒装化金属化聚丙烯薄膜电容器 Boxed capacitors for capacitive divider	38

	<b>包封电容器事业部</b> POWDER COATING CAPACITOR DEPARTMENT	<b>39</b>
CBB21	金属化聚丙烯薄膜电容器 Metalized polypropylene film capacitor	40
CBB22	金属化聚丙烯薄膜电容器 Metalized polypropylene film capacitor	41
CBB81	金属化聚丙烯膜、箔电容器 Metalized polypropylene film and foil capacitor	42
CBB20	金属化聚丙烯薄膜扁形轴向电容器 Metalized polypropylene axial flat type capacitor	43
CBB20	金属化聚丙烯薄膜圆形轴向电容器 Metalized polypropylene axial round type capacitor	44
	<b>工业电容器事业部</b> INDUSTRIAL CAPACITOR DEPARTMENT	<b>45</b>
MKP-L	DC-LINK电容器 圆形铝外壳式系列 DC-LINK capacitor circle aluminum case series	46
MKP-L	DC-LINK电容器 金属方壳式系列 DC-LINK capacitor metal square shell series	47
MKP-L	滤波电容器 塑壳式系列 Filter capacitor plastic box series	48
MKP-L	滤波电容器 轴向包胶式系列 Filter capacitor pet adhesive tape series	49
MKP-L	滤波电容器 铝壳模块式系列 Filter capacitor aluminum module series	50
MKP-L	滤波电容器 模块式系列 Filter capacitor module series tape series	51
MKP-L	滤波电容器 焊机系列 Filter capacitor welding machine series	52
MKPH-S	缓冲吸收电容器 塑壳式系列 Snubber capacitor plastic box series	53
MKPH-S	缓冲吸收电容器 轴向包胶式系列 Snubber capacitor pet adhesive tape series	54
MKPH-S	缓冲吸收电容器 高压GTO系列 Snubber capacitor GTO dedicated series	55
MKPH-R	谐振电容器 塑壳式系列 Resonance capacitor plastic box series	56
MKPH-R	谐振电容器 包胶系列 Resonance capacitor pet adhesive tape series	57
MKPH-R	谐振电容器 铝壳模块式系列 Resonance capacitor aluminum module series	58
MKPH-R	谐振电容器 模块式系列 Resonance capacitor module series	59
MKP-C	耦合隔直电容器 轴向包胶式系列 Coupling capacitor pet adhesive tape series	60
MKP-F	交流滤波电容器 塑壳系列 AD Filter capacitor plastic box series	61
MKP-F	交流滤波电容器 轴向包胶式系列 AD Filter capacitor pet adhesive tape series	62
	<b>微波炉电容器事业部</b> MICROWAVE CAPACITOR DEPARTMENT	<b>63</b>
CBB85	微波炉倍压整流电路用电容器 Capacitors for microwave ovens (standard class series)	63
	<b>真空镀膜事业部</b> VACUUM COATING DEPARTMENT	<b>64</b>
	<b>深圳市金元电子技术有限公司</b> 专业生产螺柱型铝电解电容器, 焊针型铝电解电容器	<b>67</b>

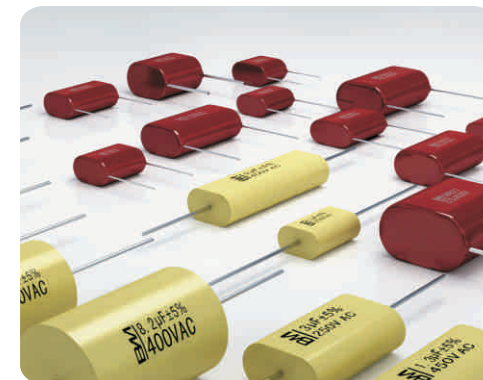
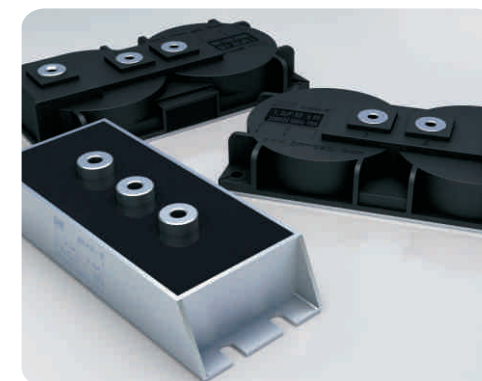
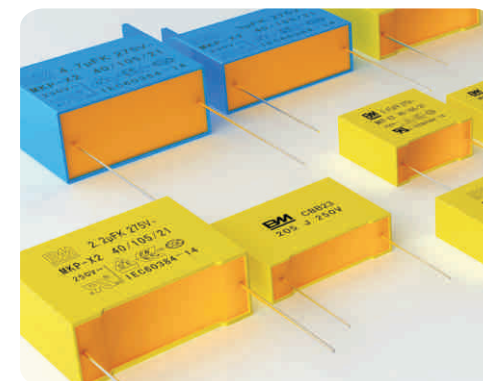

主要生产交流电动机启动、运行及调速系列电容。在台扇、落地扇、楼底扇、吊扇、排气扇、抽油烟机、热水器、除湿机、麻将机、碎纸机等电器中广泛应用。

Mainly produce AC Motor Capacitor which is used for starting, running and adjust speed. It's widely used for Table Fan, Floor Fan, Ceiling Fan, Wall Fan, Luxury Ceiling Fan, Exhaust Fan, Extractor hood, Heater, Dehumidifier, Mahjong machine, Smash Paper Machine, etc.



自动调速电容包胶机  
Automatic speed regulating capacitor wrapping machine



自动焊线机  
Automatic welding machine



采用电工级聚丙烯薄膜作为介质、锌铝金属化层作为电极,优质工程塑料外壳,阻燃环氧树脂灌封, PVC电子线引出, 通用性强, 装配灵活。

The products are made of electrical class polypropylene film, zinc-aluminum metalized electrode, High-quality engineering plastic box, and enveloped with epoxy resin, welded with PVC electric wire. They have the characteristics of high universality and flexible assembly.



认证标志 Safety approvals	CQC、UL、CUL、VDE、TUV
执行标准 Implemented standard	GB/T3667.1、UL810、EN60252-1
环境温度 Environment temperature	-40°C~+105°C
额定电压 Rated voltage	110VAC~600VAC (50/60Hz)
容量范围 Capacitance range	0.1μF~80μF
容量偏差 Capacitance tolerance	±5%(J)、±10%(K)
损耗角正切 Tangent of loss angle(20°C)	≤0.002 (100Hz)
试验电压 Testing voltage	
极间 between terminals	2*U <sub>N</sub> (VAC) / 60s (CQC、VDE、TUV) 1.5*U <sub>N</sub> (VAC) / 60s (UL)
极壳 between terminals and case	2*U <sub>N</sub> +1000(VAC) / 60s(≥2000VAC)
防护等级 Class of safety protection	CBB61:P0 class; CBB61-P2:P2 class
故障电流 Fault current	CBB61-P2: 10,000AFC (UL810)

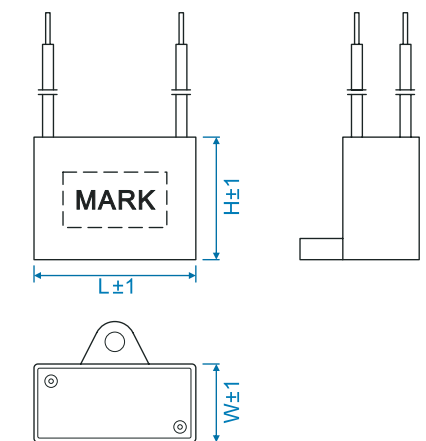

常用规格 Dimension Unit: mm

Rated cap.	250VAC	300VAC	350VAC	400VAC	450VAC	500VAC	550-600VAC
	L*W*H	L*W*H	L*W*H	L*W*H	L*W*H	L*W*H	L*W*H
0.40μF	—	—	—	—	31*9*17	31*9*19	32*11*21
0.50μF	—	—	—	—	31*9*17	31*9*19	32*11*21
0.56μF	—	—	—	31*9*17	31*9*19	32*10*19.5	32*11*21
0.60μF	—	—	—	31*9*17	32*10*19.5	32*11*21	36*11*22
0.80μF	—	—	31*9*19	32*10*19.5	32*11*21	36*10.5*20	36*12*22
1.0μF	—	31*9*7	32*10*19.5	32*11*21	36*10.5*20	36*11*22	36*12*22
1.2μF	31*9*17	32*10*19.5	32*11*21	36*11*22	36*12*22	36*12.5*24	36*15*25
1.5μF	31*9*19	32*11*21	36*11*22	36*12*22	36*12.5*24	36*15*25	36*16*28
1.8μF	31*10*19	36*10.5*20	36*12*22	36*12.5*24	36*15*25	36*16*28	38*18.5*29
2.0μF	31*10*19	36*11*22	36*12.5*24	37*13.5*24	36*15*25	38*17*28	38*19.5*31
2.2μF	32*11*21	36*11*22	36*12.5*24	37*13.5*24	36*16*28	38*18.5*29	38*19.5*31
2.5μF	32*11*21	36*12*22	36*15*25	36*16*28	38*17*28	38*19.5*31	48*19*28
3.0μF	36*12*22	36*12.5*24	36*16*28	38*17*28	38*19.5*31	47*17*31	47*20*31
3.5μF	36*12*22	36*15*25	38*17*28	38*18.5*29	47*17*28	47*20*31	47*23*32
4.0μF	36*12.5*24	38*14.5*27	38*18.5*29	38*19.5*31	48*19*28	47*20*33	47*23*35
4.5μF	36*12.5*24	36*16*28	38*19.5*31	48*17*28	47*20*31	47*23*35	47*24*37
5.0μF	37*13.5*24	38*17*28	48*17*28	47*17*31	47*20*31	47*23*35	47*27*37
6.0μF	38*16*27	38*18.5*29	38*19.5*31	47*20*31	47*23*35	47*27*37	58*26*38
6.5μF	38*16*27	38*18.5*29	47*19*31	48*22*32	47*23*35	48*28*40	58*26*38
8.0μF	48*17*28	48*19*28	47*23*32	47*23*35	47*27*37	58*23*38	58*30*40
10μF	47*20*31	47*20*33	47*24*37	48*28*40	58*26*38	58*30*40	70*38*52
12μF	48*19*28	47*23*35	48*28*40	58*26*38	58*28*40	58*32*43	70*38*52

典型线路图  
Typical circuit

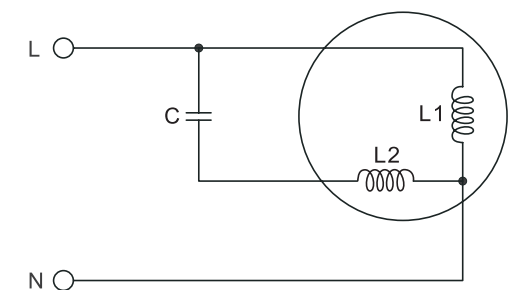

C: 启动运转电容  
Running capacitor



**交流电容器**  
AC CAPACITOR

采用电工级聚丙烯薄膜作为介质、锌铝金属化层作为电极，优质工程塑料外壳，阻燃环氧树脂灌封，焊片式引出。产品体积小，性价比高。

The products are made of electrical class polypropylene film, zinc-aluminum metalized electrode, High-quality engineering plastic box, and enveloped with epoxy resin, lead by soldering lug. They are of small in size and high cost performance.

认证标志 Safety approvals	CQC, UL, CUL, VDE, TUV
执行标准 Implemented standard	GB/T3667.1, UL810, EN60252-1
环境温度 Environment temperature	-40°C~+105°C
额定电压 Rated voltage	110VAC~600VAC (50/60Hz)
容量范围 Capacitance range	0.1µF~80µF
容量偏差 Capacitance tolerance	±5%(J)、±10%(K)
损耗角正切 Tangent of loss angle(20°C)	≤0.002 (100Hz)
试验电压 Testing voltage	
极间 between terminals	2*U <sub>N</sub> (VAC) / 60s ( CQC, VDE, TUV ) 1.5*U <sub>N</sub> (VAC) / 60s ( UL )
极壳 between terminals and case	2*U <sub>N</sub> +1000(VAC) / 60s(≥2000VAC)
防护等级 Class of safety protection	CBB61:P0 class ; CBB61-P2:P2 class
故障电流 Fault current	CBB61-P2 :10,000AFC ( UL810 )

常用规格 Dimension									Unit : mm	
Rated cap.	250VAC	300VAC	350VAC	400VAC	450VAC	500VAC	550-600 VAC			
	L*W*H	L*W*H	L*W*H	L*W*H	L*W*H	L*W*H	L*W*H	L*W*H	L*W*H	L*W*H
0.40µF	—	—	—	—	31*9*17	31*9*19	32*11*21			
0.50µF	—	—	—	—	31*9*17	31*9*19	32*11*21			
0.56µF	—	—	—	31*9*17	31*9*19	32*10*19.5	32*11*21			
0.60µF	—	—	—	31*9*17	32*10*19.5	32*11*21	36*11*22			
0.80µF	—	—	31*9*19	32*10*19.5	32*11*21	36*10.5*20	36*12*22			
1.0µF	—	31*9*7	32*10*19.5	32*11*21	36*10.5*20	36*11*22	36*12*22			
1.2µF	31*9*17	32*10*19.5	32*11*21	36*11*22	36*12*22	36*12.5*24	36*15*25			
1.5µF	31*9*19	32*11*21	36*11*22	36*12*22	36*12.5*24	36*15*25	36*16*28			
1.8µF	31*10*19	36*10.5*20	36*12*22	36*12.5*24	36*15*25	36*16*28	38*18.5*29			
2.0µF	31*10*19	36*11*22	36*12.5*24	37*13.5*24	36*15*25	38*17*28	38*19.5*31			
2.2µF	32*11*21	36*11*22	36*12.5*24	37*13.5*24	36*16*28	38*18.5*29	38*19.5*31			
2.5µF	32*11*21	36*12*22	36*15*25	36*16*28	38*17*28	38*19.5*31	48*19*28			
3.0µF	36*12*22	36*12.5*24	36*16*28	38*17*28	38*19.5*31	47*17*31	47*20*31			
3.5µF	36*12*22	36*15*25	38*17*28	38*18.5*29	47*17*28	47*20*31	47*23*32			
4.0µF	36*12.5*24	38*14.5*27	38*18.5*29	38*19.5*31	48*19*28	47*20*33	47*23*35			
4.5µF	36*12.5*24	36*16*28	38*19.5*31	48*17*28	47*20*31	47*23*35	47*24*37			
5.0µF	37*13.5*24	38*17*28	48*17*28	47*17*31	47*20*31	47*23*35	47*27*37			
6.0µF	38*16*27	38*18.5*29	38*19.5*31	47*20*31	47*23*35	47*27*37	58*26*38			
6.5µF	38*16*27	38*18.5*29	47*19*31	48*22*32	47*23*35	48*28*40	58*26*38			
8.0µF	48*17*28	48*19*28	47*23*32	47*23*35	47*27*37	58*23*38	58*30*40			
10µF	47*20*31	47*20*33	47*24*37	48*28*40	58*26*38	58*30*40	70*38*52			
12µF	48*19*28	47*23*35	48*28*40	58*26*38	58*28*40	58*32*43	70*38*52			

焊片系列 | CBB61  
Soldering Lug Series

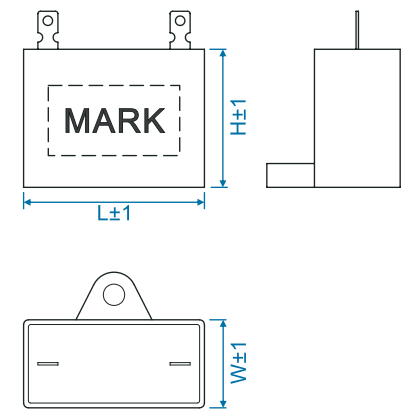

典型线路图  
Typical circuit

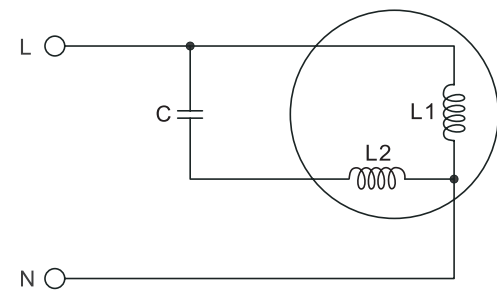

C:启动运转电容  
Running capacitor

**交流电容器**  
AC CAPACITOR

采用电工级聚丙烯薄膜作为介质、锌铝金属化层作为电极,优质工程塑料外壳,阻燃环氧树脂灌封,标准型快接端子引出,可实现快速连接。

The products are made of electrical class polypropylene film, zinc-aluminum metalized electrode, High-quality engineering plastic box, and enveloped with epoxy resin, led by standard quick-connect terminals to connect fast.

认证标志 Safety approvals	CQC, UL, CUL, VDE, TUV
执行标准 Implemented standard	GB/T3667.1, UL810, EN60252-1
环境温度 Environment temperature	-40°C~+105°C
额定电压 Rated voltage	110VAC~600VAC (50/60Hz)
容量范围 Capacitance range	0.1µF~80µF
容量偏差 Capacitance tolerance	±5%(J)、±10%(K)
损耗角正切 Tangent of loss angle(20°C)	≤0.002 (100Hz)
试验电压 Testing voltage	
极间 between terminals	2*U <sub>N</sub> (VAC) / 60s ( CQC, VDE, TUV ) 1.5*U <sub>N</sub> (VAC) / 60s ( UL )
极壳 between terminals and case	2*U <sub>N</sub> +1000(VAC) / 60s(≥2000VAC)
防护等级 Class of safety protection	CBB61:P0 class ; CBB61-P2:P2 class
故障电流 Fault current	CBB61-P2 :10,000AFC ( UL810 )

常用规格 Dimension									Unit : mm	
Rated cap.	250VAC	300VAC	350VAC	400VAC	450VAC	500VAC	550-600 VAC			
	L*W*H	L*W*H	L*W*H	L*W*H	L*W*H	L*W*H	L*W*H	L*W*H	L*W*H	L*W*H
0.40µF	—	—	—	—	31*9*17	31*9*19	32*11*21			
0.50µF	—	—	—	—	31*9*17	31*9*19	32*11*21			
0.56µF	—	—	—	31*9*17	31*9*19	32*10*19.5	32*11*21			
0.60µF	—	—	—	31*9*17	32*10*19.5	32*11*21	36*11*22			
0.80µF	—	—	31*9*19	32*10*19.5	32*11*21	36*10.5*20	36*12*22			
1.0µF	—	31*9*7	32*10*19.5	32*11*21	36*10.5*20	36*11*22	36*12*22			
1.2µF	31*9*17	32*10*19.5	32*11*21	36*11*22	36*12*22	36*12.5*24	36*15*25			
1.5µF	31*9*19	32*11*21	36*11*22	36*12*22	36*12.5*24	36*15*25	36*16*28			
1.8µF	31*10*19	36*10.5*20	36*12*22	36*12.5*24	36*15*25	36*16*28	38*18.5*29			
2.0µF	31*10*19	36*11*22	36*12.5*24	37*13.5*24	36*15*25	38*17*28	38*19.5*31			
2.2µF	32*11*21	36*11*22	36*12.5*24	37*13.5*24	36*16*28	38*18.5*29	38*19.5*31			
2.5µF	32*11*21	36*12*22	36*15*25	36*16*28	38*17*28	38*19.5*31	48*19*28			
3.0µF	36*12*22	36*12.5*24	36*16*28	38*17*28	38*19.5*31	47*17*31	47*20*31			
3.5µF	36*12*22	36*15*25	38*17*28	38*18.5*29	47*17*28	47*20*31	47*23*32			
4.0µF	36*12.5*24	38*14.5*27	38*18.5*29	38*19.5*31	48*19*28	47*20*33	47*23*35			
4.5µF	36*12.5*24	36*16*28	38*19.5*31	48*17*28	47*20*31	47*23*35	47*24*37			
5.0µF	37*13.5*24	38*17*28	48*17*28	47*17*31	47*20*31	47*23*35	47*27*37			
6.0µF	38*16*27	38*18.5*29	38*19.5*31	47*20*31	47*23*35	47*27*37	58*26*38			
6.5µF	38*16*27	38*18.5*29	47*19*31	48*22*32	47*23*35	48*28*40	58*26*38			
8.0µF	48*17*28	48*19*28	47*23*32	47*23*35	47*27*37	58*23*38	58*30*40			
10µF	47*20*31	47*20*33	47*24*37	48*28*40	58*26*38	58*30*40	70*38*52			
12µF	48*19*28	47*23*35	48*28*40	58*26*38	58*28*40	58*32*43	70*38*52			

端子系列 | CBB61  
Terminal Series

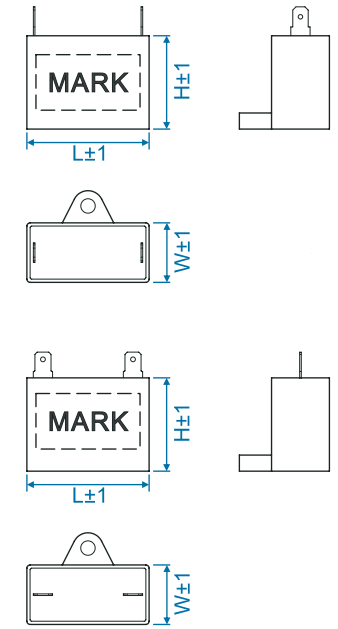

典型线路图  
Typical circuit

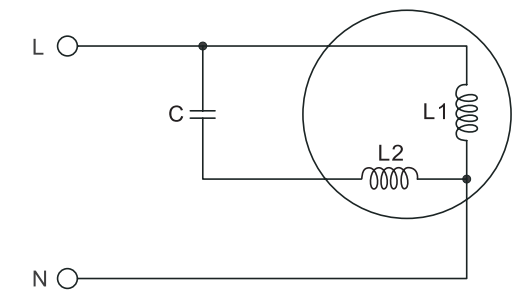

C:启动运转电容  
Running capacitor

# 交流风扇电容器 AC FAN CAPACITOR

## 调速系列 Speed Regulation Series | CBB61

专为风扇调速器而设计，多芯组合式结构，可实现 2~4 芯模块式封装。多种个性化安装结构可选，使用方便，采用特殊制造工艺，电性能稳定。可解决传统电感式调速器成本高、噪音大的缺点。  
Specially design for Fan converter, several cores center structure, 2~4 cores center can be filled into a capacitor case. And with many different installation structure to choose, they use conveniently. Adopt special produce craft, stable electric performance. They can solve the disadvantage of high cost & large noise of traditional inductance converter.

认证标志 Safety approvals	CQC, UL, CUL, VDE, TUV
执行标准 Implemented standard	GB/T3667.1, UL810, EN60252-1
环境温度 Environment temperature	-40°C~+105°C
额定电压 Rated voltage	110VAC~600VAC (50/60Hz)
容量范围 Capacitance range	0.1μF~80μF
容量偏差 Capacitance tolerance	±5%(J), ±10%(K)
损耗角正切 Tangent of loss angle(20°C)	≤0.002 (100Hz)
试验电压 Testing voltage	
极间 between terminals	2*U <sub>N</sub> (VAC) / 60s ( CQC, VDE, TUV ) 1.5*U <sub>N</sub> (VAC) / 60s ( UL )
极壳 between terminals and case	2*U <sub>N</sub> +1000(VAC) / 60s(≥2000VAC)
防护等级 Class of safety protection	CBB61:P0 class ; CBB61-P2:P2 class
故障电流 Fault current	CBB61-P2 :10,000AFC ( UL810 )

### 常用规格 Dimension Unit : mm

Specification	250VAC		300VAC	
	L*W*H	L*W*H	L*W*H	L*W*H
1+2μF	33*15*25	38*15*25	300V3+250V4+4	50*20*30
1.2+1.8μF	33*15*25	38*15*25	300V3. 5+250V4+5	50*23*29
1.5+2.5μF	38*15*25	38*16*27	300V3. 5+250V5+6	50*23*29
1.75+3.5μF	38*16*27	38*18. 5*29	300V3. 75+250V4+5	50*23*29
2+2μF	38*15*25	38*18. 5*25	300V3. 75+250V5+5	50*23*29
2+2.2μF	38*15*25	38*18. 5*25	300V3. 5+250V3. 5+4	50*20*30
2+3μF	38*15*25	38*18. 5*25	300V4+250V4+2. 5	50*20*30
2+3.5μF	38*16*25	38*18. 5*29	300V4+250V3. 5+4. 5	50*23*29
2+4μF	38*18. 5*25	38*21*28	300V4+250V4+5	50*23*29
2.5+2.5μF	38*15*25	38*25*20	300V4+250V5+5	50*23*29
2.5+5μF	39*19. 5*27	38*24*28	300V4+250V5+6	50*23*32. 5
3+0.6μF	38*18. 5*25	38*18. 5*25	300V4+250V6+5	50*23*32. 5
3+1.5μF	38*15*25	38*18. 5*25	300V4+250V6+6	50*23*32. 5
3+5.5μF	38*21*28	38*25*29	300V4. 5+250V4+5	50*23*32. 5
4+2μF	38*15*25	38*21*28	300V4. 5+250V5+5	50*23*32. 5
4+4.5μF	38*18. 5*29	38*25*29	300V4. 5+250V4+8	50*23*32. 5
4.5+2μF	38*15*25	38*21*28	300V4. 5+250V6+5	50*23*32. 5
5+5μF	38*23*26	50*20*30	300V4. 5+250V6+6	50*23*32. 5
1.9+ (0.5μF x 3)	38*30*21	38*30*21	300V5+250V5+5	50*24*30
1.9+ (0.7μF x 3)	38*30*21	38*32*23	550V1. 2+450V1. 5+2	50*23*29
2.2+ (1.2μF x 3)	38*30*21	39*32*23	550V1. 5+450V1. 5+2	50*23*34
2.4+ (0.9μF x 3)	38*30*21	38*32*23	550V1. 5+450V2+2. 5	50*24*37
2.5+ (1.2μF x 3)	38*30*21	38*32*23	550V2+450V2+4	47*35*35
2.8+ (1μF x 3)	38*30*21	38*32*23	550V2. 2+450V3+3. 5	58*26*38
3+ (1μF x 3)	38*30*21	38*32*23	550V2. 5+450V3+3	58*26*38
3+ (1.2μF x 3)	38*30*21	38*32*23		
3.2+ (1μF x 3)	38*30*21	38*32*23		
3.2+ (1.2μF x 3)	38*30*21	38*32*23		
3.5+ (1.2μF x 3)	38*30*21	38*32*23		
3.5+ (1.5μF x 3)	38*32*23	38*32*23		

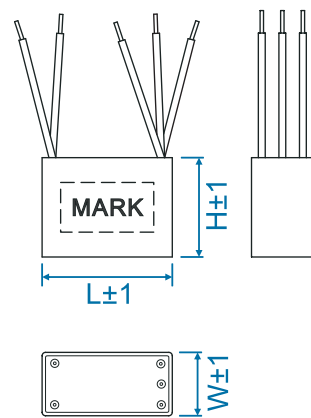

典型线路图  
Typical circuit

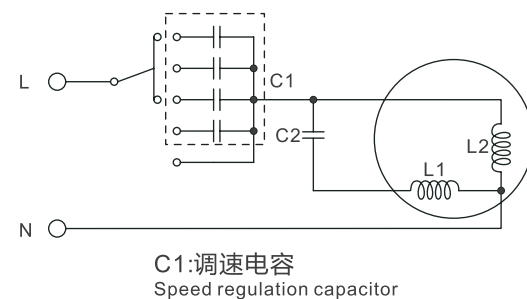

常用内部接线图  
Common Internal Wiring

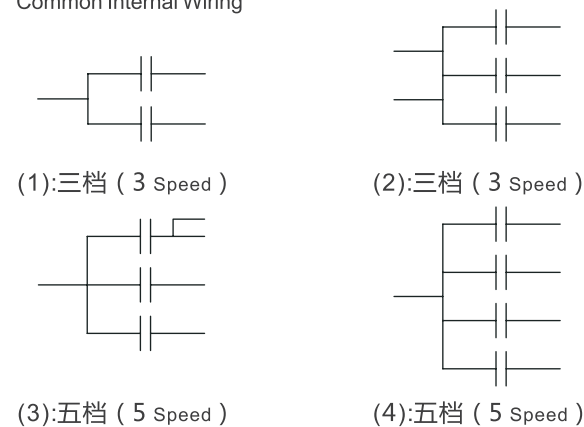

## 交流电容器常用安装方式 NORMAL INSTALLATION WAYS OF AC CAPACITOR

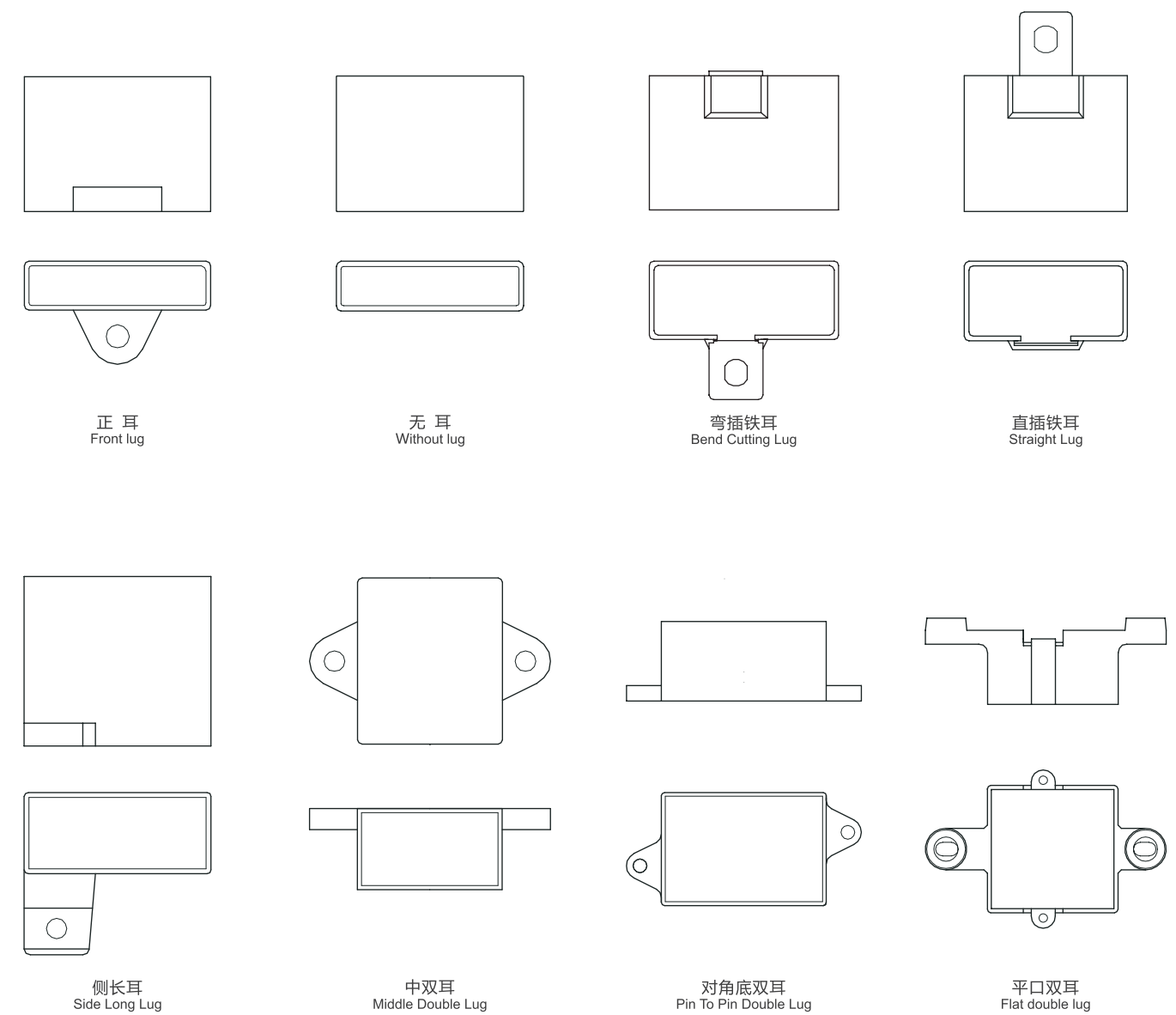

交流电容器其它引出及安装方式，可按用户要求设计。  
For special specifications and terminals, we can design as to customer's requirement.

### 交流电容器塑胶耳安装说明

塑胶耳因其本身材质原因，如安装方式不当易出现断耳的现象，用户在生产安装时注意风批、螺钉、孔位保持在直线状态，风批对胶耳的冲击力以螺钉头陷入孔位不超过0.3mm为宜。

### Plastic lug installation instruction

As to the character of the plastic lug, the lug can be disconnected by improper installation ways. The user should be careful and keep the URYU, screw and hole in the straight line. The URYU impulse to the lug should be judged by the screw head depth in the hole, less than 0.3mm is ok.

# 空调电容器事业部

## AIR CONDITIONER CAPACITOR DEPARTMENT

主要生产空调交流电动机用启动、运行电容，包括插片电容、插针电容、安全膜防爆电容、静音型电容。在空调窗机、分体机、柜机、变频机及大型商用空调等设备中广泛应用。

Mainly produce the capacitor with steel lug, capacitor with tinned copper wire, P2 rupture-proof capacitor, noise-resistant capacitor which is used for Air Conditioner Motor's starting & running. It's widely used for Window Air Conditioner, Fission Air Conditioner, Cabinet Air Conditioner, Frequency Conversion Air Conditioner and large Commercial Air Conditioner, etc. Equipment.



转盘式喷砂机  
Rotary metal spraying machine



卷绕机  
Automatic winding machine



真空注环氧机  
Vacuum impregnating epoxy machine



# 空调电容器

## AIR CONDITIONING CAPACITOR

采用电工级聚丙烯薄膜介质、加厚型金属化电极，94V0级阻燃塑壳、环氧树脂密封，标准型快接端子引出，具有自愈性好、电气性能稳定等特点。

The products are made of electrical class metallized polypropylene film, thickened metallized electrode, 94V0 level flame-resistant plastic box, and enveloped with epoxy resin, led by standard quick-connect terminals. They have the characteristics of good self-healing, stable performance and so on.

# 插片系列

## Insert Series

# CBB61

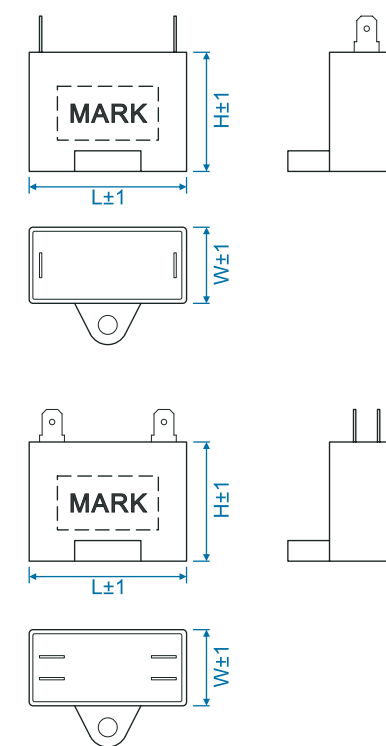

认证标志 Safety approvals	CQC, UL, VDE
执行标准 Implemented standard	GB/T3667, UL810, EN60252
气候类别 Climatic category	25/70/21, 25/85/21, 40/70/21, 40/85/21
额定电压 Rated voltage	250VAC, 450VAC, 500VAC (50/60Hz)
容量范围 Capacitance range	1μF ~ 15μF
容量偏差 Capacitance tolerance	±5%(J), ±10%(K), +10%/-5%(U)
试验电压 Testing voltage	
极间 between terminals	2*U <sub>N</sub> (VAC) / 60s
极壳 between terminals and case	2*U <sub>N</sub> +1000(VAC) / 60s(≥2000VAC)
绝缘电阻 Insulation resistance(20°C)	
极壳 between terminals and case	≥2000MΩ (500VDC, 60s)
损耗角正切 Tangent of loss angle(20°C)	≤0.002 (100Hz)

常用规格 Dimension		Unit : mm								
Rated cap.	250VAC			450VAC			500VAC			
	L	W	H	L	W	H	L	W	H	
1.0μF	—	—	—	37	11	22	37	12.5	24	
1.5μF	—	—	—	37	13.5	24	37	15.5	26	
2.0μF	—	—	—	37	15.5	26	37	17	28	
2.5μF	32	11	22	37	17	28	37	19.5	31	
3.0μF	32	12	22	47	17	27	47	19	29	
3.5μF	37	12	22	47	18	27	47	20.5	31.5	
4.0μF	37	12.5	24	47	19	29	47	21	32	
5.0μF	37	13.5	24	47	21	32	47	23	35	
6.0μF	37	15	26	47	22	34	47	26.5	38	
6.5μF	37	15	27	47	23	35	47	27	37	
8.0μF	37	18.5	29	57	24	33	57	28	40	
9.0μF	37	19.5	31	57	26	38	57	28	40	
10.0μF	37	20	30	57	26	38	57	30	42	

典型线路图  
Typical circuit

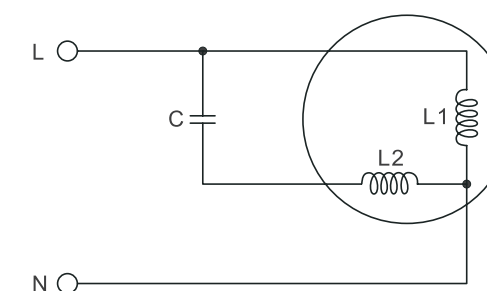

C: 启动运转电容  
Running capacitor

# 空调电容器

## AIR CONDITIONING CAPACITOR

采用电工级聚丙烯薄膜介质、加厚型金属化电极，94V0级阻燃塑壳、环氧树脂密封，镀锡铜线引出。实现全自动化生产，具有一致性好，性能稳定性高等特点。

The products are made of electrical class metallized polypropylene film, thickened metallized electrode, 94V0 level flame-resistant plastic box, and enveloped with epoxy resin, welded by tinned copper wire to realize automatic production. They have the characteristics of good uniformity, high stability and so on.

# 插针系列

## Pin Series

# CBB61

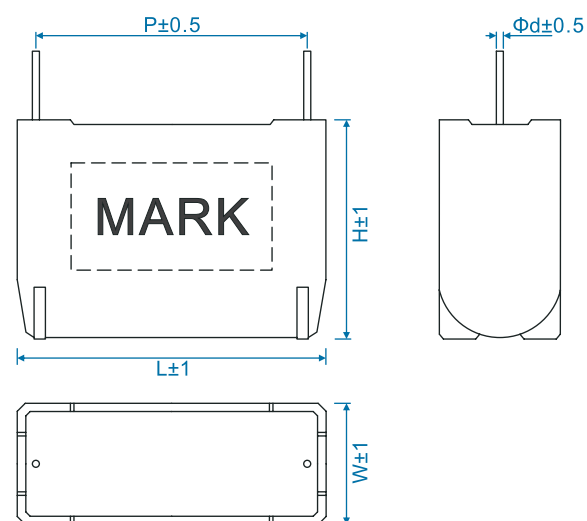

认证标志 Safety approvals	CQC, UL, VDE
执行标准 Implemented standard	GB/T3667, UL810, EN60252
气候类别 Climatic category	25/70/21, 25/85/21, 40/70/21, 40/85/21
额定电压 Rated voltage	450VAC (50/60Hz)
容量范围 Capacitance range	1µF ~ 3.5µF
容量偏差 Capacitance tolerance	±5%(J), ±10%(K), +10%/-5%(U)
试验电压 Testing voltage	
极间 between terminals	2*U <sub>N</sub> (VAC) / 60s
极壳 between terminals and case	2*U <sub>N</sub> +1000(VAC) / 60s(≥2000VAC)
绝缘电阻 Insulation resistance(20°C)	
极壳 between terminals and case	≥2000MΩ (500VDC, 60s)
损耗角正切 Tangent of loss angle(20°C)	≤0.002 (100Hz)

常用规格 Dimension		Unit : mm				
Rated cap.	450VAC					
	L	W	H	P	Φd	
1.0µF	36	10.5	20	32	0.8/1.0	
1.2µF	36	11	22	32	0.8/1.0	
1.5µF	36	12.5	23	32	0.8/1.0	
2.0µF	36	14.5	25.5	32	0.8/1.0	
2.5µF	36	17	26	32	0.8/1.0	
3.0µF	36	17.5	29	32	0.8/1.0	
3.5µF	36	19.5	32	32	0.8/1.0	

典型线路图  
Typical circuit

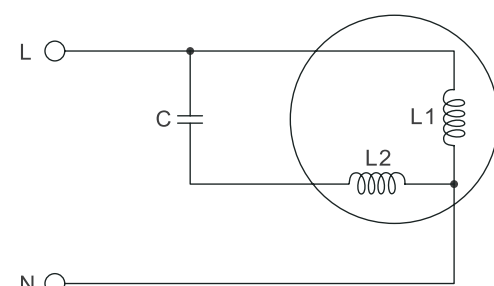

C: 启动运转电容  
Running capacitor

# 空调电容器

## AIR CONDITIONING CAPACITOR

专为空调一线品牌而精心设计、制造的静音型电容。采用耐温型聚丙烯薄膜介质、高方阻金属化电极、94V0级阻燃塑壳和环氧树脂封装，采取特殊的静音处理工艺，全方位增强型圆弧过渡底耳，开口式椭圆形可调节安装孔，使产品具有低噪音，长寿命，安装定位高效轻松的特点。

This kind of noise-resistant capacitor is specially design and made for air conditioner of famous brand. It's made of temperature-resistant metallized polypropylene film, high resistance metallized electrode, 94V0 level flame-resistant plastic box and epoxy resin enveloped. Adopt special noise-resistant management process, a full range of enhanced arc transition at the end of the ear and open oval adjustable install hole, and it has the characteristics of low noise, long life, easy installation, etc.

# 静音系列

## Noise-resistant Series

# CBB61

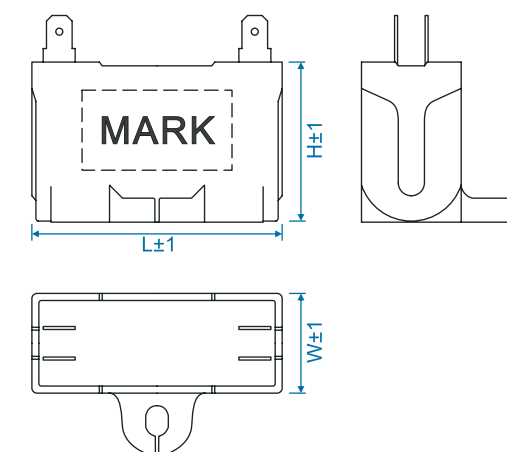

认证标志 Safety approvals	CQC, UL, VDE
执行标准 Implemented standard	GB/T3667, UL810, EN60252
气候类别 Climatic category	25/70/21, 25/85/21, 40/70/21, 40/85/21
额定电压 Rated voltage	450VAC (50/60Hz)
容量范围 Capacitance range	1µF ~ 10µF
容量偏差 Capacitance tolerance	±5%(J), ±10%(K), +10%/-5%(U)
试验电压 Testing voltage	
极间 between terminals	2*U <sub>N</sub> (VAC) / 60s
极壳 between terminals and case	2*U <sub>N</sub> +1000(VAC) / 60s(≥2000VAC)
绝缘电阻 Insulation resistance(20°C)	
极壳 between terminals and case	≥2000MΩ (500VDC, 60s)
损耗角正切 Tangent of loss angle(20°C)	≤0.002 (100Hz)

常用规格 Dimension		Unit : mm		
Rated cap.	450VAC			
	L	W	H	
1.0µF	37	11	22	
1.5µF	37	13.5	24	
2.0µF	37	15.5	27	
2.5µF	37	18.5	29	
3.0µF	47	17	27	
3.5µF	47	18	27	
4.0µF	47	19	30	
4.5µF	47	21	32	
5.0µF	47	22	33	
6.0µF	47	23	35	
8.0µF	57	24	33	
10.0µF	57	26	38	

典型线路图  
Typical circuit

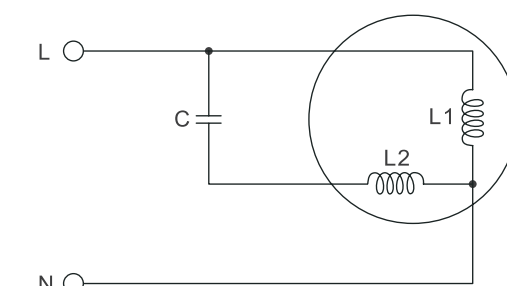

C: 启动运转电容  
Running capacitor

# 空调电容器

## AIR CONDITIONING CAPACITOR

采用电工级聚丙烯薄膜介质、安全型金属化电极，94V0级阻燃塑壳、环氧树脂密封，标准型引出端。运用特殊制造工艺，具有电气性能稳定，安全防爆等特点。防爆等级为P2级，应用于空调高端机型。

The products are made of electrical class metallized polypropylene film, safety metallized electrode, 94V0 level flame-resistant plastic box, and enveloped with epoxy resin, led by standard terminals. Adopt special manufacturing process, they have the characteristics of stable performance, safety and explosion protection and so on. The explosion-proof class is P2, and applied in high-end air conditioner.

# 安全防爆系列

## Safety Explosion Protection Series

# CBB61-S3(P2)

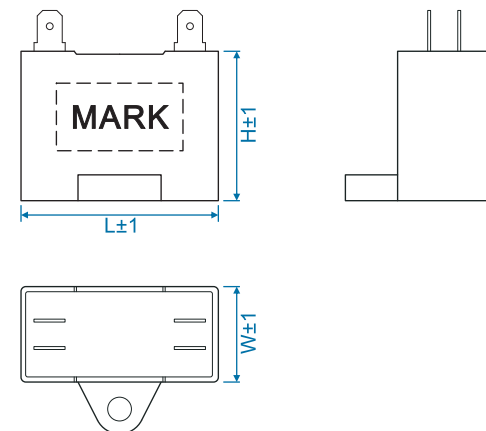

典型线路图  
Typical circuit

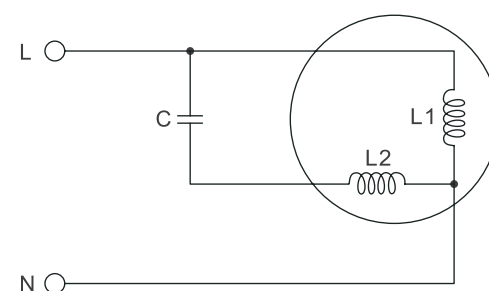

C: 启动运转电容  
Running capacitor

认证标志 Safety approvals	CQC, UL, TUV
执行标准 Implemented standard	GB/T3667, UL810, EN60252
气候类别 Climatic category	25/70/21, 25/85/21, 40/70/21, 40/85/21
额定电压 Rated voltage	250VAC, 450VAC (50/60Hz)
容量范围 Capacitance range	1µF ~ 8µF
容量偏差 Capacitance tolerance	±5%(J), ±10%(K), +10%/-5%(U)
试验电压 Testing voltage	
极间 between terminals	2*U <sub>N</sub> (VAC) / 60s
极壳 between terminals and case	2*U <sub>N</sub> +1000(VAC) / 60s(≥2000VAC)
绝缘电阻 Insulation resistance(20°C)	
极壳 between terminals and case	≥2000MΩ (500VDC, 60s)
损耗角正切 Tangent of loss angle(20°C)	≤0.002 (100Hz)
防护等级 Class of safety protection	S3(P2)
故障电流 Fault current	10,000AFC (UL810)

常用规格 Dimension		Unit : mm				
Rated cap.	250VAC			450VAC		
	L	W	H	L	W	H
1.0µF	—	—	—	37	11	22
1.5µF	—	—	—	37	13.5	24
2.0µF	—	—	—	37	17	28
3.0µF	—	—	—	47	17	28
3.5µF	—	—	—	47	19	29
4.0µF	37	13.5	24	47	19	31
5.0µF	37	15	25	47	22	34
6.0µF	37	15.5	26	47	23	35
8.0µF	37	18.5	29	47	28	40

# 安全膜类电容防爆原理

## THE EXPLOSION PROTECTION THEORY OF SAFETY FILM CAPACITORS

金属化电极采用微保险丝网状结构（如图），在电容运行发生故障时，通过微保险丝断开，自动切断电源，从而防止故障扩大，达到自我安全保护目的。

The metallization electrode adopting micro fuse mesh structure (pictured), and in the capacitance operation is at fault, through the micro fuse disconnect, which cut off power supply, prevent fault expand to self protection safety purposes.

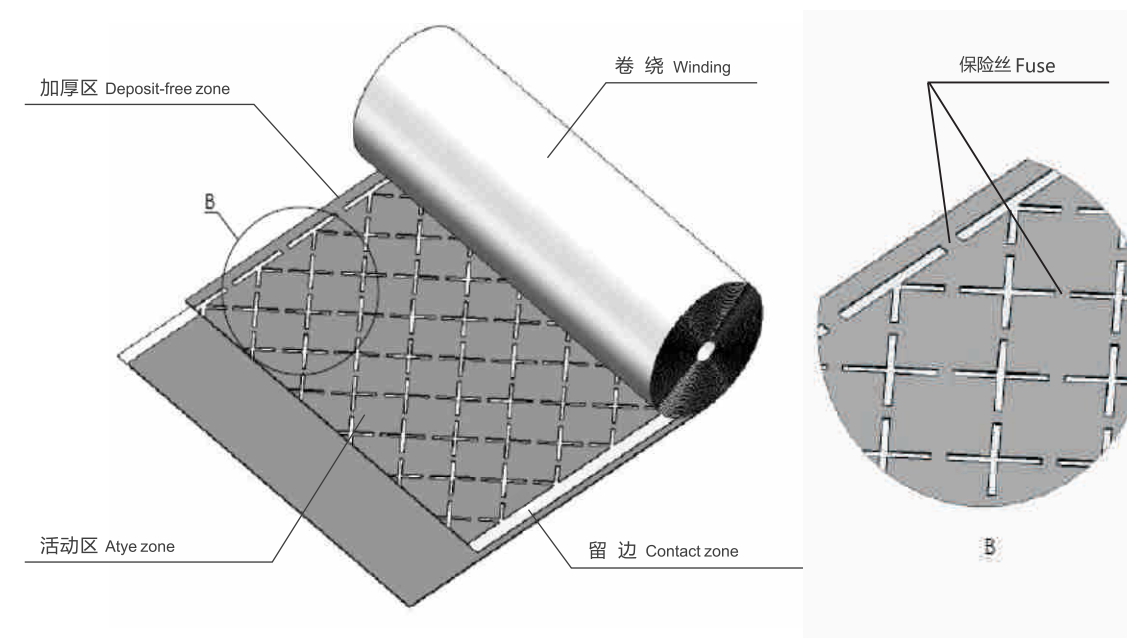

# 安全膜不同状态 Different status of the safety films

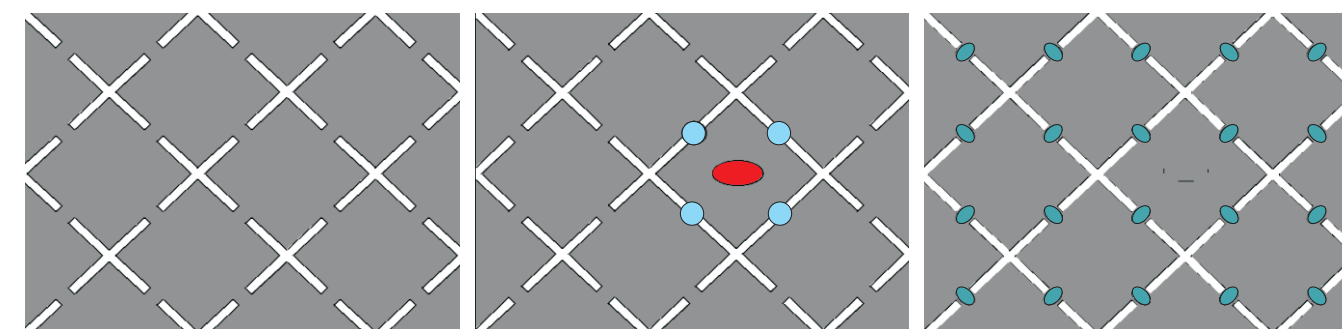

正常状态 Normal status

● 故障点 Accident area

● 小单元保险丝动作，脱开电路，局部保护  
Small unit fuse action, to take off the open circuit, local protection.

● 电容器失效后，内部保险丝完全断开，电容器形成开路状态。  
After the failure of the capacitor, internal fuse completely cut off, it form open state

# 60/65电容器事业部

## 60/65 CAPACITOR DEPARTMENT

主要产品有电动机启动、运行电容，灯具功率因数补偿电容，在水泵、电冰箱、洗衣机、灯具、工程照明、碎纸机、空压机、管机中广泛应用。

Mainly produce Motor Capacitor for starting & running, lighting Capacitor for power factor compensate, It's widely used for Water Pump, Refrigerator, Washing Machine, Lighting, Engineer Lighting, Smash Paper Machine, Air Compressor, Tubular Motor.



190全自动卷绕机  
Automatic winding machine



成品自动测试机  
Automatic product testing machine



# 60/65电容器

## 60/65 CAPACITORS

# CBB60



选用优质电工级聚丙烯薄膜作介质、复合型高纯度金属为电极，干式结构设计，阻燃塑壳或金属铝壳、环氧树脂密封，安全等级P2或P0可选。该系列产品具有高性价比、高耐压强度、长寿命等特点，主要适用于水泵、洗衣机、碎纸机、管机等交流电动机的启动和运行。

The products are made of electrical class metallized polypropylene film, complex high pure metallized electrode, dry fabric, flame-resistant plastic or aluminum shell and oxygen resin enveloped. The protection class is P2 and P0. And they have the characteristics of high cost performance, high pressure-resistant, long life and so on. Mainly used to starting and running of the AC motor, such as the water pump, washing machine, paper smash machine, tubular motor and so on.

认证标志 Safety approvals	CQC、UL、CUL、VDE
执行标准 Implemented standard	GB/T3667.1、UL810、EN60252-1
气候类别 Climatic category	25/70/21、25/85/21、40/70/21、40/85/21
额定电压 Rated voltage	150VAC ~ 600VAC (50/60Hz)
容量范围 Capacitance range	1μF ~ 80μF
容量偏差 Capacitance tolerance	±5%(J)、±10%(K)、+10%/-5%(U)
试验电压 Testing voltage	
极间 between terminals	2*U <sub>N</sub> (VAC) / 60s
极壳 between terminals and case	2*U <sub>N</sub> +1000(VAC) / 60s(≥2000VAC)
绝缘电阻 Insulation resistance(20°C)	
极间 between terminals	≥2000MΩ · μF (500Vdc, 60s)
损耗角正切 Tangent of loss angle(20°C)	≤0.002 (100Hz)
防护等级 Class of safety protection	P0 / P2
故障电流 Fault current	10,000AFC (UL810)

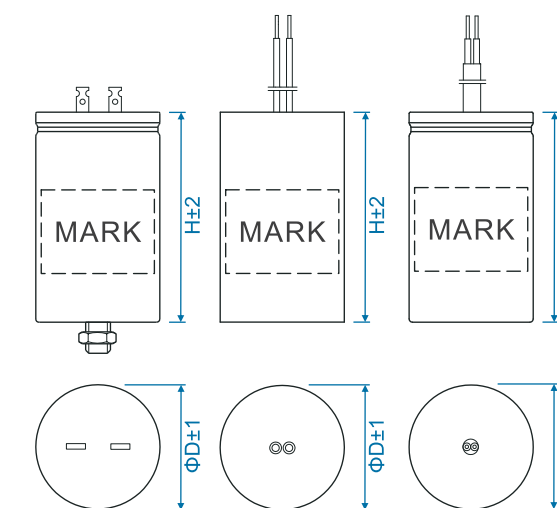

### 常用规格 Dimension

Rated cap.	250/300VAC		350VAC		400/450VAC		500VAC	
	ΦD	H	ΦD	H	ΦD	H	ΦD	H
6μF	25	57	—	—	30	60	—	—
8μF	30	60	—	—	35	60	—	—
10μF	30	60	—	—	40	60	40	70
12μF	35	60	35	60	40	60	—	—
15μF	35	60	—	—	40	70	—	—
18μF	35	60	—	—	45	70	—	—
20μF	40	60	40	70	45	70	45	80
25μF	40	60	45	70	45	80	—	—
30μF	40	70	45	80	45	90	50	90
35μF	—	—	—	—	50	90	—	—
40μF	45	70	45	90	50	100	55	110

典型线路图  
Typical circuit

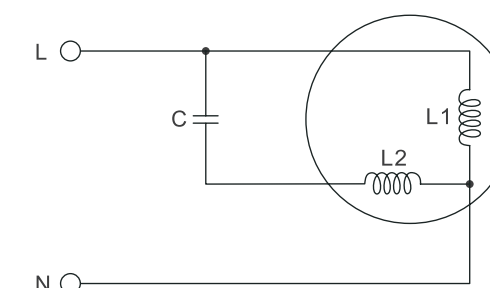

C: 启动运转电容  
Running capacitor

# 60/65电容器

## 60/65 CAPACITORS

# CBB65

选用优质电工级聚丙烯薄膜作介质、加厚复合金属化为电极，金属壳体，真空注油，250#快接端子引出，P2级压力式防爆结构。该系列产品具有散热快、抗腐蚀、安全可靠等特点，主要用于安全要求高的交流电动机启动、运行及储能、滤波等场合。

The products are made of electrical class metallized polypropylene film, thickened metallized electrode, metal box, vacuum oiling, 250# quick-connect terminal leading, P2 class pressure-type and explosion-proof structure. They have the characteristics of fast heat dissipation, resistant to decay and so on. Mainly applied to starting and running of the high safe require AC motors, store energy, sieve wave, etc.

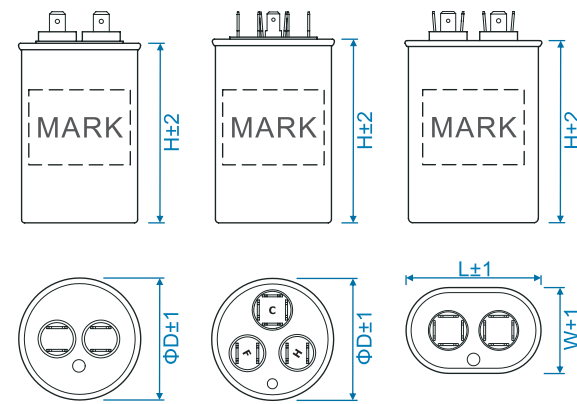

认证标志 Safety approvals	CQC, UL, CUL, TUV
引用标准 Implemented standard	GB/T3667.1, UL810, EN60252-1
气候类别 Climatic category	25/70/21, 25/85/21, 40/70/21, 40/85/21
额定电压 Rated voltage	150VAC ~ 600VAC (50/60Hz)
容量范围 Capacitance range	3μF ~ 100μF
容量偏差 Capacitance tolerance	±5%(J), ±10%(K), $\pm \frac{+10}{-5}\%$ (U)
试验电压 Testing voltage	
极间 between terminals	$2 \cdot U_N(\text{VAC}) / 60\text{s}$
极壳 between terminals and case	$2 \cdot U_N + 1000(\text{VAC}) / 60\text{s} (\geq 2000\text{VAC})$
绝缘电阻 Insulation resistance(20°C)	
极间 between terminals	$\geq 2000\text{M}\Omega \cdot \mu\text{F} (500\text{Vdc}, 60\text{s})$
损耗角正切 Tangent of loss angle(20°C)	$\leq 0.002 (100\text{Hz})$
防护等级 Class of safety protection	P2
故障电流 Fault current	10,000AFC (UL810)

Rated cap.	常用规格 Dimension Unit: mm					
	250/300VAC			400/450VAC		
	Cylindrical	Oval		Cylindrical	Oval	
10μF	ΦD	H	L*W*H	ΦD	H	L*W*H
15μF	40	55	51.5*31.5*65	40	65	51.5*31.5*65
20μF	40	65	51.5*31.5*75	40	75	51.5*31.5*75
25μF	40	65	51.5*31.5*75	45	85	51.5*31.5*85
30μF	—	—	—	45	95	71.5*45*75
32μF	40	75	71.5*45*65	—	—	—
35μF	—	—	—	50	95	71.5*45*85
40μF	45	75	71.5*45*75	—	—	—
50μF	45	85	71.5*45*85	50	115	71.5*45*100
60μF	45	95	71.5*45*100	—	—	—

### 压力式防爆原理 Pressure explosion-proof theory

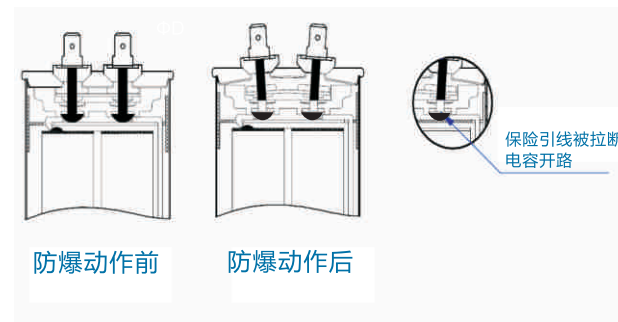

# 60/65电容器

## 60/65 CAPACITORS

# 灯具电容器系列

## Light Capacitors Series

选用耐高温型聚丙烯薄膜作介质、加厚复合金属化为电极，特殊喷金工艺制作，耐温阻燃塑壳或金属铝壳封装，自带放电功能，安全防护P2或P0级。该系列产品具有耐高温、阻燃性能强等特点，主要适用于各种家照、商照、工程灯具启动触发及功率因素补偿电路。

The products are made of electrical class metallized polypropylene film, thickened metallized electrode, thicken complex metallized electrode, and make with metal spraying craft, enveloped with flame-resistant plastic or aluminum box, have the function to discharge electricity by themselves, and the protection class is P2 and P0 class. They have the characteristics of high temperature resistant, good flame-resistant performance. Mainly used in home light, office light, engineering light starting and power factor compensate circuit.



引用标准 Implemented standard	GB/T18504, EN61048/61049, UL810
气候类别 Climatic category	25/85/21, 40/85/21, MAX .TEMP +105°C
额定电压 Rated voltage	150VAC ~ 630VAC (50/60Hz)
容量范围 Capacitance range	3μF ~ 60μF
容量偏差 Capacitance tolerance	±3%, ±5%(J), $\pm \frac{+10}{-5}\%$ (U)
试验电压 Testing voltage	
极间 between terminals	$2 \cdot U_N(\text{VAC}) / 60\text{s}$
极壳 between terminals and case	$2 \cdot U_N + 1000(\text{VAC}) / 60\text{s} (\geq 2500\text{VAC})$
绝缘电阻 Insulation resistance(20°C)	
极间 between terminals	$\geq 2000\text{M}\Omega (500\text{Vdc}, 60\text{s})$
损耗角正切 Tangent of loss angle(20°C)	$\leq 0.002 (100\text{Hz})$
防护等级 Class of safety protection	P0 / P2
故障电流 Fault current	10,000AFC (UL810)
放电性能 Discharge performance	
$\sqrt{2} U_N$ 下断开后 60S 剩余电压 < 50V	
$\sqrt{2} U_N$ disconnected under the residual voltage less than 50V 60s	
稳态过电压 Steady-state over-voltage	
允许1.1 $U_N$ 下长期运行 Allowed under the long-running 1.1 $U_N$	
稳态过电流 Steady-state over-current	
允许1.3 $I_N$ 下长期运行 1.3 $I_N$ the next permit long-term operation	

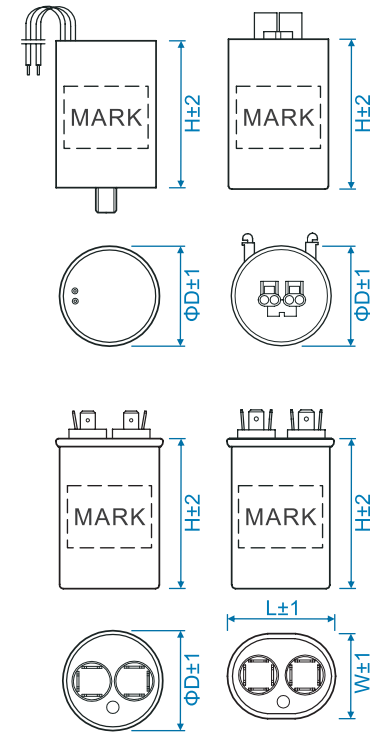

Rated cap.	常用规格 Dimension Unit: mm								
	250/330VAC		400/450VAC		525/540VAC				
	Cylindrical	Oval	Cylindrical	Oval	Cylindrical	Oval			
ΦD	H	L*W*H	ΦD	H	L*W*H	ΦD	H	L*W*H	
8μF	35	60	51.5*31.5*65	40	65	51.5*31.5*65	40	65	—
10μF	35	60	51.5*31.5*65	40	65	51.5*31.5*65	40	65	—
12μF	35	60	51.5*31.5*75	40	65	51.5*31.5*75	40	65	—
16μF	40	70	51.5*31.5*75	45	75	—	40	75	—
18μF	40	70	51.5*31.5*85	45	85	71.5*45*75	40	75	—
20μF	40	70	51.5*31.5*85	45	85	—	—	—	—
24μF	40	80	51.5*31.5*85	50	85	—	50	105	71.5*45*105
25μF	40	80	71.5*45*75	50	85	51.5*31.5*75	—	—	—
26μF	45	80	71.5*45*75	50	85	—	55	105	71.5*45*110
32μF	45	80	71.5*45*75	50	105	71.5*45*105	55	120	71.5*45*130
36μF	45	95	71.5*45*75	55	105	71.5*45*120	—	—	—
55μF	50	95	71.5*45*100	—	—	—	—	—	—

### 典型线路图 Typical circuit

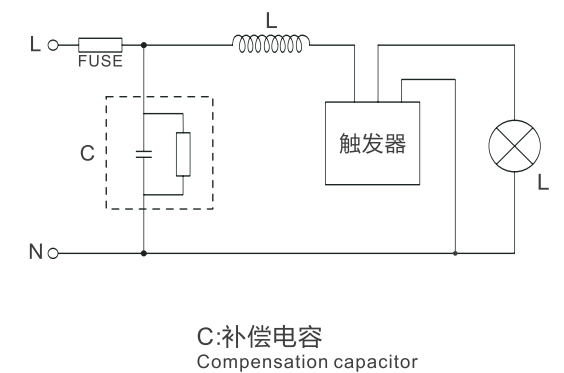



# 针式电容器事业部

## INDUCTION HEATING CAPACITOR DEPARTMENT

主要生产跨线抗干扰电容、平滑滤波电容、高压谐振电容。在家用及商用电磁炉、工业用加热设备及其他感应加热装置中广泛应用。

Mainly produce Jumper Wire Interference Capacitor, Smooth Filter Capacitor, High Voltage Resonance Capacitor. It's widely used for Industrial Induction Cooker, Industrial Heating Equipment and other inductive heating device.



# 电磁炉电容器 跨线抗干扰系列

## INDUCTION COOKER JUMPER WIRE INTERFERENCE SERIES

采用耐温型聚丙烯薄膜介质，加厚型金属化电极，全自动化生产，具有一致性好，稳定性高等特点。

专用于电磁炉等感应加热装置的并联跨线回路。

The products are made of temperature-resistant metallized polypropylene film, thickened metallized electrode, fully automatic produce. And they have the characteristics of good uniformity, high stability and so on. Mainly used in parallel connection jumper wire return circuit of induction cooker and other induction heating equipment.

# MKP



引用标准 Reference standard GB/T14472、IEC60384-14、UL1283

气候类别 Climatic category 40 / 105 / 21

额定电压 Rated voltage 150VAC、275VAC (50/60Hz)

容量范围 Capacitance range 0.01 $\mu$ F ~ 12 $\mu$ F

容量偏差 Capacitance tolerance  $\pm$ 5%(J)、 $\pm$ 10%(K)

耐电压 Voltage proof

极间 between terminals 1.8\*U<sub>r</sub> / 60s

极壳 between terminals and case 2\*U<sub>r</sub>+1000(VAC) / 60s( $\geq$ 2000VAC)

绝缘电阻 Insulation resistance(20°C)

极间 between terminals  $\geq$ 5000S (100Vdc,60s)

极壳 between terminals and case  $\geq$ 30000M $\Omega$  (100Vdc,60s)

损耗角正切 Tangent of loss angle(20°C)  $\leq$ 0.001 (1KHz)

电压爬升率 Pulse rise time(dv/dt) 30V/ $\mu$ s Max

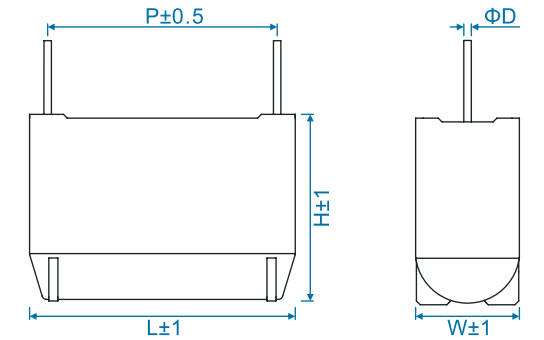

### 常用规格 Dimension Unit : mm

Rated cap.	150VAC					275VAC				
	L	W	H	P	ΦD	L	W	H	P	ΦD
1.0 $\mu$ F	—	—	—	—	—	30	8	15	26.5	0.8
1.2 $\mu$ F	—	—	—	—	—	31	8	19	26.5	0.8
1.5 $\mu$ F	—	—	—	—	—	32	11	20	26.5	0.8
2.0 $\mu$ F	—	—	—	—	—	30	12	19	26.5	0.8
2.2 $\mu$ F	—	—	—	—	—	32	12	22	26.5	0.8
3.0 $\mu$ F	—	—	—	—	—	36	13	20	31.0	0.8
3.3 $\mu$ F	—	—	—	—	—	36	13	23	31.0	0.8
4.7 $\mu$ F	—	—	—	—	—	36	17	26	31.0	1.0
8.0 $\mu$ F	36	17	26	31.0	1.0	—	—	—	—	—
8.0 $\mu$ F	36	25	18	31.0	1.0	—	—	—	—	—
10.0 $\mu$ F	36	26	21	31.0	1.0	—	—	—	—	—

典型线路图  
Typical circuit

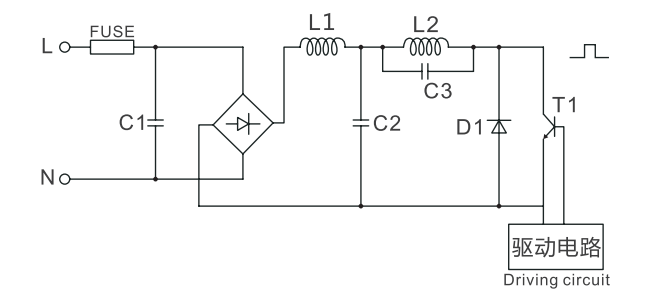

C1:跨线电容  
Across-the-line capacitor

包装机  
Wrapping machine



全自动测试机  
Automatic testing machine



全自动组立线  
Automatic assembly line

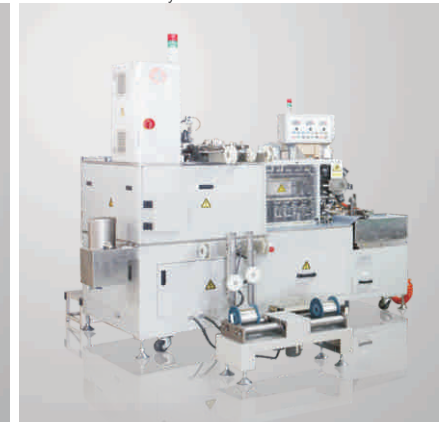



# 电磁炉电容器 平滑滤波系列

## INDUCTION COOKER SMOOTHING FILTER SERIES

# MKP

采用耐温型聚丙烯薄膜介质，加厚型金属化电极，大电流全检测试，全自动化生产，具有一致性好，稳定性高等特点。

专用于电磁炉等感应加热装置的平滑滤波电路。

The products are made of temperature-resistant metallized polypropylene film, thickened metallized electrode, heavy current full inspection testing, full automatic production. They have characteristics of good uniformity, high stability and so on. Specifically used in smooth filter circuit of induction cooker and other induction heating equipment.



引用标准 Reference standard	GB/T14472、IEC60384-14、UL1283
气候类别 Climatic category	40 / 105 / 21
额定电压 Rated voltage	150VAC、400VDC (275VAC)
容量范围 Capacitance range	3μF ~ 15μF
容量偏差 Capacitance tolerance	±5%(J)、±10%(K)
耐电压 Voltage proof	
极间 between terminals	1.8*U <sub>r</sub> / 60s
极壳 between terminals and case	2*U <sub>r</sub> +1000(VAC) / 60s(≥2000VAC)
绝缘电阻 Insulation resistance(20°C)	
极间 between terminals	≥5000S (100Vdc,60s)
极壳 between terminals and case	≥30000MΩ (100Vdc,60s)
损耗角正切 Tangent of loss angle(20°C)	≤0.001 (1KHz)
电压爬升率 Pulse rise time(dv/dt)	30V/μs Max

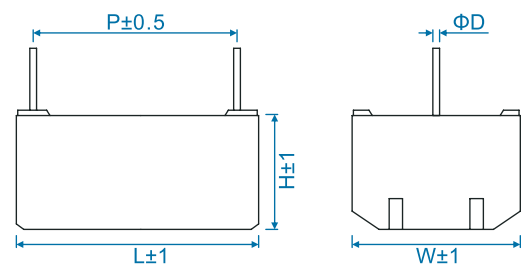

常用规格 Dimension		Unit : mm				
Rated cap.	400VDC(275VAC)					
	L	W	H	P	ΦD	
4.0μF	36	22	17	31	1.0	
4.0μF	36	14	25	31	1.0	
5.0μF	36	25	18	31	1.0	
5.0μF	36	17	25	31	1.0	
6.0μF	36	26	21	31	1.0	
6.0μF	36	17.5	29	31	1.0	
6.8μF	36	26	21	31	1.0	
8.0μF	36	30	22	31	1.0	
10.0μF	36	26	21	31	1.0	
12.0μF	36	19.5	32	31	1.0	
15.0μF	46	23.5	38	41	1.0	

典型线路图  
Typical circuit

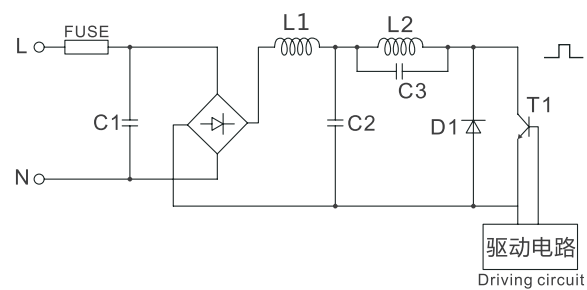

C2:滤波电容  
Filter capacitor

# 电磁炉电容器 高压谐振系列

## INDUCTION COOKER HIGH VOLTAGE RESONANCE SERIES

# MKPH

采用耐温型聚丙烯薄膜介质，内串式双面加厚型金属化电极，无感式结构，DV/DT全检测试，全自动化生产，具有一致性好，稳定性高等特点。

专用于电磁炉等感应加热装置的高频振荡回路。

The products are made of temperature-resistant metallized polypropylene film, both side thickened metallized electrode, non-inductive construction, DV/DT full inspection testing, full automatic production. They have characteristics of good uniformity, high stability and so on. Specifically used in high frequency vibration return circuit of induction cooker and other induction heating equipment.



引用标准 Reference standard	GB/T14472、IEC60384-14、UL1283
气候类别 Climatic category	40 / 105 / 21
额定电压 Rated voltage	1000VDC、1200VDC、1600VDC、2000VDC
容量范围 Capacitance range	0.01μF ~ 0.9μF
容量偏差 Capacitance tolerance	±5%(J)、±10%(K)
耐电压 Voltage proof	
极间 between terminals	2*U <sub>r</sub> (VDC) / 10s
极壳 between terminals and case	2*U <sub>r</sub> +1000(VAC) / 60s(≥2000VAC)
绝缘电阻 Insulation resistance(20°C)	
极间 between terminals	≥30000S (100Vdc,60s)
极壳 between terminals and case	≥30000MΩ (100Vdc,60s)
损耗角正切 Tangent of loss angle(20°C)	≤0.0007 (10KHz)
电压爬升率 Pulse rise time(dv/dt)	500V/μs Max

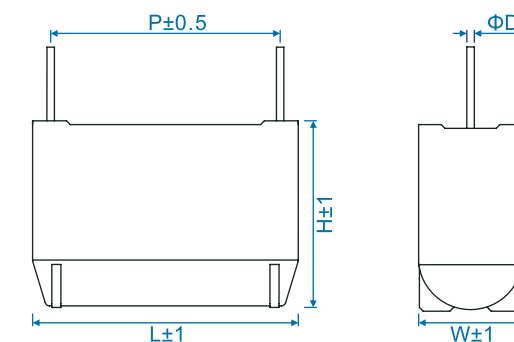

常用规格 Dimension		Unit : mm				
Rated Cap.	1000VDC					
	L	W	H	P	ΦD	
0.10μF	26	12	23	22.0	1.0	
0.15μF	35	10.5	21.5	30.5	1.0	
1200VDC						
0.24μF	36	12.5	24	30.5	1.0	
0.27μF	35	13	24	30.5	1.0	
0.27μF	35	21.5	16	30.5	1.0	
0.30μF	35	14	25	30.5	1.0	
0.30μF	35	23	16.5	30.5	1.0	
0.33μF	35	15	26	30.5	1.0	
0.68μF	36	22	33	30.5	1.0	
1600VDC						
0.30μF	36	17.5	29	30.5	1.0	
0.33μF	36	19.5	32	30.5	1.0	

典型线路图  
Typical circuit

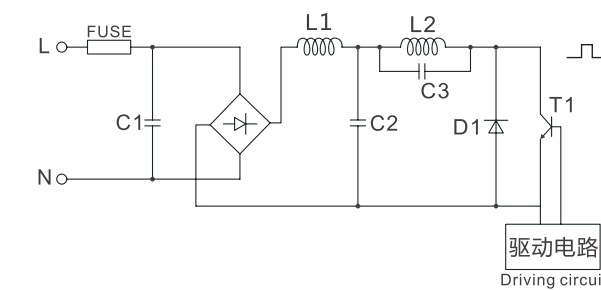

C3:谐振电容  
Resonance capacitor

# 电磁炉电容器 小型化系列

## SMALL TYPE INDUCTION COOKER CAPACITOR SERIES

# MKP MKPH

专为满足小功率、超薄型电磁炉市场需求而设计、制造的小型化产品，性价比高，分别用于茶炉、超薄电磁炉的干扰抑制、平滑滤波、谐振电路。

The small type products are specially designed and manufactured for the marketing demand of low power, ultra-thin induction cooker. And they are of high cost performance. Specifically used in interference, smooth filter and resonance circuit of tea cooker and ultra-thin induction cooker.



引用标准 Reference standard	275VAC/400VDC : GB/T14472、IEC60384-14、UL1283 1200VDC : GB/T3984.1-2004、GB/T3984.2-2004
气候类别 Climatic category	40 / 105 / 21
额定电压 Rated voltage	275VAC(C1); 400VDC(C2); 1200VDC(C3)
容量范围 Capacitance range	0.01μF ~ 10μF
容量偏差 Capacitance tolerance	±5%(J)、±10%(K)
耐电压 Voltage proof	
极间 between terminals	1.5*U <sub>R</sub> / 10s
极壳 between terminals and case	2*U <sub>R</sub> +1000(VAC) / 60s(≥2000VAC)
绝缘电阻 Insulation resistance(20°C)	
极间 between terminals	≥15000S, C <sub>R</sub> ≤0.33μF (100Vdc,60s) ≥5000S, C <sub>R</sub> >0.33μF (100Vdc,60s)
极壳 between terminals and case	≥30000MΩ (100Vdc,60s)
损耗角正切 Tangent of loss angle(20°C)	≤0.001 (1KHz)

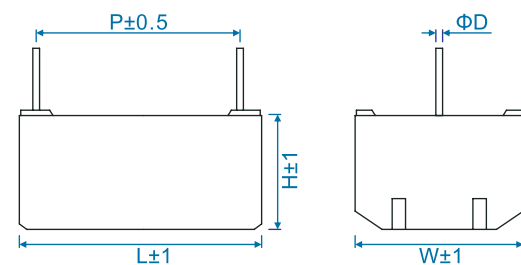

Rated Cap.	L	W	H	P	ΦD
C1: 275VAC					
1.0μF	30	7	15	26.5	0.8
2.0μF	30	9.1	17	26.5	0.8
3.3μF	30	12	22	26.5	0.8
C2: 400VDC(275VAC)					
4.0μF	30	20	29	13.5	24.5
4.0μF	30	12.5	22	26.5	1.0
5.0μF	30	22.5	16	26.5	1.0
5.0μF	30	11.5	27	26.5	1.0
C3: 1200VDC					
0.24μF	28.6	12.7	22	24.5	1.0
0.27μF	28.5	20.5	15.5	24.5	1.0
0.27μF	29.0	13.5	23	24.5	1.0
0.30μF	28.5	21.5	16.5	24.5	1.0
0.30μF	29	13.5	24.5	24.5	1.0

典型线路图  
Typical circuit

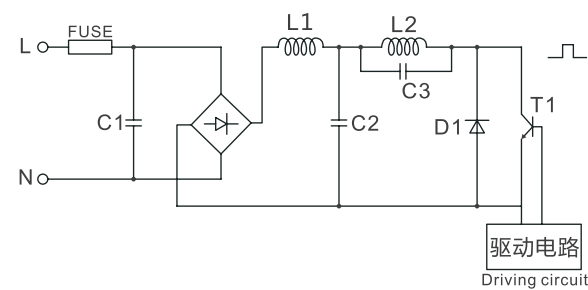

C1:跨线电容  
Across-the-line capacitor  
C2:滤波电容  
Filter capacitor  
C3:谐振电容  
Resonance capacitor

# 电磁炉电容器 安全型跨线系列

## JUMPER WIRE SAFETY INDUCTION COOKER SERIES

# MKP

采用高分子聚丙烯薄膜介质，特殊安全型金属化电极制造工艺，具有失效后防止自燃的安全特点。专用于有安全要求的高端机型电源并联跨线回路。

The products are made of polymer metalized polypropylene film, special safety metalized electrode, and they have characteristics of preventing self-ignition if any broken. Specifically used in across-the-line circuit of the highend equipment with safety requirement.

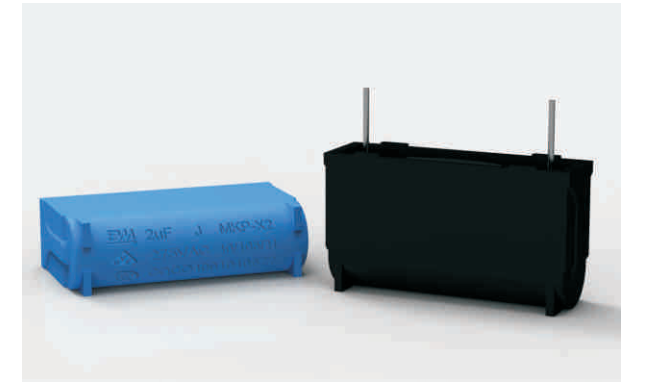

引用标准 Reference standard	GB/T14472、IEC60384-14、UL1283
气候类别 Climatic category	40 / 105 / 21
额定电压 Rated voltage	150VAC ~ 450VAC (50/60Hz)
容量范围 Capacitance range	1μF ~ 15μF
容量偏差 Capacitance tolerance	±5%(J)、±10%(K)
耐电压 Voltage proof	
极间 between terminals	1.5*U <sub>R</sub> / 60s
极壳 between terminals and case	2*U <sub>R</sub> +1000(VAC) / 60s(≥2000VAC)
绝缘电阻 Insulation resistance(20°C)	
极间 between terminals	≥5000S (100Vdc,60s)
极壳 between terminals and case	≥30000MΩ (100Vdc,60s)
损耗角正切 Tangent of loss angle(20°C)	≤0.001 (1KHz)
电压爬升率 Pulse rise time(dv/dt)	30V/μs Max

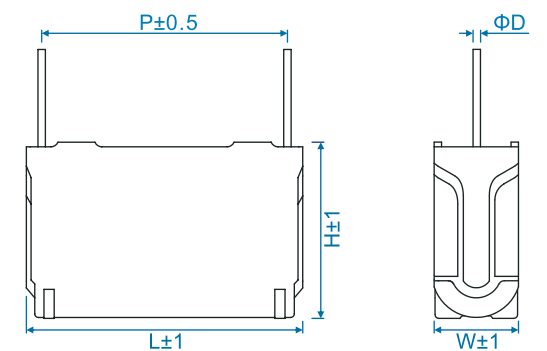

Rated cap.	275VAC					450VAC				
	L	W	H	P	ΦD	L	W	H	P	ΦD
1.0μF	—	—	—	—	—	36	10.5	21.5	32	0.8
1.2μF	—	—	—	—	—	36	13	23	32	0.8
1.5μF	—	—	—	—	—	36	13	23	32	0.8
2.0μF	30	9	19	26.5	0.8	36	14.5	25.5	32	0.8
3.0μF	—	—	—	—	—	36	19.5	32	32	0.8
4.0μF	—	—	—	—	—	36	22	33	32	1.0
4.7μF	36	17	26	31.0	1.0	—	—	—	—	—
8.0μF	36	26	21	31.0	1.0	—	—	—	—	—
8.0μF	36	30	22	31.0	1.0	—	—	—	—	—

典型线路图  
Typical circuit

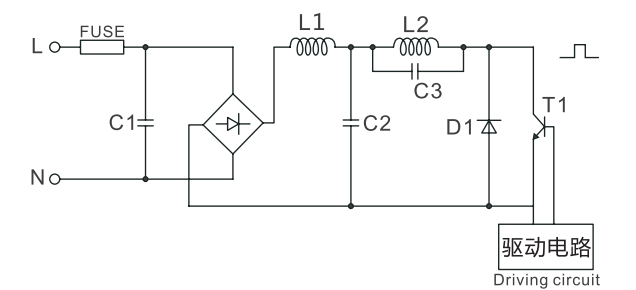

C1:跨线电容  
Across-the-line capacitor

# 安规电容器事业部

## INTERFERENCE SUPPRESSION CAPACITOR DEPARTMENT

主要生产X2抑制电源电磁干扰用固定电容器、盒装化CBB23型金属化聚丙烯膜电容器。在家用电器、电表、电子整流器、开关电源、电动工具等设备的干扰抑制、电火花抑制、阻容降压电路中广泛应用。

Mainly produce X2 type capacitor with safety approvals for Interference Suppression and box CBB23 type metalized polypropylene film capacitors. It is widely used in home appliance, energy meter, electronic ballast, switch model power supply, electrical tool and many other appliance for the purpose of Interference suppression, spark killer and capacitive divider.

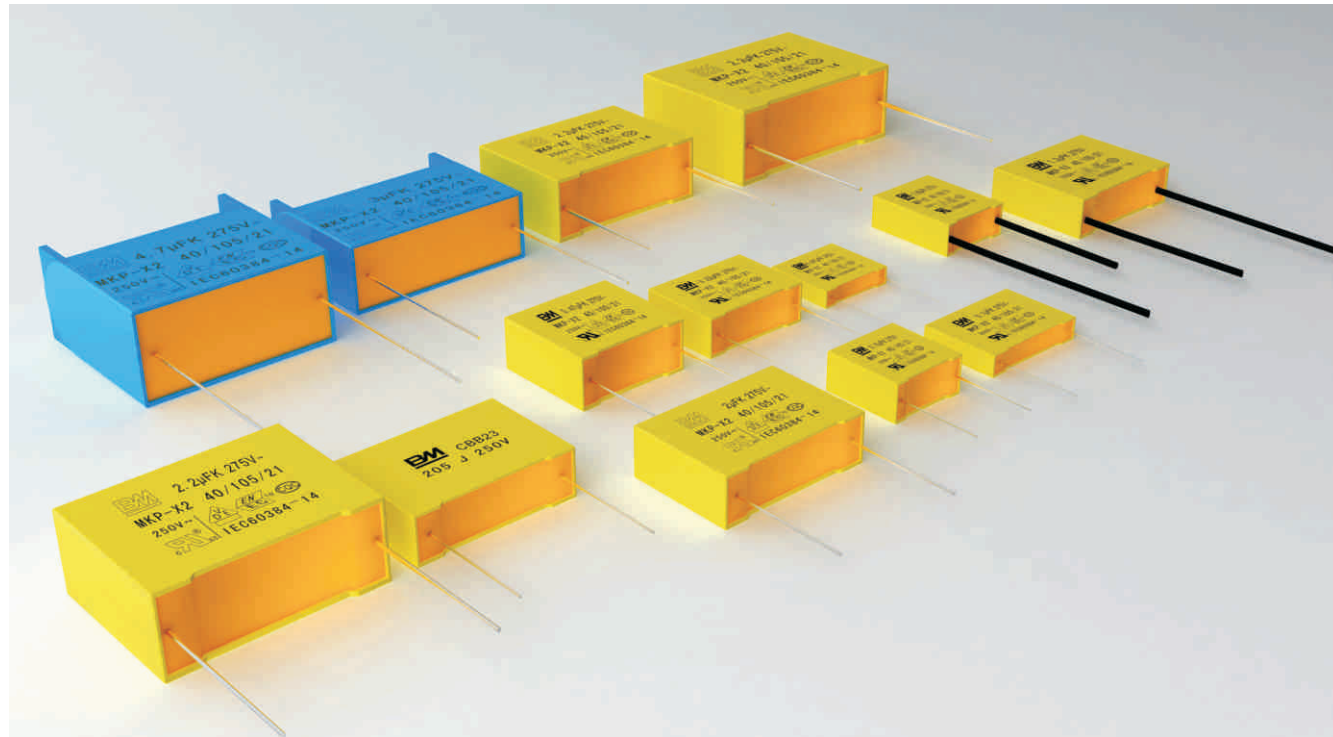

安规电容专用安全性能综合测试仪  
An integrated test of safety properties for interference suppression capacitor



全自动组装机  
Automatic assembly line



激光打标机  
Laser marking machine



自动分选测试机  
Automatic testing and sorting machine



# 抑制电源电磁干扰用安规电容器

## SAFETY APPROVALS CAPACITORS FOR INTERFERENCE SUPPRESSION

# MKP-X2

标准系列X2型产品，多国认证，容量可高达10uF，采用高分子聚丙烯薄膜介质、加厚型金属化电极、全自动喷焊工艺、94V0级阻燃PBT塑壳、环氧树脂密封，耐压高、暂态脉冲电压承受能力强。广泛用于电源并联跨线回路，抑制电磁干扰。

The products of standard series X2 type with safety approvals, Capacitance range up to 10μF. They are made of metalized polymer polypropylene film with forced edge electrode by evaporation full automatic spray-metal process, 94V-0 level flame retardant PBT plastic box and epoxy resin sealed. They are of high voltage proof, withstand transient high impulse voltage, and widely used to across-the-line circuit in power mains for EMI application.

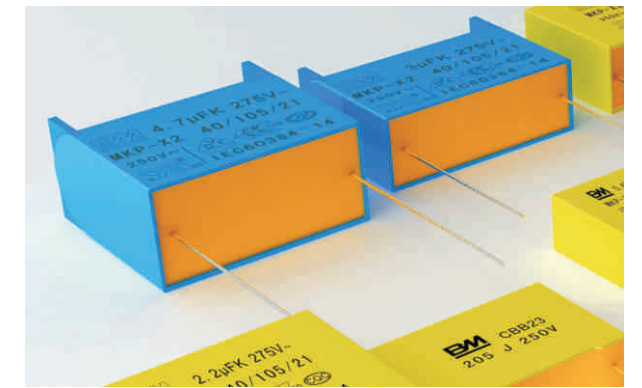

认证标志 Safety approvals	CQC, UL&CUL, VDE&ENEC, KC
执行标准 Implemented standard	GB/T14472-1998, UL60384-14, IEC60384-14
气候类别 Climatic category	40/105/21/C(VDE, ENEC, CQC) 40/110/56/B(UL&CUL)
认证类别 Subclass	X2
额定电压 Rated voltage	250 / 275 / 310VAC (50/60Hz)
容量范围 Capacitance range	0.01μF ~ 10μF
容量偏差 Capacitance tolerance	±5%(J), ±10%(K), ±20%(M)
耐电压 Voltage proof	
极间 between terminals	4.3*U <sub>R</sub> (VDC) / 10s
极壳 between terminals and case	2*U <sub>R</sub> +1500(VAC) / 60s
绝缘电阻 Insulation resistance(20°C)	
极间 between terminals	≥15000MΩ, C <sub>R</sub> ≤0.33μF (100Vdc, 60s) ≥5000S, C <sub>R</sub> >0.33μF (100Vdc, 60s)
极壳 between terminals and case	≥30000MΩ (100Vdc, 60s)
损耗角正切 Tangent of loss angle(20°C)	
0.01μF ≤ C <sub>R</sub> ≤ 0.47μF	≤0.002(10KHz)
0.47μF < C <sub>R</sub> ≤ 1μF	≤0.001(1KHz); ≤0.007(10KHz)
C <sub>R</sub> > 1μF	≤0.002(1KHz)
电压爬升率 Pulse rise time(dv/dt)	100V/μs Max

### 常用规格 Dimension Unit : mm

Rated Cap.	L	W	H	P	ΦD
0.010μF	13.0	5.0	11.0	10.0	0.6
0.022μF	13.0	5.0	11.0	10.0	0.6
0.033μF	13.0	5.0	11.0	10.0	0.6
0.047μF	13.0	5.0	11.0	10.0	0.6
0.10μF	13.0	6.0	12.0	10.0	0.6
0.047μF	18.0	5.0	11.0	15.0	0.8
0.10μF	18.0	6.0	12.0	15.0	0.8
0.22μF	18.0	7.5	13.5	15.0	0.8
0.33μF	18.0	8.5	14.5	15.0	0.8
0.47μF	18.0	10.0	18.0	15.0	0.8
0.47μF	26.3	8.5	17.0	22.5	0.8
0.68μF	26.3	10.0	19.0	22.5	0.8
1.0μF	26.3	11.0	20.0	22.5	0.8
1.0μF	31.0	9.0	18.0	27.5	0.8
1.2μF	31.5	10.8	19.5	27.5	0.8
2.2μF	31.5	15.0	30.0	27.5	0.8
3.3μF	31.5	18.0	33.0	27.5	0.8
4.7μF	41.0	18.0	33.5	37.5	1.0
6.8μF	41.0	22.0	37.0	37.5	1.0
10.0μF	41.0	28.0	43.0	37.5	1.0

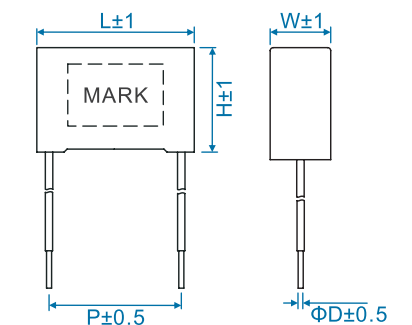
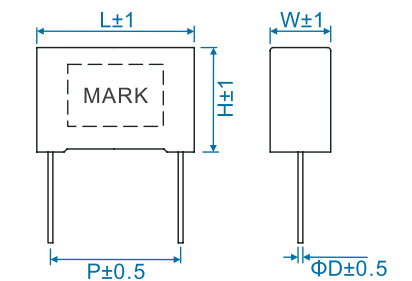

典型线路图  
Typical circuit

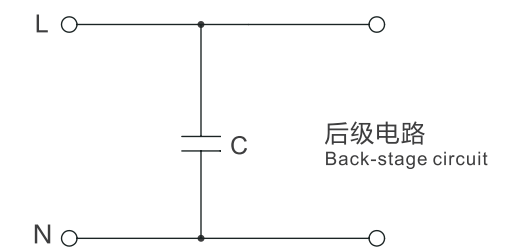

C: 抗电磁干扰电容  
Interference suppression capacitor

# 阻容降压专用交流安规电容器

SAFETY APPROVALS CAPACITORS FOR CAPACITIVE DIVIDER

# MKP-X2

优化系列X2认证型, 采用高分子聚丙烯薄膜介质、加厚型金属化电极、全自动喷焊工艺, 94V0级阻燃PBT塑壳、耐湿热环氧树脂密封、CP线引出。高耐压、耐湿热、低容降, 专用于阻容降压电路, 如LED驱动模块、电表、小家电等低功率电子消费产品。

The products of Optimization series X2 type with safety approvals, are made of metalized polymer polypropylene film with forced edge electrode by evaporation, full automatic spray-metal process, 94V0 level flame retardant PBT plastic box, and epoxy resin sealed, welded with CP wires. They are of high voltage proof, low capacitance decreasing, uniform dimensions, take place of powder coating capacitor, and they are applied to the 110-240VAC capacitive divider circuit, such as LED driver, energy meter, household appliance etc.

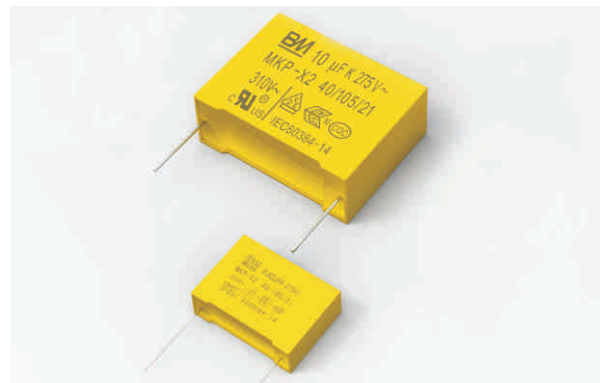

认证标志 Safety approvals	CQC, UL&CUL, VDE&ENEC, KC
执行标准 Implemented standard	GB/T14472-1998, UL60384-14 IEC60384-14
气候类别 Climatic category	40/105/21(VDE, ENEC, CQC) 40/110/56/B (UL&CUL)
认证类别 Subclass	X2
额定电压 Rated voltage	250 / 275 / 310VAC (50/60Hz)
容量范围 Capacitance range	0.22μF ~ 3.3μF
容量偏差 Capacitance tolerance	±5%(J), ±10%(K)
耐电压 Voltage proof	
极间 between terminals	4.3*U <sub>R</sub> (VDC)/10s
极壳 between terminals and case	2*U <sub>R</sub> +1500(VAC) / 60s(2000VAC min)
绝缘电阻 Insulation resistance(20°C)	
极间 between terminals	≥15000MΩ, C <sub>R</sub> ≤0.33μF (100Vdc, 60s)
极壳 between terminals and case	≥5000S, C <sub>R</sub> >0.33μF (100Vdc, 60s)
损耗角正切 Tangent of loss angle(20°C)	
C <sub>R</sub> ≤1μF	≤0.001(1KHz); ≤0.003(10KHz)
C <sub>R</sub> >1μF	≤0.002(1KHz)
电压爬升率 Pulse rise time(dv/dt)	100V/μs Max

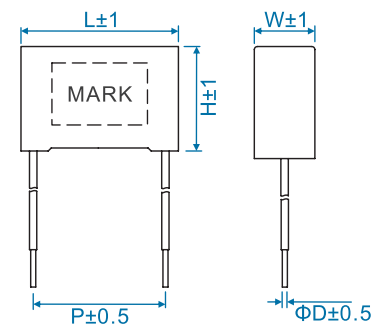
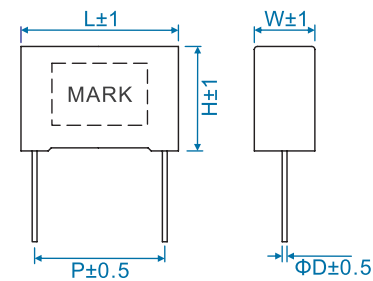

典型线路图  
Typical circuit

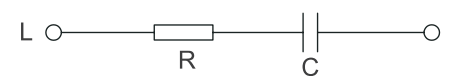

后级电路  
Back-stage circuit



C: 降压电容  
Capacitor divider

常用规格 Dimension						Unit : mm
Rated Cap.	L	W	H	P	Φd	
250VDC(125VAC)						
0.22μF	18.0	8.5	14.5	15.0	0.8	
0.33μF	18.0	10.0	15.8	15.0	0.8	
0.47μF	18.0	11.2	19.2	15.0	0.8	
400VDC(220VAC)						
0.22μF	26.3	7.0	16.5	22.5	0.8	
0.33μF	26.3	8.5	17.0	22.5	0.8	
0.47μF	26.3	10.0	19.0	22.5	0.8	
0.68μF	26.3	10.0	19.0	22.5	0.8	
0.82μF	26.3	11.0	20.0	22.5	0.8	
1.0μF	26.3	13.0	23.0	22.5	0.8	
0.47μF	31.0	9.0	18.0	27.5	0.8	
0.68μF	31.5	10.8	19.5	27.5	0.8	
630VDC(250VAC)						
0.47μF	26.3	8.5	17.0	22.5	0.8	
0.68μF	26.3	10.0	19.0	22.5	0.8	
1.0μF	26.3	13.0	23.0	22.5	0.8	
1.0μF	31.5	10.8	21.6	27.5	0.8	
1.2μF	31.5	13.0	21.6	27.5	0.8	
1.5μF	31.5	14.0	25.0	27.5	0.8	
1.8μF	32.0	16.0	25.5	27.5	0.8	
2.0μF	32.0	15.0	30.0	27.5	0.8	
2.2μF	32.0	15.0	30.0	27.5	0.8	



# 阻容降压用盒装化金属化聚丙烯薄膜电容器

BOXED CAPACITORS FOR CAPACITIVE DIVIDER

# CBB23

非认证型, 采用聚丙烯薄膜介质、阻燃塑壳、环氧树脂密封, CP线引出。高性价比、低容降、外观一致, 可替换包封电容, 适用于110~240VAC阻容降压电路。

The products without safety approvals, are made of metalized polypropylene films, flame retardant plastic box, and sealed with epoxy resin, welded with CP wire. They are of high cost performance, low capacitance decreasing, uniform dimensions, take place of powder coating capacitor, and they are applied to the 110-240VAC capacitive divider circuit.



引用标准 Reference standard	GB/T14579, IEC60384-17
气候类别 Climatic category	40 / 105 / 21
额定电压 Rated voltage	250VDC(125VAC), 400VDC(220VAC) 630VDC(250VAC)
额定温度 Rated temperature	85°C Max
容量范围 Capacitance range	0.22μF ~ 3.3μF
容量偏差 Capacitance tolerance	±5%(J), ±10%(K)
耐电压 Voltage proof	
极间 between terminals	1.6*U <sub>R</sub> (VDC) / 10s
极壳 between terminals and case	2*U <sub>R</sub> +1500(VAC) / 60s(2000VAC min)
绝缘电阻 Insulation resistance(20°C)	
极间 between terminals	≥30000MΩ, C <sub>R</sub> ≤0.33μF (100Vdc, 60s) ≥7500S, C <sub>R</sub> >0.33μF (100Vdc, 60s)
极壳 between terminals and case	≥30000MΩ (100Vdc, 60s)
损耗角正切 Tangent of loss angle(20°C)	
C <sub>R</sub> ≤1μF	≤0.001(1KHz); ≤0.003(10KHz)
C <sub>R</sub> >1μF	≤0.002(1KHz)
电压爬升率 Pulse rise time(dv/dt)	60V/μs Max

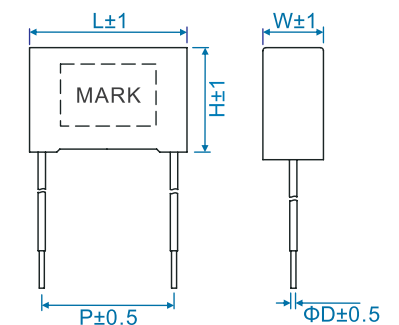
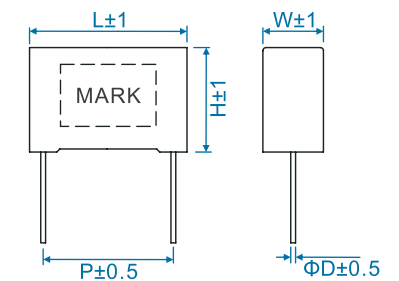

## 常用规格 Dimension

Unit : mm

Rated Cap.	L	W	H	P	Φd
250VDC(125VAC)					
1.0μF	26.3	7.0	16.5	22.5	0.8
1.2μF	26.3	7.0	16.5	22.5	0.8
1.5μF	26.5	8.5	17.0	22.5	0.8
400VDC(220VAC)					
0.47μF	18.0	8.5	14.5	15.0	0.8
0.68μF	18.0	10.0	18.0	15.0	0.8
1.0μF	26.3	8.5	17.0	22.5	0.8
1.2μF	26.3	10.0	19.0	22.5	0.8
1.5μF	18.0	11.0	20.0	22.5	0.8
2.0μF	31.5	10.8	19.5	27.5	0.8
2.2μF	31.5	13.0	21.6	27.5	0.8
630VDC(250VAC)					
0.47μF	26.3	8.5	17.0	22.5	0.8
0.68μF	26.3	10.0	19.0	22.5	0.8
1.0μF	26.3	13.0	23.0	22.5	0.8
1.0μF	31.5	10.8	21.6	27.5	0.8
1.2μF	31.5	13.0	21.6	27.5	0.8
1.5μF	31.5	14.0	25.0	27.5	0.8
2.2μF	31.5	15.0	30.0	27.5	0.8

典型线路图  
Typical circuit

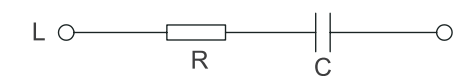

后级电路  
Back-stage circuit



C: 降压电容  
Capacitor divider

# 包封电容器事业部

## POWDER COATING CAPACITOR DEPARTMENT

主要产品有粉末包封电容器、轴向电容器。在各类家用电器、音响、通讯、灯具等设备的直流脉动、脉冲、交流降压、滤波、谐振、点火等电路中广泛应用。

Mainly produce powder coating capacitor, axial capacitor. It's widely used in the circuit of DC pulse, impulse, capacitive divider, filtering, resonance, ignition in various home appliance, audio, communication, lighting and many other appliances.

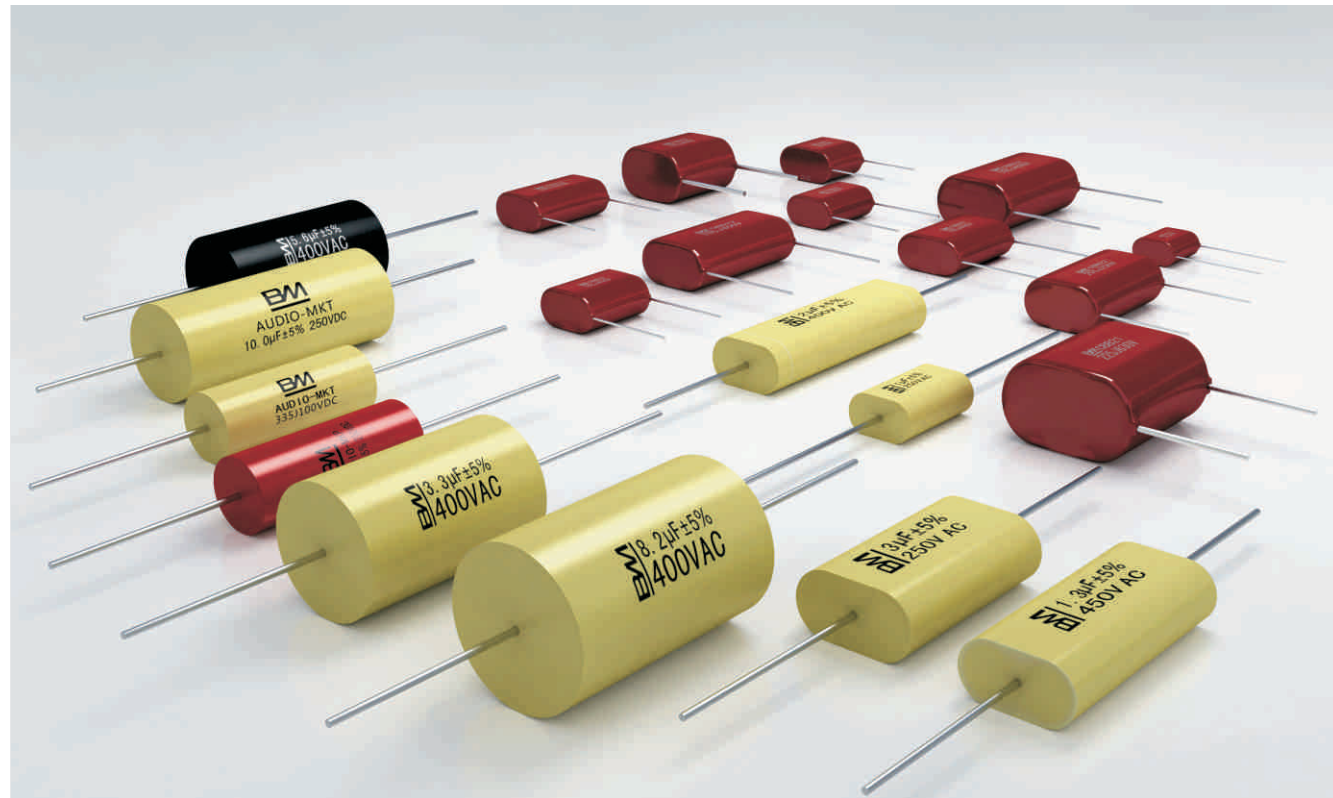

自动包封机  
Automatic over-wrapping machine

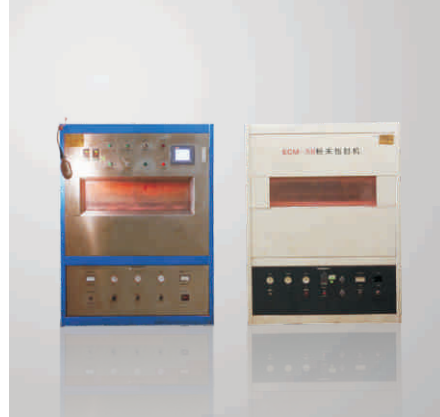

自动编带机  
Automatic taping machine

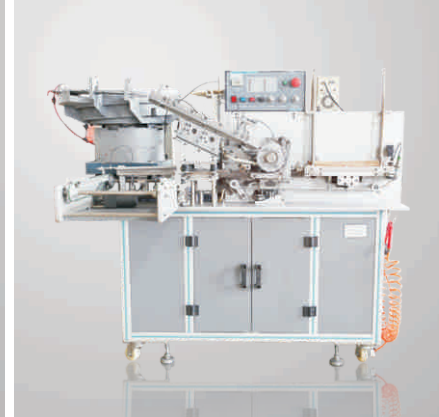

自动轴向焊接机  
Automatic axial welding machine



# 金属化聚丙烯薄膜电容器

## METALIZED POLYPROPYLENE FILM CAPACITOR

# CBB21

通用型，采用金属化聚丙烯薄膜无感式卷绕、阻燃环氧粉末包封、镀锡铜线引出，具有防潮能力强、自愈性好、高绝缘、低损耗、低温升等特点。

The general products are wound non-inductive elements by metalized polypropylene film, coated with flame retardant epoxy powder, welded by tinned copper wire. They have the characteristics of good moisture-resistance, good self-healing, high insulation, low dissipation factor, low temperature-rising, etc.

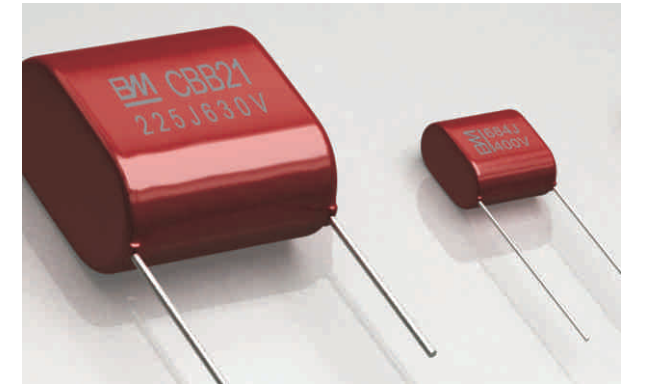

引用标准 Reference standard	GB10190 IEC 60384-16
气候类别 Climatic category	40 / 85 / 21
额定电压 Rated voltage	250VDC ~ 630VDC
容量范围 Capacitance range	0.1μF ~ 10μF
容量偏差 Capacitance tolerance	±5%(J), ±10%(K)
耐电压 Voltage proof	
极间 between terminals	1.6*U <sub>r</sub> (VDC)/10S
绝缘电阻 Insulation resistance(20°C)	
极间 between terminals	≥30000MΩ, C <sub>R</sub> ≤0.33μF (100Vdc, 60s) ≥7500S, C <sub>R</sub> >0.33μF (100Vdc, 60s)
极壳 between terminals and case	≥100000MΩ (100Vdc, 60s)
损耗角正切 Tangent of loss angle(20°C)	≤0.002 (1KHz)

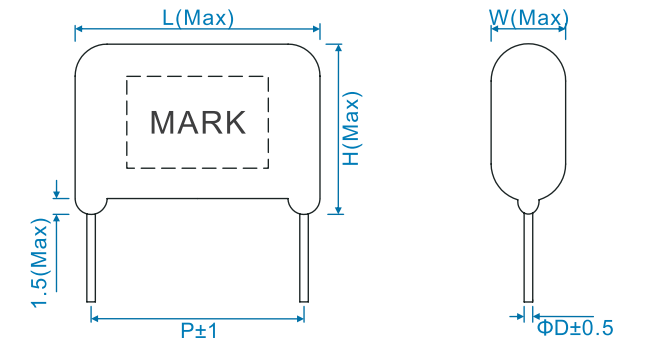

### 常用规格 Dimension Unit : mm

Rated Cap.	250/275VDC					400VDC					630VDC				
	L	W	H	P	ΦD	L	W	H	P	ΦD	L	W	H	P	ΦD
0.10μF	18	6.5	12.5	15.0	0.8	18	6.5	12.5	15.0	0.8	18	6.5	12.5	15.0	0.8
0.22μF	18	6.5	12.5	15.0	0.8	18	6.5	12.5	15.0	0.8	18	9.5	15.5	15.0	0.8
0.33μF	18	6.5	12.5	15.0	0.8	18	7.5	14	15.0	0.8	23	8.5	15	20.0	0.8
0.47μF	23	7.0	14.5	20.0	0.8	23	7.0	14.5	20.0	0.8	23	9.5	17.5	20.0	0.8
0.68μF	23	8.0	16	20.0	0.8	23	8.0	16	20.0	0.8	23	11.5	19	20.0	0.8
0.82μF	23	7.0	14.5	20.0	0.8	23	9.0	16.5	20.0	0.8	23	12.5	20	20.0	0.8
1.0μF	24	7.5	15.5	20.0	0.8	24	10	17.5	20.0	0.8	24	14	21.5	20.0	0.8
1.2μF	24	8.5	16.0	20.0	0.8	24	11	18.5	20.0	0.8	29.5	13	21	26.0	0.8
1.5μF	24	9.5	17.0	20.0	0.8	24	12	20	20.0	0.8	29.5	14.5	22	26.0	0.8
2.0μF	24	10.5	18.5	20.0	0.8	24	14	22	20.0	0.8	29.5	17	25	26.0	0.8
2.2μF	24	11.5	19.0	20.0	0.8	29.5	12.5	20	26.0	0.8	29.5	18	25.5	26.0	0.8
2.5μF	24	12	20.0	20.0	0.8	29.5	13	21	26.0	0.8	29.5	19	27	26.0	0.8
3.0μF	24	13.5	21.0	20.0	0.8	29.5	14.5	22	26.0	0.8	35	18.5	26.5	31.0	0.8
3.3μF	24	14	21.5	20.0	0.8	29.5	15	23	26.0	0.8	35	19.5	27.5	31.0	0.8

典型线路图  
Typical circuit

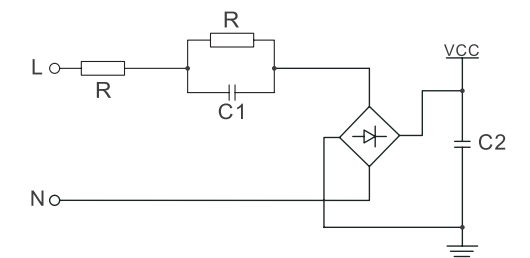

C: 降压电容  
Capacitive divider

# 金属化聚丙烯薄膜电容器

## METALIZED POLYPROPYLENE FILM CAPACITOR

# CBB22

采用金属化聚丙烯薄膜无感式卷绕、阻燃环氧粉末包封、镀锡铜线引出，具有防潮能力强、自愈性好、高绝缘、低损耗等特点。适用于LED灯、点火及高频电路中。

The products are wound non-inductive elements by metalized polypropylene film, enveloped with flame retardant epoxy powder, welded by tinned copper wire. They have the characteristics of good moisture-resistance, good self-healing, high insulation, low dissipation factor etc. And applied to LED light, ignition and resonance circuit.

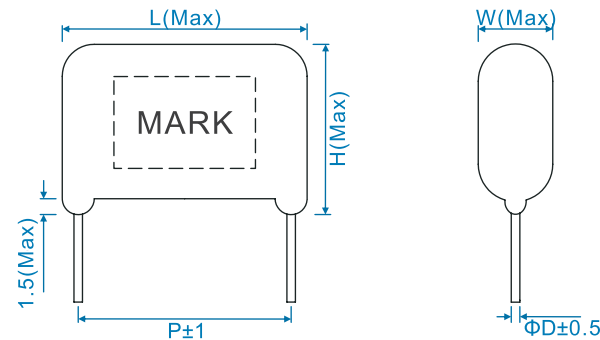
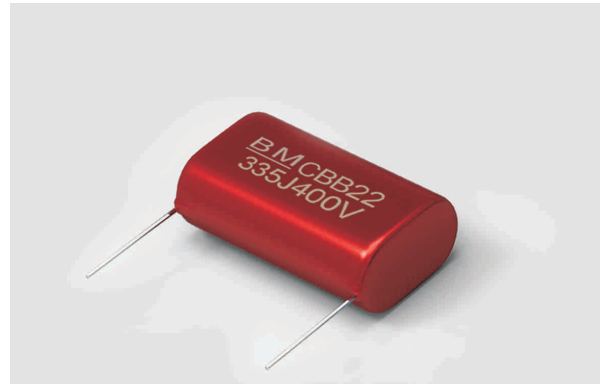

引用标准 Reference standard	GB10190、IEC 60384-16
气候类别 Climatic category	40 / 85 / 21
额定电压 Rated voltage	250VDC ~ 630VDC
容量范围 Capacitance range	0.1μF ~ 10μF
容量偏差 Capacitance tolerance	±5%(J)、±10%(K)
耐电压 Voltage proof	
极间 between terminals	1.6*U <sub>R</sub> (VDC) / 10s
绝缘电阻 Insulation resistance(20°C)	
极间 between terminals	≥30000MΩ, C <sub>R</sub> ≤0.33μF (100Vdc,60s) ≥7500S, C <sub>R</sub> >0.33μF (100Vdc,60s)
极壳 between terminals and case	≥100000MΩ (100Vdc,60s)
损耗角正切 Tangent of loss angle(20°C)	≤0.002 (1KHz)

常用规格 Dimension		Unit : mm																		
Rated Cap.	L	W	H	P	ΦD	250/275VDC					400VDC					630VDC				
						L	W	H	P	ΦD	L	W	H	P	ΦD	L	W	H	P	ΦD
0.10μF	18	6.5	12.5	15.0	0.8	18	6.5	12.5	15.0	0.8	18	6.5	12.5	15.0	0.8	18	6.5	12.5	15.0	0.8
0.15μF	18	6.5	12.5	15.0	0.8	18	6.5	12.5	15.0	0.8	18	7.5	14.0	15.0	0.8	18	6.5	12.5	15.0	0.8
0.22μF	18	6.5	12.5	15.0	0.8	18	6.5	12.5	15.0	0.8	18	9.5	15.0	20.0	0.8	18	6.5	12.5	15.0	0.8
0.47μF	23	7.0	14.5	20.0	0.8	23	7.0	14.5	20.0	0.8	23	9.5	17.5	20.0	0.8	23	7.0	14.5	20.0	0.8
0.56μF	23	7.5	15	20.0	0.8	23	7.5	15	20.0	0.8	23	10.5	18	20.0	0.8	23	7.5	15	20.0	0.8
0.68μF	23	8.0	16	20.0	0.8	23	8.0	16	20.0	0.8	23	11.5	19	20.0	0.8	23	8.0	16	20.0	0.8
0.82μF	24	7.0	14.5	20.0	0.8	23	9.0	16.5	20.0	0.8	23	12.5	20	20.0	0.8	23	7.0	14.5	20.0	0.8
1.0μF	24	7.5	15.5	20.0	0.8	23	10	17.5	20.0	0.8	23	14	21.5	20.0	0.8	23	7.5	15.5	20.0	0.8
1.2μF	24	8.5	16.0	20.0	0.8	23	11	18.5	20.0	0.8	29.5	13	21	26.0	0.8	23	8.5	16.0	20.0	0.8
1.5μF	24	9.5	17.0	20.0	0.8	23	12	20	20.0	0.8	29.5	14.5	22	26.0	0.8	23	9.5	17.0	20.0	0.8
2.0μF	24	10.5	18.5	20.0	0.8	23	14	22	20.0	0.8	29.5	17	25	26.0	0.8	23	10.5	18.5	20.0	0.8
2.5μF	24	12	20.0	20.0	0.8	29.5	13	21	26.0	0.8	29.5	19	27	26.0	0.8	29.5	12	20.0	20.0	0.8
3.0μF	24	13.5	21.0	20.0	0.8	29.5	14.5	22	26.0	0.8	35	18.5	26.5	31.0	0.8	29.5	13.5	21.0	20.0	0.8
3.5μF	24	14	21.5	20.0	0.8	29.5	15	23	26.0	0.8	35	20.5	28.0	31.0	0.8	29.5	14	21.5	20.0	0.8

典型线路图  
Typical circuit

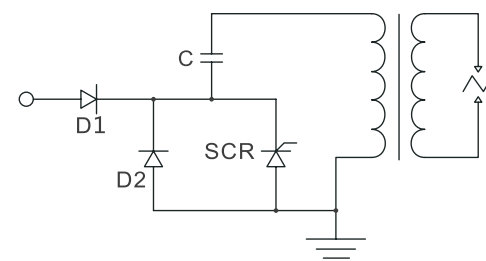

C:点火电容  
Ignition capacitor

# 金属化聚丙烯膜、箔电容器

## METALIZED POLYPROPYLENE FILM AND FOIL CAPACITOR

# CBB81

采用聚丙烯膜和铝箔无感式卷绕、阻燃环氧粉末包封、镀锡铜线引出，具有高耐压、高绝缘、耐冲击、低损耗、低温升等特点。适用于高压、脉冲、点火、谐振电路中。

The products are wound non-inductive elements by metalized polypropylene film and aluminum foil, coated with flame retardant epoxy powder, welded by tinned copper wire. They have the characteristics of high voltage proof, high insulation, low dissipation factor, withstanding surge voltage stressing, low temperature-rising, etc. It's used in the high voltage, impulse, ignition, resonance circuit.

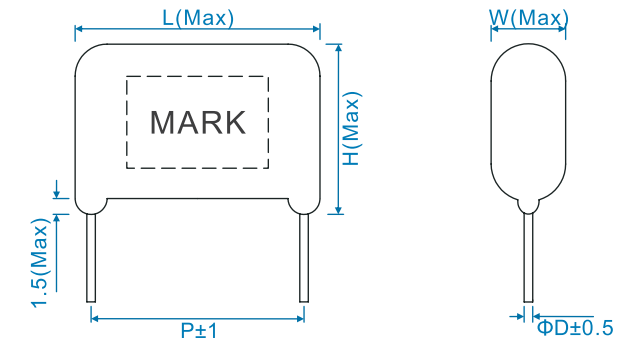
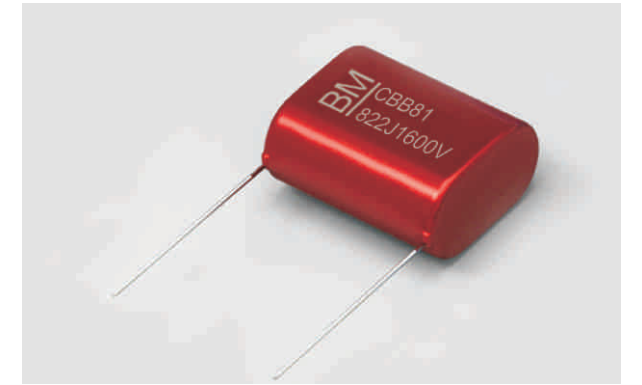

引用标准 Reference standard	GB/T14579、IEC 60384-17
气候类别 Climatic category	40 / 85 / 21
额定电压 Rated voltage	1000VDC ~ 3000VDC
容量范围 Capacitance range	0.0022μF ~ 1μF
容量偏差 Capacitance tolerance	±5%(J)、±10%(K)
耐电压 Voltage proof	
极间 between terminals	2.5*U <sub>R</sub> (VDC)/10s
绝缘电阻 Insulation resistance(20°C)	
极间 between terminals	≥30000MΩ, C <sub>R</sub> ≤0.33μF (100Vdc,60s) ≥7500S, C <sub>R</sub> >0.33μF (100Vdc,60s)
极壳 between terminals and case	≥100000MΩ (100Vdc,60s)
损耗角正切 Tangent of loss angle(20°C)	≤0.001 (10KHz)

常用规格 Dimension		Unit : mm																		
Rated Cap.	L	W	H	P	ΦD	1000VDC					1600VDC					2000VDC				
						L	W	H	P	ΦD	L	W	H	P	ΦD	L	W	H	P	ΦD
0.0022μF	18	6.5	12.5	15.0	0.8	18	6.5	12.5	15.0	0.8	18	7.0	12.5	15.0	0.8	18	6.5	12.5	15.0	0.8
0.0047μF	18	9.0	14.5	15.0	0.8	18	6.5	12.5	15.0	0.8	18	9.5	15	15.0	0.8	18	6.5	12.5	15.0	0.8
0.0056μF	18	8.5	14.0	15.0	0.8	18	8.5	14.0	15.0	0.8	25	8.0	13.5	22.0	0.8	18	8.5	14.0	15.0	0.8
0.0068μF	18	7.5	13.5	15.0	0.8	18	7.5	13.5	15.0	0.8	25	8.5	14.0	22.0	0.8	18	7.5	13.5	15.0	0.8
0.0082μF	18	8.5	14.0	15.0	0.8	18	8.5	14.0	15.0	0.8	25	9.0	15.0	22.0	0.8	18	8.5	14.0	15.0	0.8
0.010μF	18	7.0	12.0	15.0	0.8	18	8.0	12.0	15.0	0.8	25	11	16.5	22.0	0.8	18	7.0	12.0	15.0	0.8
0.015μF	18	10	15.5	15.0	0.8	18	10	15.5	15.0	0.8	25	8.5	14.0	22.0	0.8	18	10	15.5	15.0	0.8
0.020μF	18	10	17.0	15.0	0.8	18	10	17.0	15.0	0.8	25	9.0	16.0	22.0	0.8	18	10	17.0	15.0	0.8
0.022μF	18	10.5	17.5	15.0	0.8	18	10.5	17.5	15.0	0.8	25	10	15.5	22.0	0.8	18	10.5	17.5	15.0	0.8
0.024μF	18	10.5	18.0	15.0	0.8	18	10.5	18.0	15.0	0.8	25	9.5	17	22.0	0.8	18	10.5	18.0	15.0	0.8
0.027μF	25	8.0	15.5	22.0	0.8	25	8.0	15.5	22.0	0.8	25	10	17.5	22.0	0.8	25	8.0	15.5	22.0	0.8
0.030μF	25	8.5	15.5	22.0	0.8	25	8.5	15.5	22.0	0.8	25	11	18.5	22.0	0.8	25	8.5	15.5	22.0	0.8
0.039μF	25	9.5	16.5	22.0	0.8	25	9.5	16.5	22.0	0.8	25	12.5	20	22.0	0.8	25	9.5	16.5	22.0	0.8
0.10μF	34	11.5	19.0	31.0	0.8	34	11.5	19.0	31.0	0.8	34	21.5	29	31.0	0.8	34	11.5	19.0	31.0	0.8

典型线路图  
Typical circuit

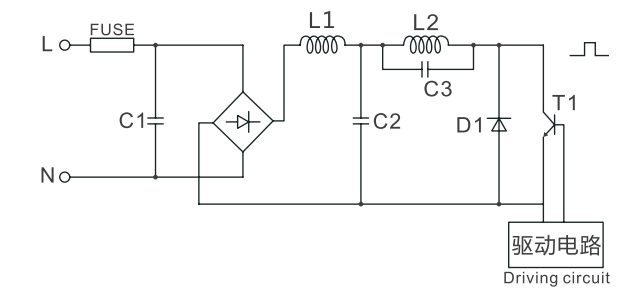

C1:跨线电容  
Across-the-line capacitor

# 金属化聚丙烯薄膜扁形轴向电容器

## METALIZED POLYPROPYLENE AXIAL FLAT TYPE CAPACITOR

### CBB20

采用金属化聚丙烯薄膜无感式卷绕、迈拉胶带封装、镀锡铜线轴向引出，具有体积小、高绝缘、低损耗、低温升、便于安装等特点。适用于电源、音响分频等

The products are wound non-inductive elements by metalized polypropylene film, wrapped with adhesive PET tape, axially welded by tinned copper wire. They have the characteristics of small size, high insulation, low dissipation factor, low temperature rising, easy installation, etc. And used in all kinds of filter, suppression noise and low impulse circuit.

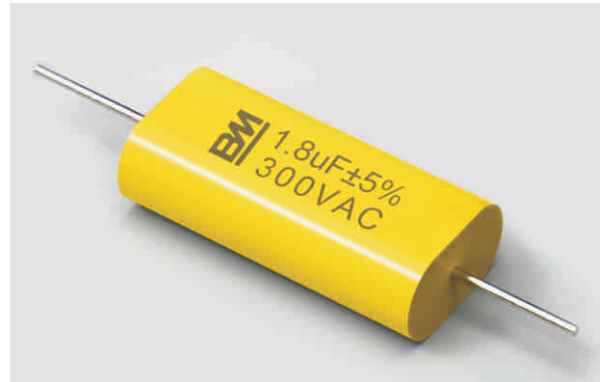

引用标准 Reference standard	GB10190、IEC 60384-16
气候类别 Climatic category	40 / 85 / 21
额定电压 Rated voltage	250VDC ~ 630VDC
容量范围 Capacitance range	1μF ~ 40μF
容量偏差 Capacitance tolerance	±5%(J)、±10%(K)
耐电压 Voltage proof	
极间 between terminals	1.6*U <sub>R</sub> (VDC) / 10s
绝缘电阻 Insulation resistance(20°C)	
极间 between terminals	≥30000MΩ, C <sub>R</sub> ≤0.33μF (100Vdc, 60s) ≥7500S, C <sub>R</sub> >0.33μF (100Vdc, 60s)
极壳 between terminals and case	≥100000MΩ (100Vdc, 60s)
损耗角正切 Tangent of loss angle(20°C)	≤0.002(1KHz)

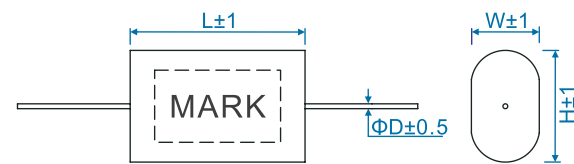

常用规格 Dimension		Unit : mm											
Rated Cap.	250/275VDC				400VDC				630VDC				
	L	W	H	ΦD	L	W	H	ΦD	L	W	H	ΦD	
1.0μF	25	5.0	12	0.8	25	8.0	14	0.8	25	11.5	19	0.8	
1.2μF	25	6.5	13	0.8	25	9.0	15	0.8	25	13.5	19	0.8	
1.5μF	25	7.5	14	0.8	25	10	16.5	0.8	25	14.5	22	0.8	
2.0μF	25	9.0	15.5	0.8	25	12	18.5	0.8	25	14	22	0.8	
2.2μF	26	9.5	15.5	0.8	25	13	19	0.8	31	16	22.5	0.8	
2.5μF	26	10.0	16.5	0.8	25	14	20	0.8	31	17	23.5	0.8	
3.3μF	26	12	18	0.8	31	13	19.5	0.8	31	20	26.5	0.8	
3.5μF	26	12.5	18.5	0.8	31	13.5	20	0.8	36	18.5	24	0.8	
4.0μF	26	13.5	19.5	0.8	31	15	21	0.8	36	19.5	26	0.8	
4.7μF	26	14.5	21	0.8	31	16	22.5	0.8	36	21.5	28	0.8	
5.6μF	31	14	20	0.8	31	18	24	0.8	36	24	30	0.8	
6.8μF	31	15.5	21.5	0.8	31	20	26.5	0.8	46	22	28	0.8	
8.2μF	31	17	23.5	0.8	36	19.5	26	0.8	46	24.5	30	0.8	
10.0μF	31	19.5	25.5	1.0	36	22	28.5	1.0	46	26.5	33	1.0	

典型线路图  
Typical circuit

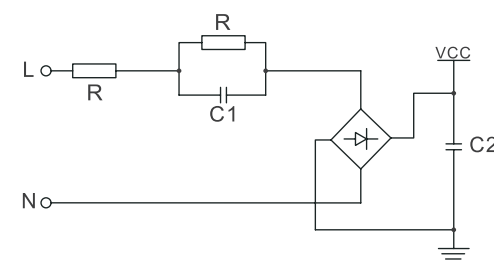

C2:滤波电容  
Filter capacitor

# 金属化聚丙烯薄膜圆形轴向电容器

## METALIZED POLYPROPYLENE AXIAL ROUND TYPE CAPACITOR

### CBB20

采用金属化聚丙烯薄膜无感式卷绕、迈拉胶带封装、镀锡铜线轴向引出，具有体积小、高绝缘、低损耗、低温升、便于安装等特点。适用于电源、音响分频等各种滤波、降噪和低脉冲电路中。

The products are wound non-inductive by metalized polypropylene film, wrapped with adhesive PET tape, axially welded by tinned copper wire. They have the characteristics of small size, good insulation, low dissipation factor, low temperature rising, easy installation, etc. And used in all kinds of filter, suppression noise and low impulse circuit.

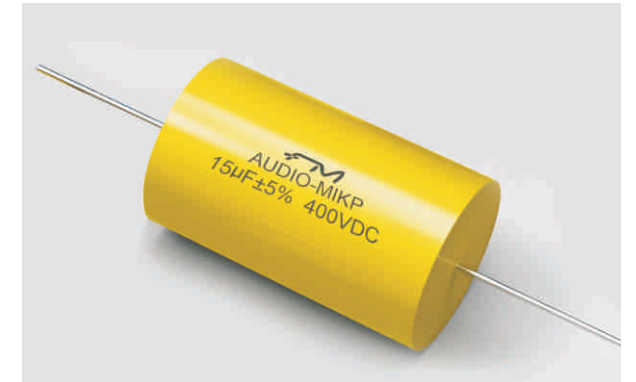

引用标准 Reference standard	GB10190、IEC 60384-16
气候类别 Climatic category	40 / 85 / 21
额定电压 Rated voltage	250VDC ~ 630VDC
容量范围 Capacitance range	1μF ~ 40μF
容量偏差 Capacitance tolerance	±5%(J)、±10%(K)
耐电压 Voltage proof	
极间 between terminals	1.6*U <sub>R</sub> (VDC)/10S
绝缘电阻 Insulation resistance(20°C)	
极间 between terminals	≥30000MΩ, C <sub>R</sub> ≤0.33μF (100Vdc, 60s) ≥7500S, C <sub>R</sub> >0.33μF (100Vdc, 60s)
极壳 between terminals and case	≥100000MΩ (100Vdc, 60s)
损耗角正切 Tangent of loss angle(20°C)	≤0.002 (1KHz)

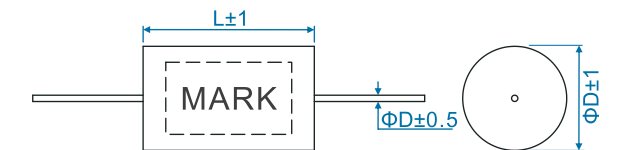

常用规格 Dimension		Unit : mm								
Rated cap.	250 / 275VDC			400VDC			630VDC			
	L	D	ΦD	L	D	ΦD	L	D	ΦD	
1.0μF	26	9.5	0.8	26	11.5	0.8	26	16	0.8	
1.2μF	26	10.5	0.8	26	13	0.8	25	17.5	0.8	
1.5μF	26	11.5	0.8	25	14	0.8	31	17	0.8	
2.0μF	26	13	0.8	25	16	0.8	31	19.5	0.8	
2.2μF	26	13.5	0.8	25	17	0.8	31	20	0.8	
2.5μF	26	14	0.8	25	18	0.8	31	21	0.8	
3.0μF	26	15.5	0.8	31	16.5	0.8	31	23	0.8	
3.5μF	26	16.5	0.8	31	17.5	0.8	36	22.5	0.8	
4.0μF	26	17.5	0.8	31	19	0.8	36	23.5	0.8	
4.7μF	26	18.5	0.8	31	20	0.8	36	25.5	0.8	
5.6μF	31	18	0.8	31	22	0.8	36	28	0.8	
6.8μF	31	19.5	0.8	31	24	0.8	46	26	0.8	
8.2μF	31	21	0.8	36	23.5	0.8	46*	28.5	0.8	
10.0μF	31	23.5	1.0	36	26	1.0	46	30.5	1.0	

典型线路图  
Typical circuit

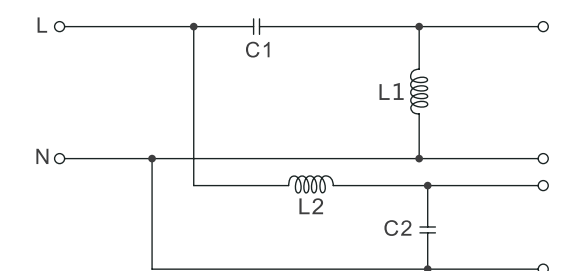

C1, C2:分频电容  
Audio frequency division capacitor

# 工业电容器事业部 INDUSTRIAL CAPACITOR DEPARTMENT

主要产品有DC-LINK电容、滤波电容、缓冲吸收电容、谐振电容、耦合隔直电容、交流滤波电容等。在风电、光伏、焊机、变频器、开关电源、电镀电源、UPS、感应加热设备等各类电力电子设备中广泛应用。

Mainly produce DC-Link capacitor, filter capacitor, snubber capacitor, resonance capacitor, coupling capacitor and so on. It's widely used in wind power, solar power, welding machine, frequency converter, switching power supply, plating power supply, UPS, induction heating machine and other kinds of electronic equipments.



十万级净化卷绕车间  
Purification winding workshop



全自动混胶机  
Automatic rubber mixing machine



全自动卷绕机  
Automatic winding machine



全自动喷金机  
Automatic spraying machine



# DC-LINK电容器 圆形铝外壳式系列 DC-LINK CAPACITOR CIRCLE ALUMINUM CASE SERIES

## MKP-L

采用耐温型金属化聚丙烯薄膜结构，铝制外壳、阻燃环氧树脂封装。具有散热快、安装方便、承受纹波电流能力强、耐压高、寿命长等特点。广泛应用于风电、光伏、焊机、变频器、开关电源、电镀电源及UPS等各类电力电子设备直流环节部分中作直流支撑、储能滤波电容使用。

The products are made of temperature-resistant metalized polypropylene film, and enveloped with aluminum case and flame-resistant epoxy resin. They have the characteristics of fast heat dissipation, easy installation, high ripple current, high voltage, long lifetime, etc. Widely used in wind power, solar power, welding machine, frequency converter, switch power supply, plating power supply, UPS and other kinds of electronic equipments DC link part for DC support, energy storage and filter.



引用标准 Reference standard	GB/T 17702, IEC 61071
气候类别 Climatic category	40/85/21
额定电压 Rated voltage	400VDC~2000VDC
容量范围 Capacitance range	50 $\mu$ F~1000 $\mu$ F
容量偏差 Capacitance tolerance	$\pm 5\%$ (J), $\pm 10\%$ (K)
耐电压 Voltage proof	
极间 between terminals	1.5*Un(VDC)/60S
极壳 between terminal and case	2*Ui+1000(VAC)/60S
绝缘电阻 Insulation resistance(20°C)	$\geq 5000S(100VDC, 60S)$
电压爬升率 Pulse rise time (dv/dt)	$\geq 10V/\mu S$

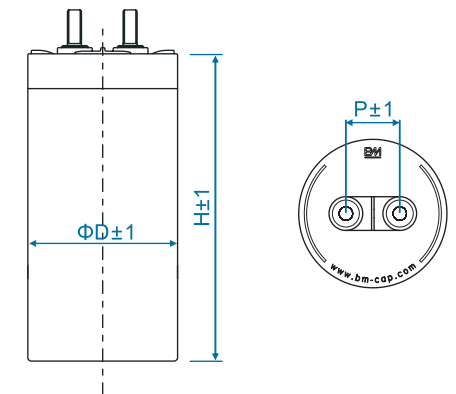
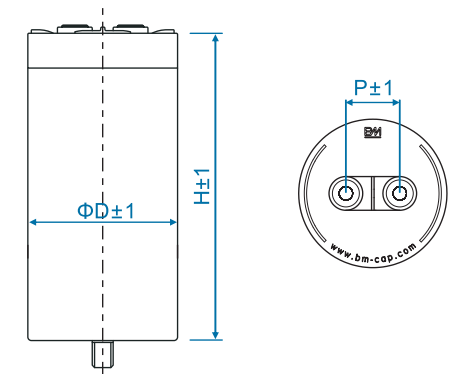

### 常用规格 Dimension Unit : mm

Rated voltage	Rated cap.	ΦD	H	P
800VDC	200 $\mu$ F	76	72	32
	420 $\mu$ F	76	122	32
	500 $\mu$ F	86	122	32
1100VDC	1000 $\mu$ F	86	227	32
	300 $\mu$ F	76	122	32
	420 $\mu$ F	76	177	32
1200VDC	470 $\mu$ F	86	177	32
	750 $\mu$ F	86	227	32
	300 $\mu$ F	76	177	32
1800VDC	370 $\mu$ F	86	177	32
	420 $\mu$ F	86	227	32
	470 $\mu$ F	86	227	32
1800VDC	80 $\mu$ F	76	122	32
	200 $\mu$ F	86	227	32

典型线路图  
Typical circuit

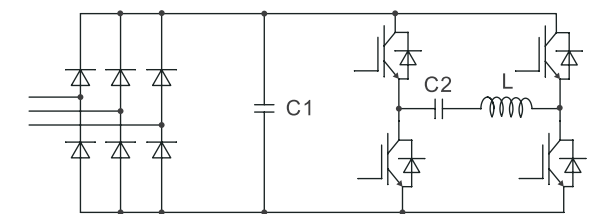

C1:DC-LINK电容  
DC-LINK capacitor



# DC-LINK 电容器 金属方壳式系列

DC-LINK CAPACITOR  
METAL SQUARE SHELL SERIES

MKP-L

采用耐温型金属化聚丙烯薄膜结构，铝壳或不锈钢外壳、阻燃环氧树脂封装。具有承受纹波电流能力强、峰值电流高、等效串联电阻小、寿命长等特点。广泛应用于风电、光伏、逆变电源、大型开关电源、感应加热设备及UPS等各类电力电子设备直流环节部分中作直流支撑、储能滤波电容使用。

The products are made of temperature-resistant metalized polypropylene, and enveloped with aluminum case or stainless steel case and flame-resistant epoxy resin. They have the characteristics of high ripple current, high peak current, low ESR, long lifetime, etc. Widely used in wind power, solar power, inversion power, big switch power supply, induction heating machine, UPS and other kinds of electronic equipments DC link part for DC support, energy storage and filter.

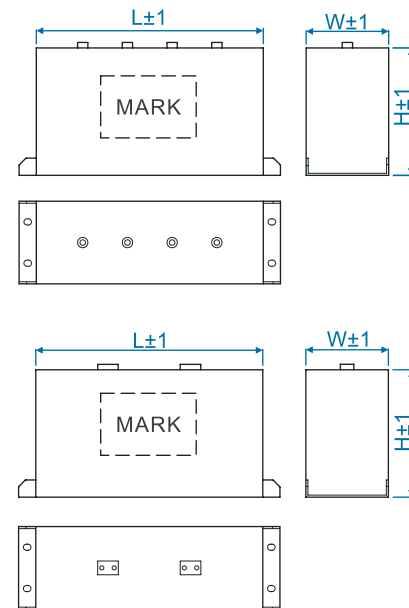

引用标准 Reference standard	GB/T 17702、IEC 61071
气候类别 Climatic category	40 / 85 / 21
额定电压 Rated voltage	400VDC ~ 2000VDC
容量范围 Capacitance range	1000μF ~ 20000μF
容量偏差 Capacitance tolerance	±5%(J)、±10%(K)
耐电压 Voltage proof	
极间 between terminals	1.5*Un(VDC)/60S
极壳 between terminal and case	2*Ui+1000(VAC)/60S
绝缘电阻 Insulation resistance(20°C)	≥5000S(100VDC,60S)
电压爬升率 Pulse rise time (dv/dt)	≥10V/μS

常用规格 Dimension		Unit : mm			
Rated voltage	Rated cap.	L	W	H	
800VDC	3000μF	330	120	185	
	4500μF	330	120	245	
	6000μF	330	120	310	
	10000μF	400	120	375	
1000VDC	2000μF	330	120	185	
	3000μF	330	120	245	
	4000μF	330	120	310	
	8000μF	330	230	310	
10000μF	400	230	310		
	1200VDC	1400μF	330	120	185
		2000μF	330	120	245
3000μF		330	120	310	
4000μF		330	230	245	
2000VDC	1300μF	330	120	310	
	3000μF	400	230	310	

典型线路图  
Typical circuit

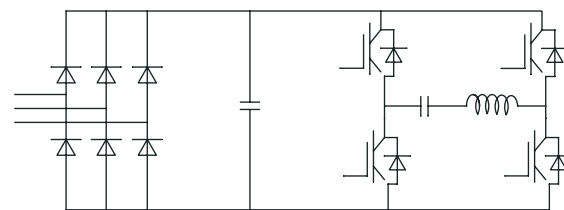

C1:DC-LINK电容  
DC-LINK capacitor

# 滤波电容器 塑壳式系列

FILTER CAPACITOR  
PLASTIC BOX SERIES

MKP-L

无感式结构，塑料外壳、阻燃环氧树脂封装，镀锡铜线或插片引出，可直接焊接在PCB板上，广泛应用于各类电力电子设备中作交流滤波电容使用。

Non-inductive structure, enveloped with plastic box and flame-resistant epoxy resin, welded by tinned copper or copper lug, they can directly installed on the PCB board. Widely used in different kinds of electronic equipments for AC&DC filter.



引用标准 Reference standard	GB/T 17702、IEC 61071
气候类别 Climatic category	40 / 85 / 21
额定电压 Rated voltage	400VDC ~ 1200VDC
容量范围 Capacitance range	1.0μF ~ 50μF
容量偏差 Capacitance tolerance	±5%(J)、±10%(K)
耐电压 Voltage proof	
极间 between terminals	1.5*Un(VDC)/60S
绝缘电阻 Insulation resistance(20°C)	≥5000S(100VDC,60S)
电压爬升率 Pulse rise time (dv/dt)	≥50V/μS

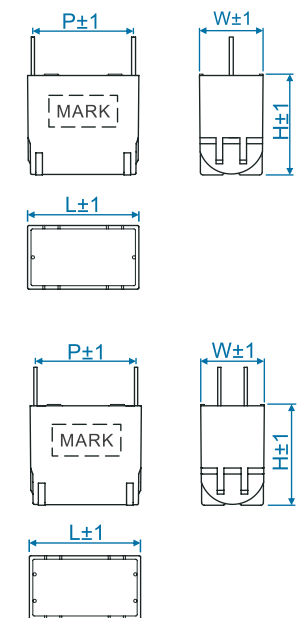

常用规格 Dimension		Unit : mm			
Rated voltage	Rated cap.	L	W	H	P
800VDC	3.3μF	36	19.5	32	31
	5μF	42	24	38	33
	8μF	42	24	38	33
	10μF	42	33	45.5	33
	12μF	42	36	52	33
	15μF	42	36	52	33

典型线路图  
Typical circuit

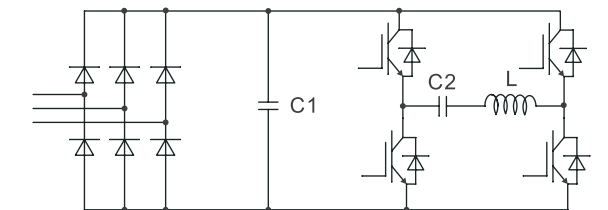

C1:滤波电容  
Filter capacitor

# 滤波电容器 轴向包胶式系列

FILTER CAPACITOR  
PET ADHESIVE TAPE SERIES

MKP-L

无感式结构，迈拉胶带、阻燃环氧树脂封装。产品具有体积小，安装灵活、方便，承受纹波电流能力强，杂散电感小，温升低，寿命长等特点。广泛应用于焊机、开关电源、电镀电源、感应加热设备、逆变器等各类电力电子设备中作交直流滤波电容使用。

Non-inductive structure, enveloped with PET adhesive tape and flame-resistant epoxy resin. They have the characteristics of small size, install easily and flexibly, high ripple current, low ESL, low temperature, long lifetime, etc. Widely used in welding machine, switch power supply, plating power supply, induction heating machine, inversion power and other kinds of electronic equipments for AC&DC filter.

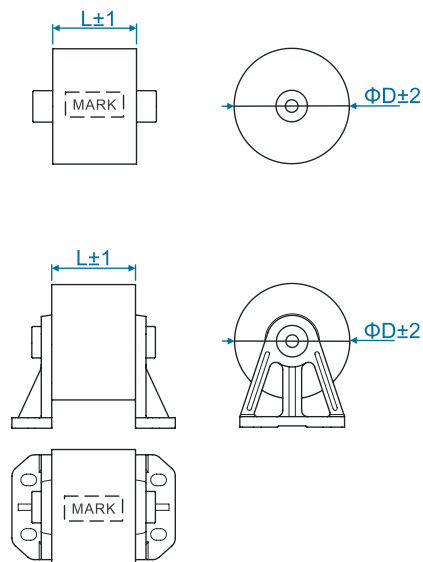

引用标准 Reference standard	GB/T 17702、IEC 61071
气候类别 Climatic category	40 / 85 / 21
额定电压 Rated voltage	400VDC ~ 2000VDC
容量范围 Capacitance range	20μF ~ 200μF
容量偏差 Capacitance tolerance	±5%(J)、±10%(K)
耐电压 Voltage proof	
极间 between terminals	1.5*Un(VDC)/60S
绝缘电阻 Insulation resistance(20°C)	≥5000S(100VDC, 60S)
电压爬升率 Pulse rise time (dv/dt)	≥50V/μS

## 常用规格 Dimension

Unit : mm

Rated voltage	Rated cap.	ΦD	L
800VDC	10μF	36	37
	20μF	45	40
	30μF	46	50
	40μF	53	50
	50μF	59	50
	60μF	57	60
	70μF	61	60
	80μF	65	60
	100μF	73	60
1000VDC	10μF	43	40
	20μF	50	50
	30μF	54	60
	50μF	69	60
1800VDC	8μF	45	60
	10μF	50	60

典型线路图  
Typical circuit

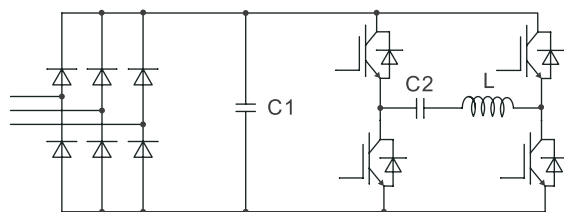

C1:滤波电容  
Filter capacitor

# 滤波电容器 铝壳模块式系列

FILTER CAPACITOR  
ALUMINUM MODULE SERIES

MKP-L

无感式结构，铝制外壳、阻燃环氧树脂封装，铜制螺母引出，具有散热快、温升低、过电流大、方便搭桥电路安装等特点。广泛应用于感应加热、大功率开关电源等各类电力电子设备中作交直流滤波电容使用。

Non-inductive structure, enveloped with aluminum box and flame-resistant epoxy resin, welded by copper nut. They have the characteristics of good heat dissipation, low temperature, strong over-current, conveniently to install bridge type circuit, etc. Widely used in induction heating machine, big switch power supply and other kinds of electronic equipments for AC&DC filter.



引用标准 Reference standard	GB/T 17702、IEC 61071
气候类别 Climatic category	40 / 85 / 21
额定电压 Rated voltage	400VDC ~ 1200VDC
容量范围 Capacitance range	10μF ~ 40μF
容量偏差 Capacitance tolerance	±5%(J)、±10%(K)
耐电压 Voltage proof	
极间 between terminals	1.5*Un(VDC)/60S
极壳 between terminal and case	2*Ui+1000(VAC)/60S
绝缘电阻 Insulation resistance(20°C)	≥5000S(100VDC, 60S)
电压爬升率 Pulse rise time (dv/dt)	≥100V/μS

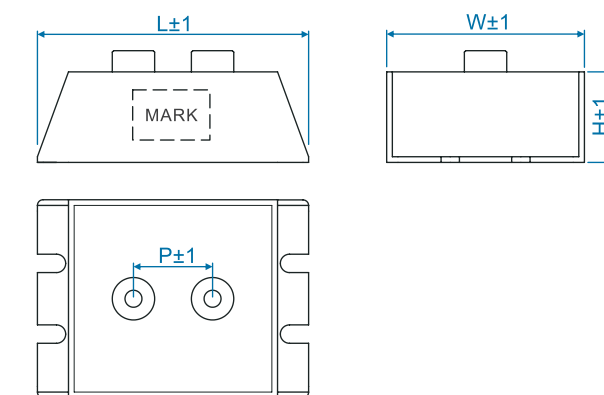

## 常用规格 Dimension

Unit : mm

Rated voltage	Rated cap.	L	W	H	P
800VDC	20μF	92	60	40	28
	25μF	104	70	40	28
	30μF	104	70	40	28
	40μF	120	90	40	28
	45μF	120	90	40	28
	50μF	130	102	40	28
	60μF	130	102	40	28
	70μF	150	108	40	28
	80μF	150	108	40	28

典型线路图  
Typical circuit

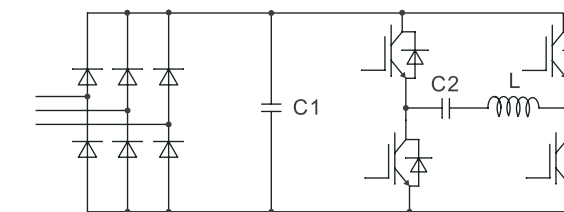

C1:滤波电容  
Filter capacitor

# 滤波电容器 模块式系列

FILTER CAPACITOR  
MODULE SERIESTAPE SERIES

MKP-L

运用由终而始的设计理念，采用无感、塑封、加强型轴心散热、单孔式安装等设计特点，和桥堆同等间距、高度的引出端子，充分解决了铝壳式极壳间爬电距离短、连接线排易极壳短路、安装尺寸大、安装成本高、轴心散热差、性价比低等结构特点，其优良的绝缘、散热、性价比和安装便利，是铝壳模块式滤波电容器升级换代之必选。广泛应用于各类电力电子设备中作交直流滤波电容使用。

Using the design idea from end to start, the products have the features of non-inductive, plastic sealed, fortified emit heat from axes center, single hole install, etc. And the connect terminal is the same distance & height with the rectifier, completely solve the short creep age distance between terminals and case of aluminum case type of capacitor, and the copper strip need artificial forming, easy short circuit, large installation size, high installation cost, the emit heat performance of axes center is bad, low cost performance, etc. It's advanced insulation, emit heat, performance, price and the convenient install. The aluminum box filter capacitor will be replay by this kind of capacitor. They are widely applied to AC & DC filter circuit of all kinds of power electronic equipments.

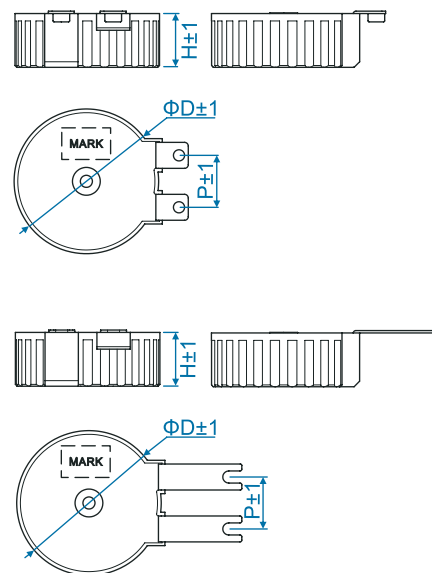
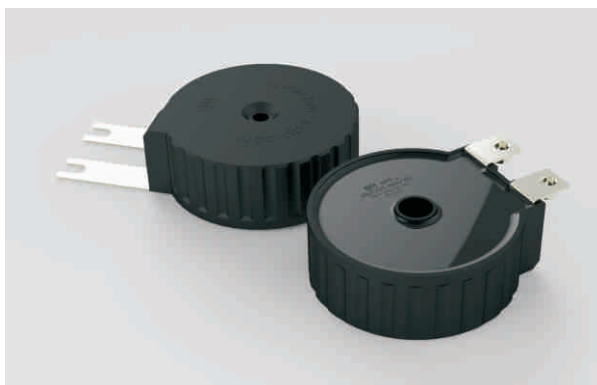

引用标准 Reference standard	GB/T 17702、IEC 61071
气候类别 Climatic category	40 / 85 / 21
额定电压 Rated voltage	400VDC ~ 1200VDC
容量范围 Capacitance range	10μF ~ 40μF
容量偏差 Capacitance tolerance	±5%(J)、±10%(K)
耐电压 Voltage proof	
极间 between terminals	1.5*Un(VDC)/60S
绝缘电阻 Insulation resistance(20°C)	≥5000S(100VDC, 60S)
电压爬升率 Pulse rise time (dv/dt)	≥100V/μS

## 常用规格 Dimension

Unit : mm

Rated voltage	Rated cap.	ΦD	H	P
800VDC	20μF	66	30.5	28
	25μF	66	30.5	28
	30μF	79	30.5	28
	40μF	79	30.5	28

## 典型线路图 Typical circuit

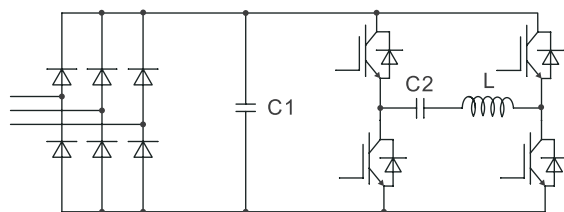

C1:滤波电容  
Filter capacitor

# 滤波电容器 焊机系列

FILTER CAPACITOR  
WELDING MACHINE SERIES

MKP-L

无感式结构，塑料外壳、阻燃环氧树脂封装。具有耐压高、过电流能力强、温升低、安装方便等特点。广泛应用于焊机设备作滤波电容使用。

Non-inductive structure, enveloped with PBT plastic box and flame-resistant epoxy resin. They have the characteristics of high voltage, strong over-current, low temperature, install easily, flexibly, etc. Widely used in welding machine for filter.

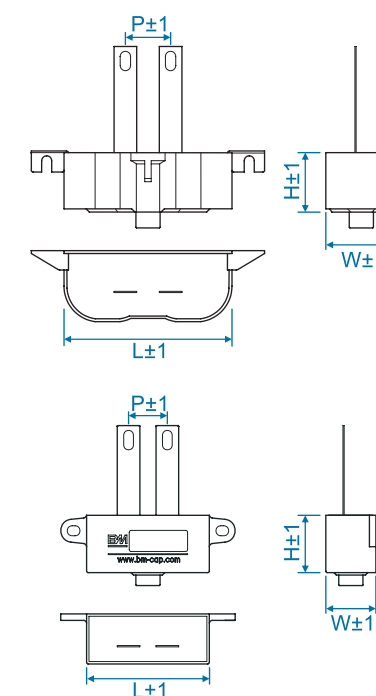

引用标准 Reference standard	GB/T 17702、IEC 61071
气候类别 Climatic category	40 / 85 / 21
额定电压 Rated voltage	400VDC ~ 1600VDC
容量范围 Capacitance range	5μF ~ 50μF
容量偏差 Capacitance tolerance	±5%(J)、±10%(K)
耐电压 Voltage proof	
极间 between terminals	1.5*Un(VDC)/60S
绝缘电阻 Insulation resistance(20°C)	≥5000S(100VDC, 60S)
电压爬升率 Pulse rise time (dv/dt)	≥20V/μS

## 常用规格 Dimension

Unit : mm

Rated voltage	Rated cap.	L	W	H	P
400VDC	2*10μF	76	31	37	26
	2*16μF	104	44	37	26
	2*20μF	104	44	37	26
	2*25μF	104	44	37	26

## 典型线路图 Typical circuit

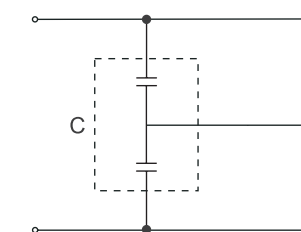

C:滤波电容  
Filter capacitor

# 缓冲吸收电容器 塑壳式系列

SNUBBER CAPACITOR  
PLASTIC BOX SERIES

## MKPH-S

无感式结构,塑料外壳阻燃环氧树脂封装,铜插片引出。具有峰值电流高、杂散电感小、温升低、寿命长、安装方便等特点。广泛应用于焊机、变频器、开关电源、电镀电源、感应加热设备、UPS、逆变电源等电力电子设备IGBT模块中作高频纹波、尖峰电压缓冲吸收电容使用。

Non-inductive structure, enveloped with plastic box and flame-resistant epoxy resin, welded by copper lug. They have the characteristics of high peak current, low ESL, low temperature, long lifetime, install easily and flexibly, etc. Widely used in welding machine, frequency converter, switch power supply, plating power supply, induction heating machine, UPS, inversion power and other kinds of electronic equipments for IGBT snubber protection and peak voltage clamp occasions.

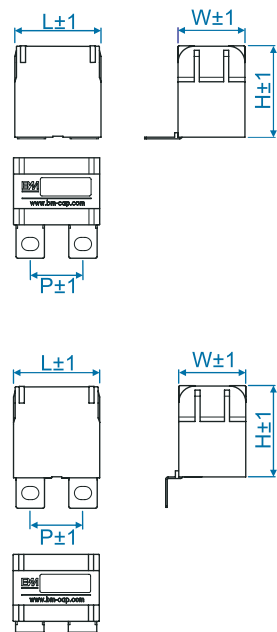
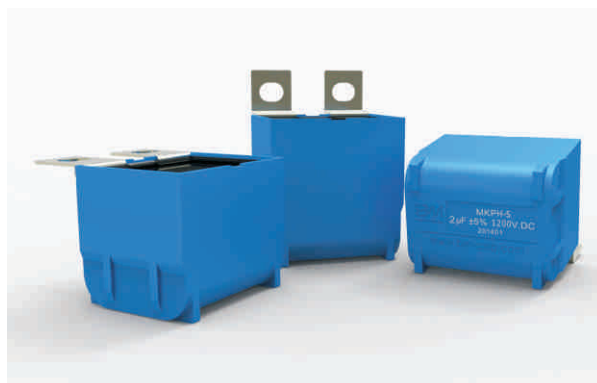

引用标准 Reference standard	GB/T 17702, IEC 61071
气候类别 Climatic category	40/105/21
额定电压 Rated voltage	800VDC ~ 2000VDC
容量范围 Capacitance range	0.1μF ~ 5μF
容量偏差 Capacitance tolerance	±5%(J), ±10%(K)
耐电压 Voltage proof	
极间 between terminals	1.75*Un(VDC)/60S
绝缘电阻 Insulation resistance(20°C)	≥5000S(100VDC, 60S)
电压爬升率 Pulse rise time (dv/dt)	≥1000V/μS

### 常用规格 Dimension

Unit : mm

Rated voltage	Rated cap.	L	W	H	P
800VDC	0.47μF	42.5	24.5	27.5	26
	1.0μF	42.5	33.5	35.5	26
	1.5μF	42.5	33	45	26
	2.0μF	42.5	33	45	26
1200VDC	2.5μF	42.5	33	45	26
	0.47μF	42.5	24.5	27.5	26
	0.68μF	42.5	33.5	35.5	26
	0.82μF	42.5	33.5	35.5	26
	1.0μF	42.5	33.5	35.5	26
	1.5μF	42.5	33	45	26
2000VDC	2.0μF	45	34	45	28
	2.2μF	45	34	45	28
	2.5μF	57	35	50	28
	0.47μF	42.5	33.5	35.5	26
1.0μF	57	30	45	28	

### 典型线路图 Typical circuit

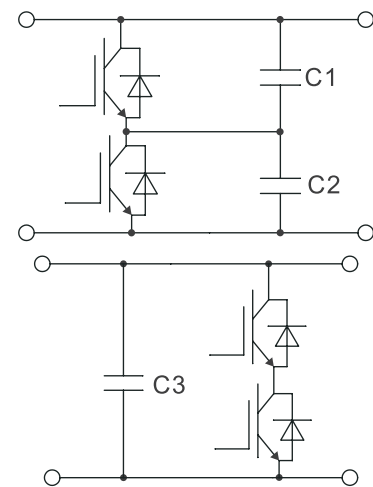

C1、C2、C3:缓冲吸收电容  
Snubber capacitor

# 缓冲吸收电容器 轴向包胶式系列

SNUBBER CAPACITOR  
PET ADHESIVE TAPE SERIES

## MKPH-S

无感式结构,迈拉胶带、阻燃环氧树脂封装,镀锡铜线引出。具有峰值电流高、杂散电感小、寿命长、产品体积小、安装灵活方便等特点。广泛应用于焊机、变频器、开关电源、电镀电源、感应加热设备、UPS、逆变电源等电力电子设备IGBT模块中作高频纹波、尖峰电压缓冲吸收电容使用。

Non-inductive structure, enveloped with PET adhesive tape and flame-resistant epoxy resin, welded by tin copper wire. They have the characteristics of high peak current, low ESL, long lifetime, small in size, install easily and flexibly, etc. Widely used in welding machine, frequency converter, switch power supply, plating power supply, induction heating machine, UPS, inversion power and other kinds of electronic equipments for IGBT snubber protection and peak voltage clamp occasions.

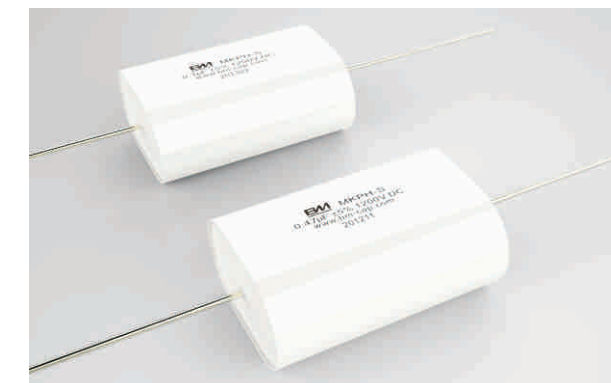

引用标准 Reference standard	GB/T 17702, IEC 61071
气候类别 Climatic category	40/105/21
额定电压 Rated voltage	800VDC ~ 2000VDC
容量范围 Capacitance range	0.1μF ~ 3μF
容量偏差 Capacitance tolerance	±5%(J), ±10%(K)
耐电压 Voltage proof	
极间 between terminals	1.75*Un(VDC)/60S
绝缘电阻 Insulation resistance(20°C)	≥5000S(100VDC, 60S)
电压爬升率 Pulse rise time (dv/dt)	≥1000V/μS

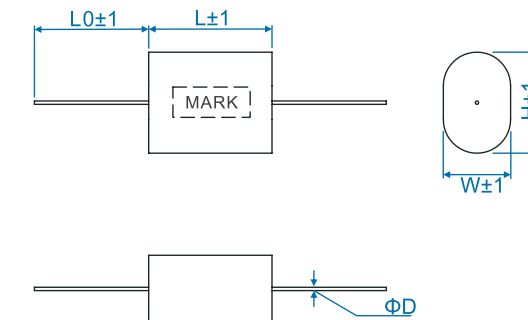

### 常用规格 Dimension

Unit : mm

Rated voltage	Rated cap.	L	W	H	L0	ΦD
1000VDC	0.22μF	30	13	22	40	1.0
	0.33μF	30	16	25	40	1.0
	0.47μF	37	16	26	40	1.0
	1.0μF	44	20	33	40	1.2
1200VDC	1.5μF	44	26	38	40	1.2
	0.22μF	30	13	24	40	1.0
	0.33μF	30	18	27	40	1.0
	0.47μF	44	14	24	40	1.0
	0.68μF	44	16	29	40	1.0
	1.0μF	44	20	33	40	1.2
2000VDC	1.5μF	44	26	38	40	1.2
	2.2μF	44	32	44	40	1.2

### 典型线路图 Typical circuit

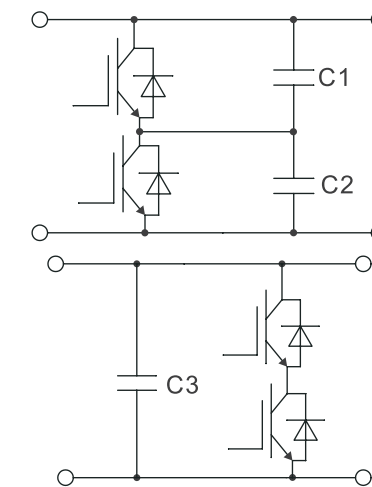

C1、C2、C3:缓冲吸收电容  
Snubber capacitor

# 缓冲吸收电容器 高压GTO系列

## SNUBBER CAPACITOR GTO DEDICATED SERIES

# MKPH-S

无感式结构，迈拉胶带、阻燃环氧树脂封装，铜螺母引出。具有耐压高、过电流能力强、杂散电感小、峰值电流高、安装灵活方便等特点。广泛应用于高功率晶闸管GTO上作高频纹波及尖峰电压缓冲吸收电容使用。

Non-inductive structure, enveloped with PET adhesive tap and flame-resistant epoxy resin, welded by copper nut. They have the characteristics of high voltage, strong over-current, low ESL, high peak current, install easily, flexibly, etc. Widely used in GTO for snubber protection and peak voltage clamp occasions.

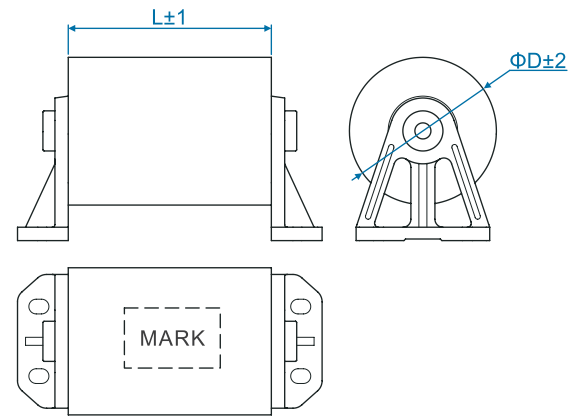

引用标准 Reference standard	GB/T 17702、IEC 61071
气候类别 Climatic category	40/105/21
额定电压 Rated voltage	4000VDC~10000VDC
容量范围 Capacitance range	0.1μF~2μF
容量偏差 Capacitance tolerance	±5%(J)、±10%(K)
耐电压 Voltage proof	
极间 between terminals	1.5*Un(VDC)/60S
绝缘电阻 Insulation resistance(20°C)	≥5000S(100VDC,60S)
电压爬升率 Pulse rise time (dv/dt)	≥1000V/μS

常用规格 Dimension				Unit : mm
Rated voltage	Rated cap.	ΦD	L	
8000VDC	0.2μF	44	76	
	0.68μF	46	76	
	0.75μF	48	76	
	0.82μF	50	76	
	1.0μF	55	76	
	1.2μF	60	76	

典型线路图  
Typical circuit

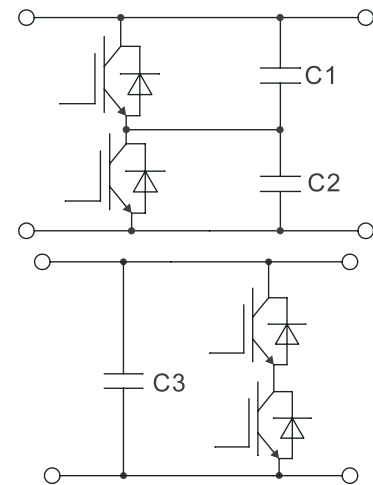

C1、C2、C3:缓冲吸收电容  
Snubber capacitor

# 谐振电容器 塑壳式系列

## RESONANCE CAPACITOR PLASTIC BOX SERIES

# MKPH-R

内串式双面加厚型金属化膜结构，塑料外壳、阻燃环氧树脂封装，镀锡铜线或铜插片引出。具有耐压高、过电流能力强、温升低、频率特性好、安装方便等特点。广泛应用于各类电力电子设备中作谐振电容使用。

String type double thickened metalized electrode, enveloped with plastic box and flame-resistant epoxy resin, welded by tinned copper or copper lug. They have the characteristics of high voltage, strong over-current, low temperature, good frequency, install easily and flexibly, etc. Widely used in different kinds of electronic equipments as resonance capacitor.

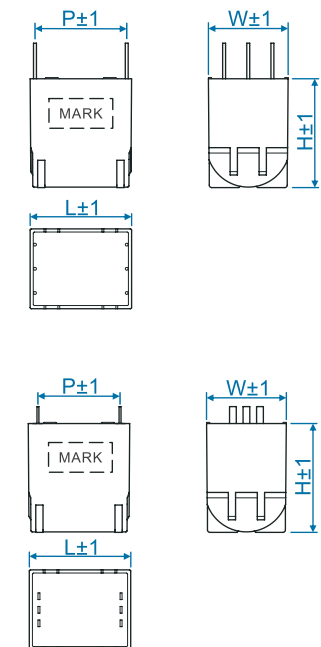

引用标准 Reference standard	GB/T 3984、IEC 60110
气候类别 Climatic category	40/105/21
额定电压 Rated voltage	1000VDC~4000VDC(500VAC~2000VAC)
容量范围 Capacitance range	0.1μF~2.0μF
容量偏差 Capacitance tolerance	±5%(J)、±10%(K)
耐电压 Voltage proof	
极间 between terminals	1.5*Un(VDC)/60S
绝缘电阻 Insulation resistance(20°C)	≥5000S(100VDC,60S)
电压爬升率 Pulse rise time (dv/dt)	≥1000V/μS

常用规格 Dimension						Unit : mm
Rated voltage	Rated cap.	L	W	H	P	
3000VDC	0.1μF	36	19.5	32	30.5	
	0.15μF	42	24	38	34	
	0.18μF	42	24	38	34	
	0.24μF	42	33	45.5	34	
	0.27μF	42	33	45.5	34	
	0.3μF	42	33	45.5	34	
	0.33μF	42	33	45.5	34	
	0.39μF	42	36	52	34	
4000VDC	0.1μF	42	24	38	34	
	0.15μF	42	33	45.5	34	

典型线路图  
Typical circuit

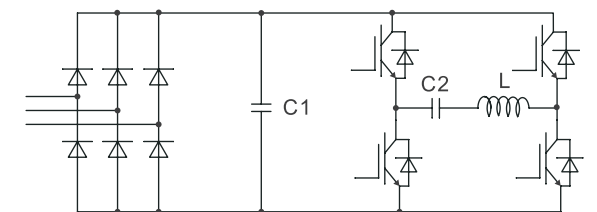

C2:谐振电容  
Resonance capacitor

# 谐振电容器 包胶系列

RESONANCE CAPACITOR  
PET ADHESIVE TAPE SERIES

内串式双面加厚型金属化膜结构，迈拉胶带、阻燃环氧树脂封装，铜螺母或铜插片引出。具有耐压高、过电流能力强、温升高、频率特性好、安装灵活方便等特点。广泛应用于各类电力电子设备中作谐振电容使用。

String type double thickened metalized electrode, enveloped with PET adhesive tape and flame-resistant epoxy resin, welded by copper nut or copper lug. They have the characteristics of high voltage, strong over-current, low temperature, good frequency characteristic, install easily, flexibly, etc. Widely used in different kinds of electronic equipments as resonance capacitor.

# MKPH-R

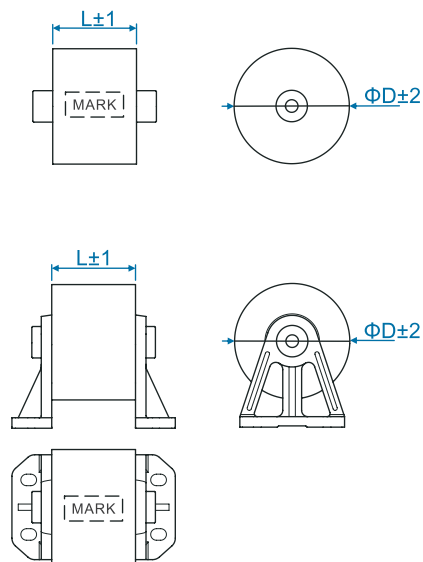

引用标准 Reference standard	GB/T 3984、IEC 60110
气候类别 Climatic category	40/105/21
额定电压 Rated voltage	1000VDC~4000VDC(500VAC~2000VAC)
容量范围 Capacitance range	0.1μF~5.0μF
容量偏差 Capacitance tolerance	±5%(J)、±10%(K)
耐电压 Voltage proof	
极间 between terminals	1.5*Un(VDC)/60S
绝缘电阻 Insulation resistance(20°C)	≥5000S(100VDC,60S)
电压爬升率 Pulse rise time (dv/dt)	≥1000V/μS

## 常用规格 Dimension Unit : mm

Rated voltage	Rated cap.	ΦD	L
1600VDC (500VAC)	0.68μF	47	44
	1.0μF	57	44
2000VDC (750VAC)	0.3μF	48	32
	0.68μF	47	44
	1.0μF	57	44
3000VDC (1200VAC)	1.5μF	68	44
	0.2μF	44	32
	0.3μF	41	44
	0.47μF	46	44
4000VDC (1600VAC)	0.68μF	54	44
	1.0μF	65	44
	0.1μF	42	32
	0.2μF	48	44
6000VDC	0.3μF	58	44
	0.47μF	66	44
	0.68μF	67	44

典型线路图  
Typical circuit

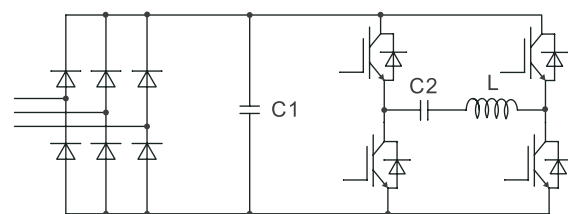

C2:谐振电容  
Resonance capacitor

# 谐振电容器 铝壳模块式系列

RESONANCE CAPACITOR  
ALUMINUM MODULE SERIES

内串式双面加厚型金属化膜结构，铝制外壳、阻燃环氧树脂封装，铜螺母引出。具有耐压高、过电流能力强、温升高、频率特性好、安装灵活方便等特点。广泛应用于各类电力电子设备中作谐振电容使用。

String type double thickened metalized electrode, enveloped with aluminum case and flame-resistant epoxy resin, welded by copper nut. They have the characteristics of good heat dissipation, low temperature, strong over-current, conveniently to install bridge type circuit, etc. Widely used in different kinds of electronic equipments as resonance capacitor.

# MKPH-R

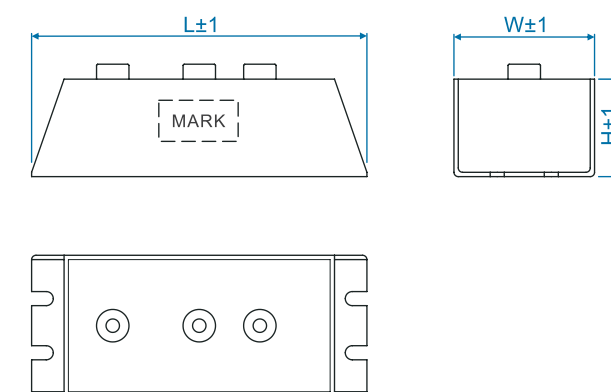

引用标准 Reference standard	GB/T 3984、IEC 60110
气候类别 Climatic category	40/105/21
额定电压 Rated voltage	1000VDC~4000VDC
容量范围 Capacitance range	0.1μF~3.0μF
容量偏差 Capacitance tolerance	±5%(J)、±10%(K)
耐电压 Voltage proof	
极间 between terminals	1.5*Un(VDC)/60S
极壳 between terminal and case	2*Ui+1000(VAC)/60S
绝缘电阻 Insulation resistance(20°C)	≥5000S(100VDC,60S)
电压爬升率 Pulse rise time (dv/dt)	≥1000V/μS

## 常用规格 Dimension Unit : mm

Rated voltage	Rated cap.	L	W	H
2000VDC	2*1.6μF	178	78	40
	2*1.9μF	178	78	40
3000VDC	2*0.4μF	140	56	52
	2*0.5μF	155	65	52
	2*0.6μF	155	65	52
	2*0.7μF	155	65	52
	2*0.8μF	175	74	52
6000VDC	2*1.0μF	175	74	52
	2*1.2μF	175	74	52
	0.5μF	210	90	92
	1.1μF	210	180	92

典型线路图  
Typical circuit

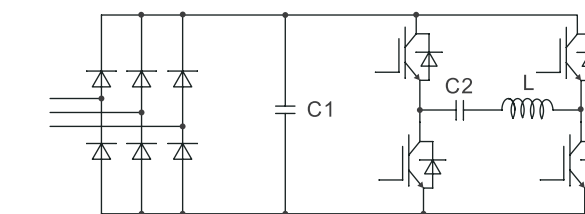

C2:谐振电容  
Resonance capacitor

# 谐振电容器 模块式系列

## RESONANCE CAPACITOR MODULE SERIES

# MKPH-R

运用由终而始的设计理念，采用无感式、塑封式结构、全金属散热底板，和IGBT模块同等间距、高度的引出螺母，充分解决了铝壳式极壳间爬电距离短、连接线排需人工整形、易极壳短路、安装尺寸大、性价比低等结构缺点，其优良的绝缘、散热、性价比和安装便利性，是铝壳式谐振电容器模块升级换代之必选。广泛应用于逆变电源、感应加热设备等电力电子设备中作谐振电容使用。

Using the design idea from end to start, the products are of the design features of non-inductive, full metal heat baseboard, the nut is the same distance & height with IGBT module, completely solve the short creep age distance between terminals and case of aluminum case type of capacitor, and the copper strip need artificial forming, easy short circuit, large installation size, high installation cast, the emit heat performance of axes center is bad, low cost performance, etc. It's advanced insulation, emit heat, performance, price and the convenient install, the aluminum box filter capacitor will be replaced by this kind of capacitor. They are widely applied to all kinds of electronic equipments resonance capacitor.

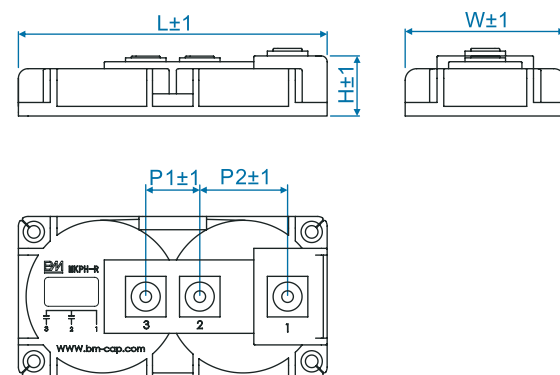

引用标准 Reference standard	GB/T 3984、IEC 60110
气候类别 Climatic category	40/105/21
额定电压 Rated voltage	600VDC ~ 2000VDC
容量范围 Capacitance range	0.3μF ~ 1.5μF
容量偏差 Capacitance tolerance	±5%(J)、±10%(K)
耐电压 Voltage proof	
极间 between terminals	1.5*Un(VDC)/60S
极壳 between terminal and case	2*Ui+1000(VAC)/60S
绝缘电阻 Insulation resistance(20°C)	≥5000S(100VDC,60S)
电压爬升率 Pulse rise time (dv/dt)	≥1000V /μS

常用规格 Dimension		Unit : mm			
Rated voltage	Rated cap.	L	W	P1	P2
2000VDC	2*0.5μF	144	76	28	38
	2*0.6μF	144	76	28	38
	2*0.68μF	144	76	28	38
	2*0.7μF	144	76	28	38
	2*0.8μF	160	83	28	45.5
	2*0.9μF	160	83	28	45.5
	2*1.0μF	160	83	28	45.5
	2*1.1μF	160	83	28	45.5
	2*1.2μF	160	83	28	45.5

典型线路图  
Typical circuit

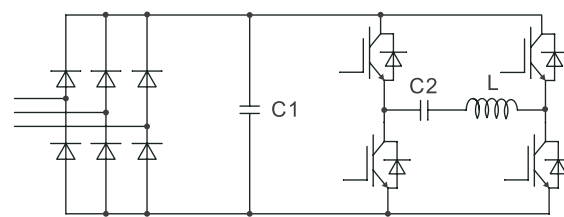

C2:谐振电容  
Resonance capacitor

# 耦合隔直电容器 轴向包胶式系列

## COUPLING CAPACITOR PET ADHESIVE TAPE SERIES

# MKP-C

无感式结构，迈拉胶带、阻燃环氧树脂封装，铜螺母引出。具有体积小、过流能力强、杂散电感小、温升低、寿命长、安装灵活方便等特点。广泛应用于开关电源、电镀电源、逆变器、感应加热等设备中，与功率输出变压器初级线圈串联使用，作耦合隔直电容使用。

Non-inductive structure, enveloped with PET adhesive tape and flame-resistant epoxy resin, welded by copper nut. They have the characteristics of small size, strong over-current, low ESL, low temperature, long lifetime, install easily and flexibly, etc. Widely used in switch power supply, plating power supply, inversion power, induction heating machine, etc. connected in series with power output transformer for coupling.



引用标准 Reference standard	GB/T 17702、IEC 61071
气候类别 Climatic category	40/85/21
额定电压 Rated voltage	400VDC ~ 1600VDC
容量范围 Capacitance range	5.0μF ~ 100μF
容量偏差 Capacitance tolerance	±5%(J)、±10%(K)
耐电压 Voltage proof	
极间 between terminals	1.5*Un(VDC)/60S
绝缘电阻 Insulation resistance(20°C)	≥5000S(100VDC,60S)
电压爬升率 Pulse rise time (dv/dt)	≥100V /μS

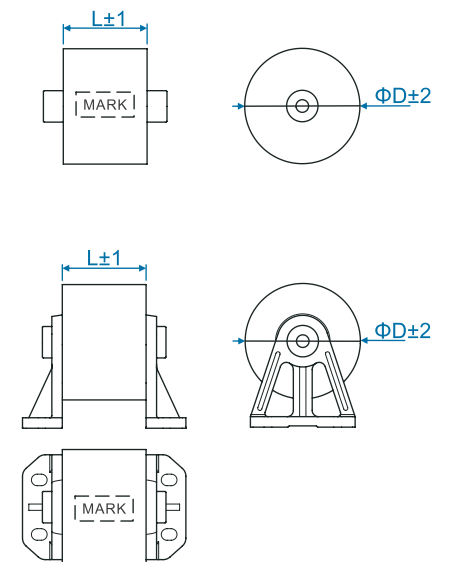

常用规格 Dimension		Unit : mm	
Rated voltage	Rated cap.	ΦD	L
800VDC	10μF	42	40
	20μF	59	40
	30μF	46	50
	40μF	53	50
	50μF	58	50
	60μF	56	60
	80μF	65	60
	100μF	72	60
1400VDC	5μF	46	40
	20μF	67	60

典型线路图  
Typical circuit

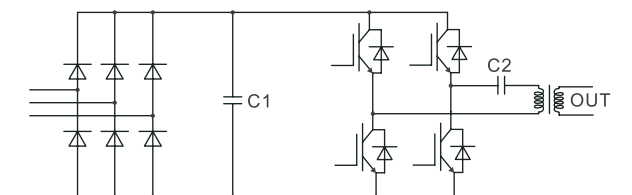

C2:耦合隔直电容  
Coupling capacitor

# 交流滤波电容器 塑壳系列

## AC FILTER CAPACITOR PLASTIC BOX SERIES

# MKP-F

无感式结构，塑料外壳、阻燃环氧树脂封装，镀锡铜线或AWG铜软线引出。具有体积小、杂散电感小、安装方便等特点。广泛应用于开关电源、电镀电源、逆变器、UPS等设备中，与电抗器组成LC滤波，整治谐波污染。

Non-inductive structure, enveloped with plastic box and flame-resistant epoxy resin, welded by tinned copper or AWG copper wire. They have the characteristics of small size, low ESL, install flexibly, etc. Widely used in switch power supply, plating power supply, inversion power, UPS, etc. Composed of multi-stage LC filter with reactor L for harmonic pollution remediation.

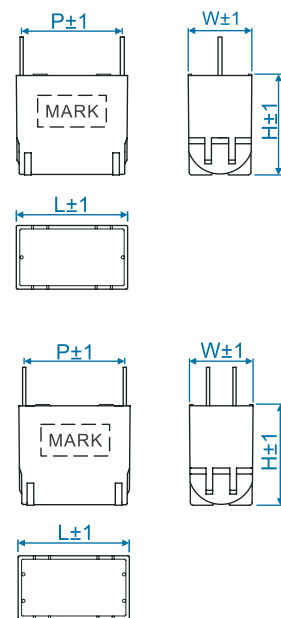
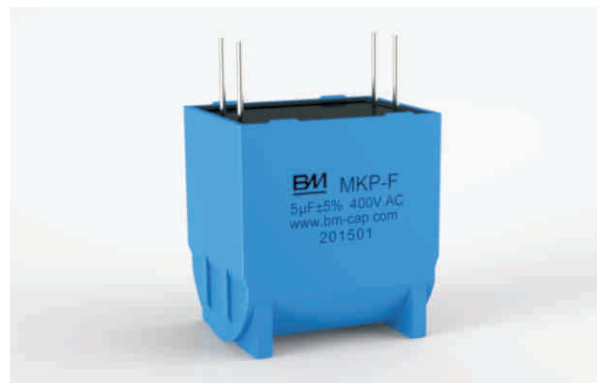

引用标准 Reference standard	GB/T 17702, IEC 61071
气候类别 Climatic category	40/85/21
额定电压 Rated voltage	250VAC ~ 1000VAC
容量范围 Capacitance range	1.0µF ~ 30µF
容量偏差 Capacitance tolerance	±5%(J), ±10%(K)
耐电压 Voltage proof	
极间 between terminals	1.5*Un(VDC)/60S
绝缘电阻 Insulation resistance(20°C)	≥5000S(100VDC, 60S)
电压爬升率 Pulse rise time (dv/dt)	≥60V /µS

### 常用规格 Dimension

Unit : mm

Rated voltage	Rated cap.	L	W	H	P
250VAC	8µF	42	24	38	31
	10µF	42	24	38	31
	15µF	42	27	41	38
	20µF	58	25	38	52.5
400VAC	6µF	46	23.5	38	42
	10µF	58	25	38	52.5
	15µF	58	30	45	52.5
	20µF	58	35	50	52.5
	30µF	58	35	50	52.5
690VAC	4µF	58	30	45	52.5
	5µF	58	35	50	52.5
	8µF	58	43	56	52.5

典型线路图  
Typical circuit

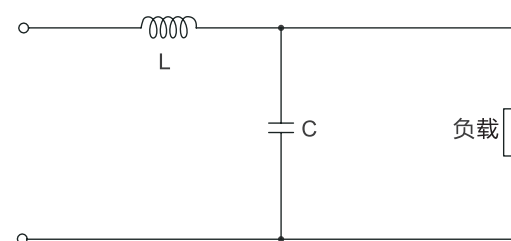

C:交流滤波电容  
AC filter capacitor

# 交流滤波电容器 轴向包胶式系列

## AC FILTER CAPACITOR PET ADHESIVE TAPE SERIES

# MKP-F

无感式结构，迈拉胶带、阻燃环氧树脂封装，铜螺母引出。具有体积小、过流能力强、杂散电感小、温升低、寿命长、安装灵活方便等特点。广泛应用于开关电源、电镀电源、逆变器、UPS等设备中，与电抗器组成LC滤波，整治谐波污染。

Non-inductive structure, enveloped with PET adhesive tape and flame-resistant epoxy resin, welded by copper nut. They have the characteristics of small size, strong over-current, low ESL, low temperature, long lifetime, install easily and flexibly, etc. Widely used in switch power supply, plating power supply, inversion power, UPS, etc. Composed of multi-stage LC filter with reactor L for harmonic pollution remediation.

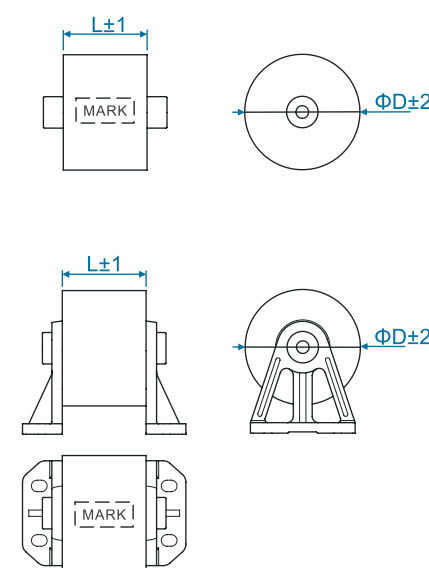

引用标准 Reference standard	GB/T 17702, IEC 61071
气候类别 Climatic category	40/85/21
额定电压 Rated voltage	250VAC ~ 1000VAC
容量范围 Capacitance range	1.0µF ~ 100µF
容量偏差 Capacitance tolerance	±5%(J), ±10%(K)
耐电压 Voltage proof	
极间 between terminals	1.5*Un(VDC)/60S
绝缘电阻 Insulation resistance(20°C)	≥5000S(100VDC, 60S)
电压爬升率 Pulse rise time (dv/dt)	≥100V /µS

### 常用规格 Dimension

Unit : mm

Rated voltage	Rated cap.	ΦD	L
250VAC	50µF	44	60
	60µF	47	60
	80µF	54	60
	100µF	60	60
400VAC	20µF	44	50
	30µF	54	50
	40µF	54	60
	50µF	60	60
	60µF	66	60
690VAC	8µF	45	60
	10µF	49	60
	15µF	60	60

典型线路图  
Typical circuit

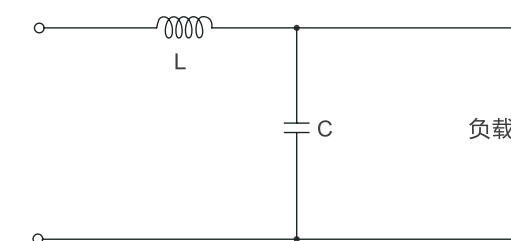

C:交流滤波电容  
AC filter capacitor





# 微波炉电容器事业部

## CAPACITORS FOR MICROWAVE OVENS (STANDARD CLASS SERIES)

专注于CBB85型微波炉倍压整流电路用电容器的制造。采用干式金属化聚丙烯薄膜结构、无漏液隐患；内置放电电阻、防错式快接端子、一体化安装耳，安装、连接便利高效。

We are absorbed in research and produce CBB85 type microwave ovens capacitors which for the voltage doublers rectifier circuit. The products are made of dry metalized polypropylene film, sealing safe without the leaking trouble, and placing the resistance, defend quick-connect terminals, integrative mounting ears. They are convenient and efficient in installation and connection.

### 微波炉倍压整流 电路用 电容器

# CBB85



## 安装对比

### INSTALLATION COMPARISON

#### 新型干式结构

#### New Dry-type Structure

可单手操作的一体化支架和腰孔定位，安装便捷高效。  
With the mounting bracket and hole can operate by one hand with high efficiency.



#### 传统油式结构

#### Traditional Oil-type Structure

需双手作业的分体式支架，定位复杂、安装繁琐低效。  
With separate bracket, need to operate by two hands, complicated and ineffective.

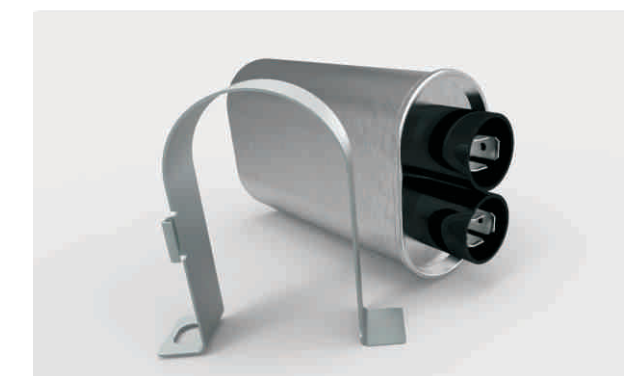

引用标准 Reference standard	GB/T 18939.1、IEC 61270-1、JIS C 4908 DIN VDE 0560 Part 1 and Part 22
气候类别 Climatic category	10 / 85 / 21
额定电压 Rated voltage	2100VAC ( 50 / 60Hz)
容量范围 Capacitance range	0.5μF ~ 1.2μF
容量偏差 Capacitance tolerance	±3%
测试电压 Testing voltage	
极间 between terminals	4.3*U <sub>m</sub> (VDC) / 10s
极壳 between terminals and case	2.4*U <sub>m</sub> +1200(VAC) / 1s
损耗角正切 Tangent of loss angle(20°C)	≤0.001 (1KHz)
使用等级 Application class	标准级 (S级) standard class (S class)

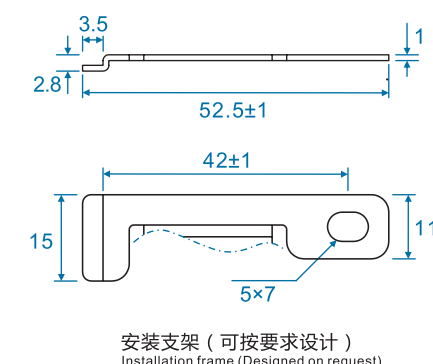
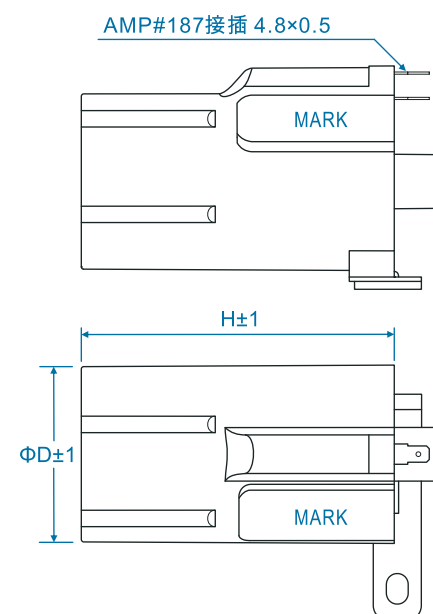

安装支架 (可按要求设计)  
Installation frame (Designed on request)

### 常用规格 Dimension Unit : mm

Rated cap.	ΦD	H	Rated cap.	ΦD	H
0.50μF	38	62	0.92μF	41	68
0.60μF	38	62	0.95μF	41	68
0.65μF	38	62	1.00μF	41	72
0.70μF	38	68	1.05μF	41	72
0.75μF	38	68	1.07μF	41	72
0.80μF	38	68	1.10μF	43	72
0.85μF	41	68	1.15μF	43	72
0.90μF	41	68	1.20μF	43	72

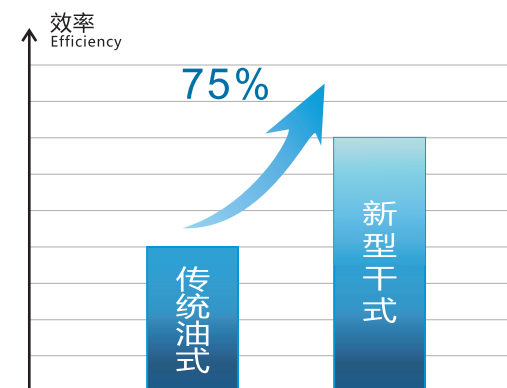
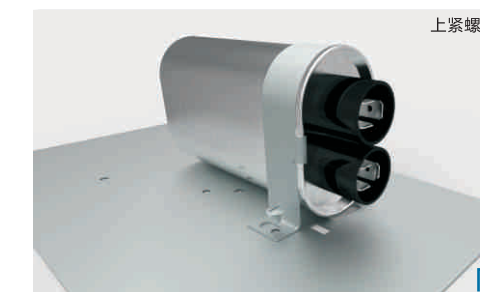
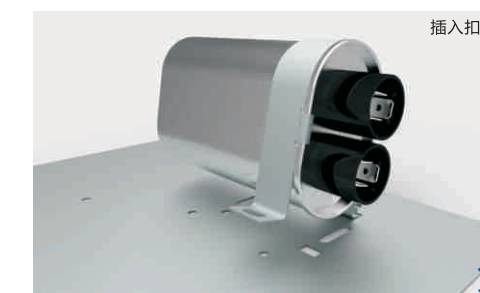
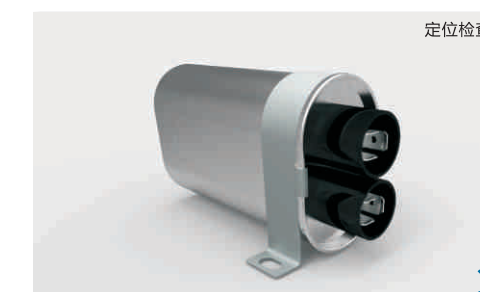
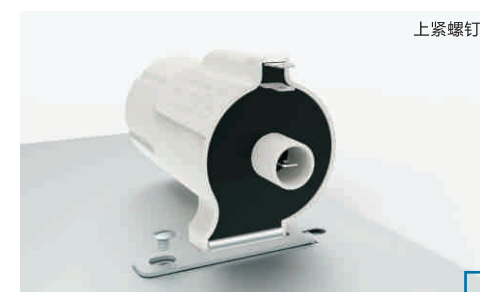

## 接线对比 WIRE CONNECTION COMPARISON

典型线路图  
Typical circuit

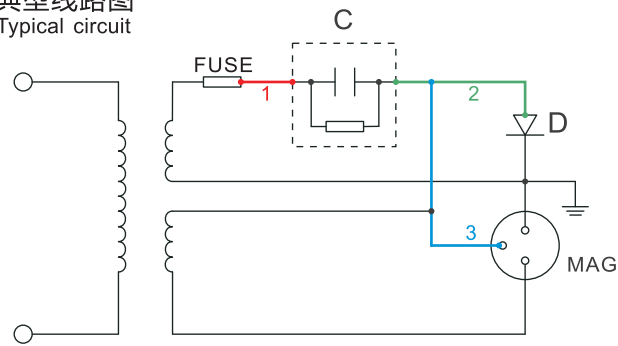

新型干式结构  
New Dry-type Structure

端插对应无冗余，减少接线错误。  
Fermal connect corresponding by less connect mistake.

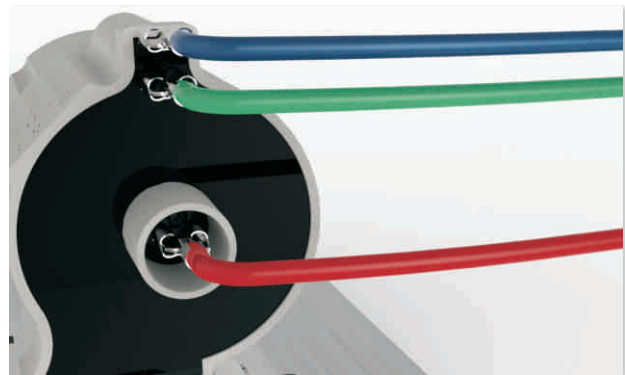

传统油式结构  
Traditional Oil-type Structure

端插数量不匹配，诱发接线错误。  
Fermal quantity is not corresponded, easy to connect wrong.

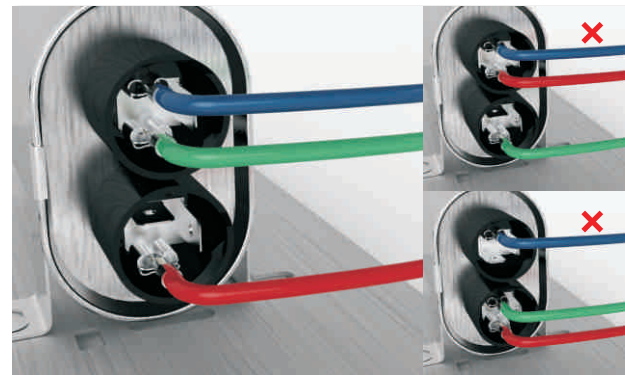

## 配送对比 DELIVERY COMPARISON

新型干式结构  
New Dry-type Structure

一体化设计，减少物料，采购配送简单，节约存转空间。  
Integrated design, reduce the parts, easy to purchasing and distribution, save storage and working space.



传统油式结构  
Traditional Oil-type Structure

分体式设计，物料多样，采购配送繁杂，占用存转空间。  
Spliled design, increase the parts, difficult to purchasing and distribution, waste of storage and working space.



## 真空镀膜事业部 VACUUM COATING DEPARTMENT

专业生产高方阻型、安全型、渐变型、双面型等各类金属化薄膜，在各类高品质金属化薄膜电容器中广泛应用。  
Mainly produce high square resistor metallized film, safety metallized film, graded metallized film, double side metallized film. It's widely used in various high quality metallized film capacitors.

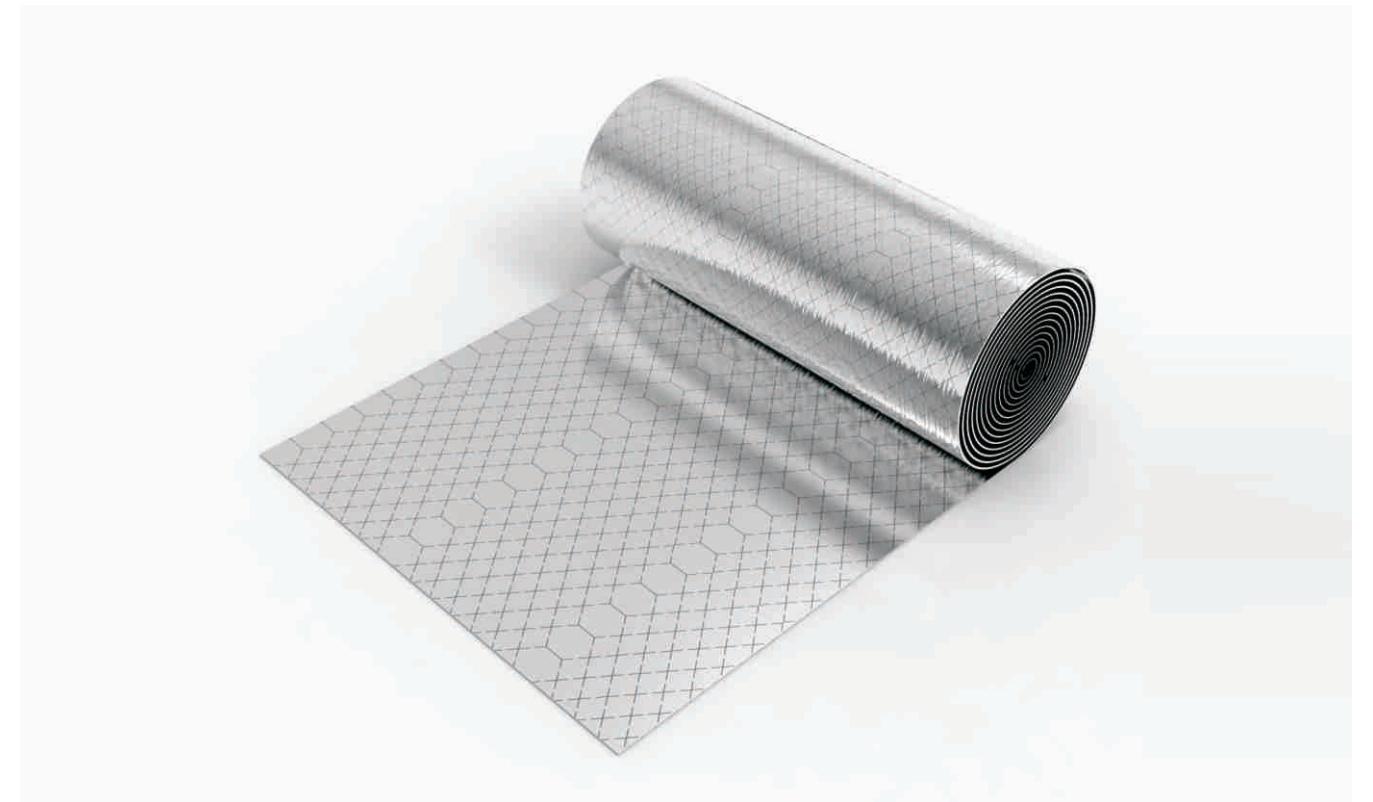

薄膜分切机  
Film splitter



薄膜分切机  
Film splitter



# UGF5A型

( 85°C 2000小时寿命保证 )

- 符合RoHS要求。
- 160WV~600WV超高压。
- 85°C2000小时变频器专用。

## 螺栓型铝电解电容器



### 产品规格表

项目	规格
使用温度范围	-25°C ~ +85°C
额定电压	160 ~ 600V.DC
静电容量允许偏差	100-39000(±20%) (20°C, 120Hz)
漏电流	0.01CV (μA)或5mA 取小值 [ C = 公称静电容量(μF), V=额定电压(V) ]
损失角正切 (20°C, 120Hz)	标准品额定表的价值以下 ( 20°C、120Hz )
容许纹波电流	按标准品额定表中的规定 (40°C, 120Hz)
高温负荷	85°C施加额定电压(叠加规定的纹波电流)2000小时后,性能符合: 静电容量变化率 初期值的±20%以内 损失角正切值 额定规格值的200%以下 漏电流 额定规格值以下
执行标准	JIS C 5101-4

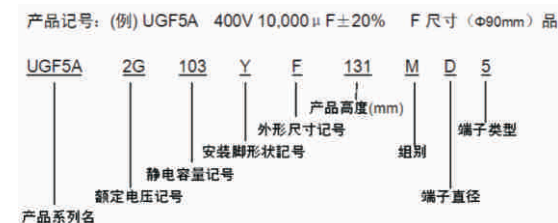
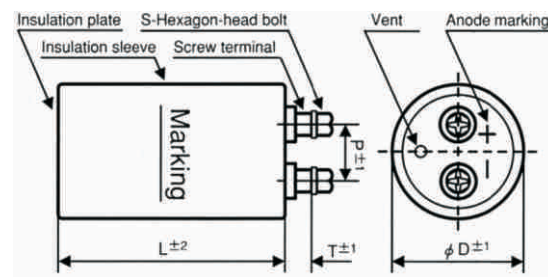

### 常用规格

Unit : mm

φD	P	S	T	盖板材质
36	12.7	M5×10	6.0	Phenol
51	22.0	M5×10	5.5	Phenol
64	28.6	M5×10	5.5	Phenol
77	32.0	M5×10	4.5	Phenol
90	32.0	M5×10	4.0	Phenol
101	41.5	M8×16	10.0	Phenol

### 纹波电流修正系数

环境温度(°C)	40	60	70	85	
修正系数	1.0	0.75	0.62	0.37	
频率(Hz)	50/60	120	300	1K	≥10K
修正系数	0.7	1.0	1.1	1.3	1.4

# ULQ 型 新品

( 85°C 5000小时寿命保证 )

- 符合RoHS要求。
- 85°C耐大纹波电流系列。
- 5000小时长寿命一般电子工业品。

## 焊针型铝电解电容器



### 产品规格表

项目	特性																					
使用温度范围	-40°C~+85°C, -25°C~+85°C																					
额定电压	10V ~ 400V, 450V																					
静电容量允许偏差	68-22000±20% (20°C, 120Hz)																					
漏电流	I≤0.01CV(μA)或1.5mA取小值(20°C, 5分钟) C=公称静电容量(μF), V=额定电压(V)																					
损失角正切 (20°C, 120Hz)	<table border="1"> <tr> <td>U<sub>R</sub>(V)</td> <td>10</td> <td>16</td> <td>25</td> <td>35</td> <td>50</td> <td>63~100</td> <td>160~450</td> </tr> <tr> <td>tanδ</td> <td>0.80</td> <td>0.60</td> <td>0.50</td> <td>0.40</td> <td>0.30</td> <td>0.20</td> <td>0.15</td> </tr> </table>	U <sub>R</sub> (V)	10	16	25	35	50	63~100	160~450	tanδ	0.80	0.60	0.50	0.40	0.30	0.20	0.15					
U <sub>R</sub> (V)	10	16	25	35	50	63~100	160~450															
tanδ	0.80	0.60	0.50	0.40	0.30	0.20	0.15															
温度特性	<table border="1"> <tr> <td>U<sub>R</sub>(V)</td> <td>10</td> <td>16~35</td> <td>50~100</td> <td>160~200</td> <td>250~400</td> <td>450</td> </tr> <tr> <td>Z(-25°C)/Z(+20°C)</td> <td>5</td> <td>4</td> <td>3</td> <td>3</td> <td>4</td> <td>4</td> </tr> <tr> <td>Z(-40°C)/Z(+20°C)</td> <td>18</td> <td>15</td> <td>10</td> <td>6</td> <td>8</td> <td>—</td> </tr> </table>	U <sub>R</sub> (V)	10	16~35	50~100	160~200	250~400	450	Z(-25°C)/Z(+20°C)	5	4	3	3	4	4	Z(-40°C)/Z(+20°C)	18	15	10	6	8	—
U <sub>R</sub> (V)	10	16~35	50~100	160~200	250~400	450																
Z(-25°C)/Z(+20°C)	5	4	3	3	4	4																
Z(-40°C)/Z(+20°C)	18	15	10	6	8	—																

### 耐久性

85°C施加带额定纹波电流的额定电压(不超过额定电压)5000小时后,经恢复24小时后性能符合:  
 容量变化率 初期值的±20%以内  
 损失角正切值 额定规格值的200%以下  
 漏电流 额定规格值以下

### 高温贮存

85°C, 1000小时贮存后,加额定工作电压处理30分钟, 经恢复24小时后性能符合:  
 容量变化率 初期值的±20%以内  
 损失角正切值 额定规格值的200%以下  
 漏电流 额定规格值以下

### 执行标准

JIS C 5101-4

### 外形图

单位 : mm

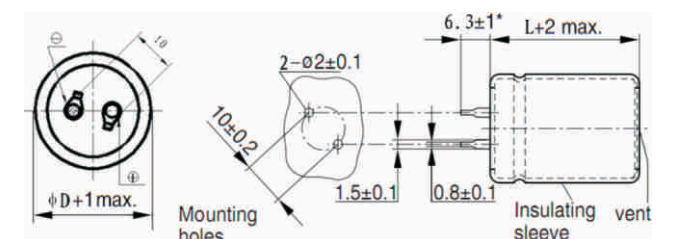

\*:短焊针为4.0±0.5mm

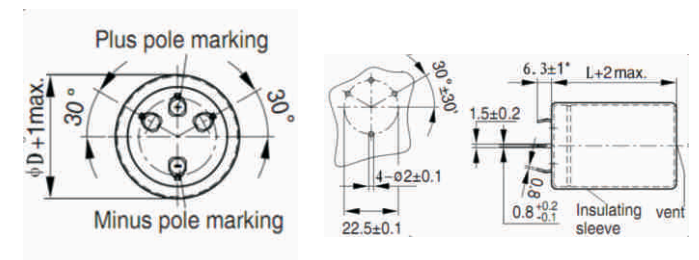

### 纹波电流修正系数

温度(°C)	40	55	70	85
UR(V)				
<160	2.1	1.8	1.5	1.0
≥160	1.7	1.5	1.3	1.0

### 纹波电流修正系数

频率(Hz)	50(60)	120	1K	10K	100K
U <sub>R</sub> (V)					
≤50	0.90	1.00	1.10	1.15	1.15
63-100	0.90	1.00	1.16	1.30	1.33
≥160	0.90	1.00	1.20	1.50	1.55

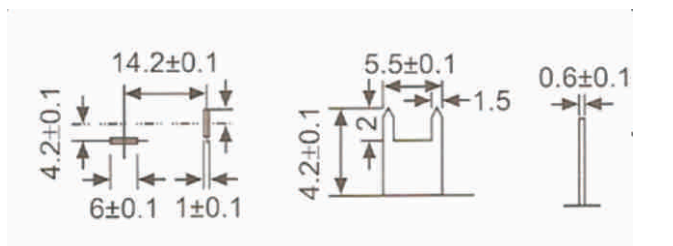
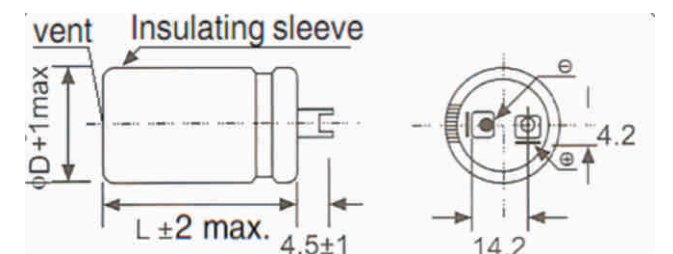

# UHP 型 新品

( 105°C 2000小时寿命保证 )

## 焊针型铝电解电容器

- 符合RoHS要求。
- 105°C 2000小时耐高温, 大纹波电流系列。
- 一般工业使用。

### 产品规格表

项目	特性
使用温度范围	-40°C ~ +105°C, -25°C ~ +105°C
额定电压	16V ~ 100V, 160V ~ 500V
静电容量允许偏差	39-47000±20% (20°C, 120Hz)
漏电流	≤0.01CV(μA)或1.5mA 取小值 (20°C, 5分钟) C=公称静电容量(μF), V=额定电压(V)

损失角正切 (20°C, 120Hz)							
U <sub>R</sub> (V)	16	25	35	50	63~100	160~400	450~500
tanδ	0.50	0.40	0.35	0.30	0.20	0.15	0.20

温度特性			
U <sub>R</sub> (V)	16 ~ 100	160 ~ 200	250 ~ 500
Z(-25°C)/Z(+20°C)	4	4	4
Z(-40°C)/Z(+20°C)	15		

耐久性	
105°C施加带额定纹波电流的额定电压(不超过额定电压)2000小时后,经恢复24小时后性能符合:	
电容量变化率	初期值的±20%以内
损失角正切值	额定规格值的200%以下
漏电流	额定规格值以下

高温贮存	
105°C, 1000小时贮存后,加额定工作电压处理30分钟,经恢复24小时后性能符合:	
电容量变化率	初期值的±20%以内
损失角正切值	额定规格值的200%以下
漏电流	额定规格值以下

执行标准	JIS C 5101-4
------	--------------

纹波电流修正系数					
温度(°C)	40	55	70	85	105
系数	2.7	2.5	2.1	1.7	1.0

纹波电流修正系数						
频率(Hz)	50(60)	120	1K	10K	≥20K	
U <sub>R</sub> (V)	≤100	0.95	1.00	1.11	1.15	1.15
160-250	0.87	1.00	1.11	1.18	1.20	
≥350	0.80	1.00	1.14	1.14	1.20	



外形图 单位: mm

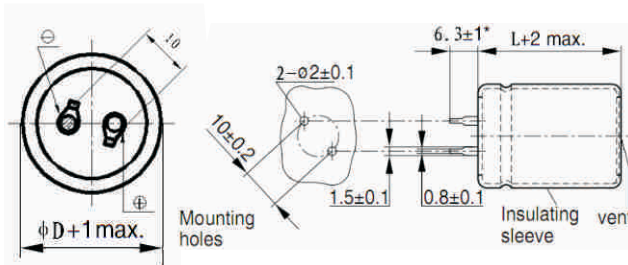

\*:短焊针为4.0±0.5mm

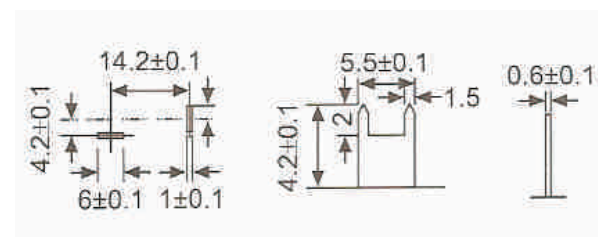
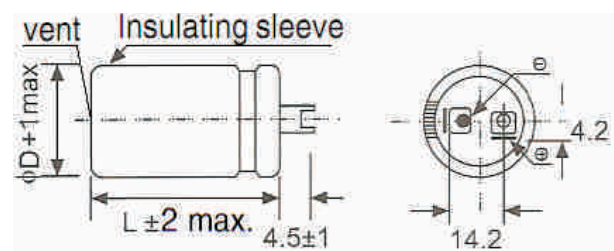
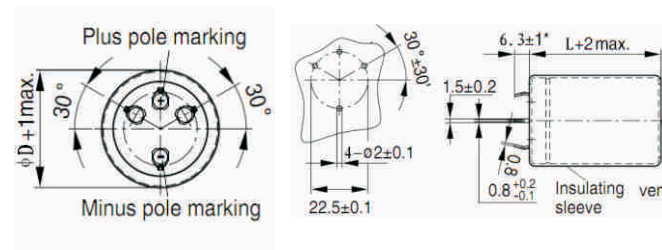

# UHQ 型 新品

( 105°C 5000小时寿命保证 )

## 焊针型铝电解电容器

- 符合RoHS要求。
- 105°C 5000小时耐大纹波电流系列。
- 可使用于专业电源, 变频器等领域。

### 产品规格表

项目	特性
使用温度范围	-40°C ~ +105°C, -25°C ~ +105°C
额定电压	16V ~ 100V, 160V ~ 450V
静电容量允许偏差	68-56000±20% (20°C, 120Hz)
容量偏差	±0.01CV(μA)或1.5mA 取小值 (20°C, 5分钟) C=公称静电容量(μF), V=额定电压(V)

损失角正切 (20°C, 120Hz)										
U <sub>R</sub> (V)	16	25	35	50	63	80	100	160~250	350~400	450
tanδ	0.50	0.45	0.40	0.35	0.30	0.25	0.20	0.15	0.20	0.25

温度特性 (Impedance ratio at 120Hz)			
U <sub>R</sub> (V)	16 ~ 100	160 ~ 200	250 ~ 500
Z(-25°C)/Z(+20°C)	4	3	8
Z(-40°C)/Z(+20°C)	15		

耐久性	
105°C施加带额定纹波电流的额定电压(不超过额定电压)5000小时后,经恢复24小时后性能符合:	
电容量变化率	初期值的±20%以内
损失角正切值	额定规格值的200%以下
漏电流	额定规格值以下

高温贮存	
105°C, 1000小时贮存后,加额定工作电压处理30分钟,经恢复24小时后性能符合:	
电容量变化率	初期值的±20%以内
损失角正切值	额定规格值的200%以下
漏电流	额定规格值以下

执行标准	JIS C 5101-4
------	--------------

纹波电流修正系数					
温度(°C)	40	55	70	85	105
系数	2.7	2.5	2.1	1.7	1.0

纹波电流修正系数						
频率(Hz)	50(60)	120	500	1K	≥10K	
U <sub>R</sub> (V)	16-100	0.90	1.00	1.05	1.10	1.15
160-250	0.80	1.00	1.20	1.30	1.50	
310-450	0.80	1.00	1.20	1.25	1.40	



外形图 单位: mm

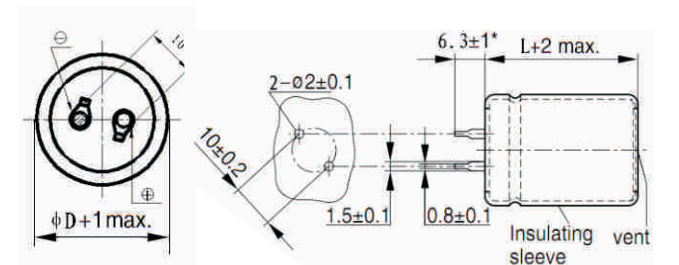

\*:短焊针为4.0±0.5mm

